

LEGEND

- Set rebar and plastic cap stamped L SMITH PLS 12751
- ⊕ Set rebar and plastic cap stamped REF-MONUMENT PLS 12751
- ⊕ Found rebar with plastic cap stamped BBE INC PLS 8625
- ⊕ Found rebar with plastic cap stamped OWENS PLS 2884
- Parcel line
- - - Chainlink fence
- R: Recorded in Plat Book C, Page 199

BASIS OF BEARING

The south line of Section 5, Township 7 South Range 61 East M.D.M., given in Plat Book C, Page 195 as S 88°56'06" E

SURVEYOR'S CERTIFICATE

I, Lenard D. Smith, a Professional Land Surveyor licensed in the State of Nevada, certify that:

- This plat represents the results of a survey conducted under my direct supervision at the instance of Douglas Miller for Alamo Power District #3
- The lands surveyed lie within Section 5, Township 7 South, Range 61 East, M.D.M. The survey was completed on January 10, 2007
- This plat complies with the applicable state statutes and any local ordinances in effect on the date that the governing body gave its final approval.
- The monuments depicted on the plat are of the character shown, occupy the positions indicated and are of sufficient number and durability

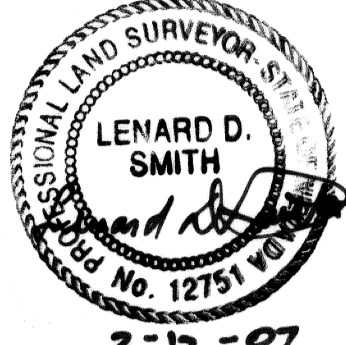

2-12-07
Lenard D. Smith P.L.S. 12751 Exp. June 30, 2008

PLANNING COMMISSION

At the regular meeting of the Lincoln County Planning Commission held this 26th day of February, 2007, this map was examined and having been designated to represent the Lincoln County Commission, hereby does approve this map for recordation.

Clint Watts
Chairman

MAP REFERENCE

- Record of Survey, Plat Book A, Page 195
- Record of Survey, Plat Book C, Page 50
- Parcel Map, Plat Book C, Page 199
- Deed Book 16, Page 627
- All in Lincoln County, Nevada Records

OWNER'S CERTIFICATE

At a regular meeting of the Board for Alamo Power District No. 3 we have examined this map and authorize the recordation thereof

Wendy Chairman
Wendy Power Dist. Clerk

LINE DATA

Id	Bearing	Distance
L1	N 00°04'27" E	19.77
L2	S 00°04'27" W	14.57
L3	N 00°19'49" W	16.79
L4	N 00°33'58" E	11.36
L5	N 30°08'59" E	2.97

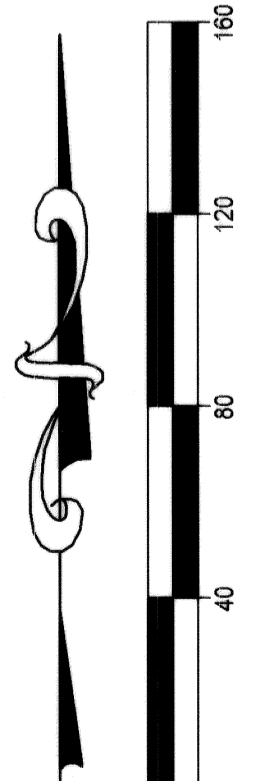

SCALE: 1" = 40'

Lenard Smith Survey
509 Main Street
P.O. Box 443
Caliente, Nevada 89008
Phone/Fax 775 726 3365
Cell Phone 775 962 1196

DOC # 0128441
02/26/2007 04:54 PM
Official Record
Recording requested by:
LENARD SMITH
Lincoln County - NV
Leslie Boucher - Recorder
Fee: \$21.00 Page 1 of 1
RPT: Recorded By: AE
Book - C Page - 0310
0128441

APN 004-011-13

PARCEL MAP
For Alamo Power District # 3
IN ALAMO, LINCOLN COUNTY, NEVADA, THE NE1/4SW1/4 SECTION 5 TOWNSHIP 7 SOUTH, RANGE 61 EAST MOUNT DIABLO MERIDIAN