

- LEGEND**
- Set rebar with plastic cap stamped "L SMITH PLS 12751"
 - Found rebar with plastic cap stamped "L SMITH PLS 12751"
 - Found rebar accepted as the parcel corner
 - Parcel lines
 - 12' Public utility easement per Plat Book C, Page
 - Road center line
 - Power line

N 00°00'00" E 000.00' Recorded in Plat Book B, Page 398

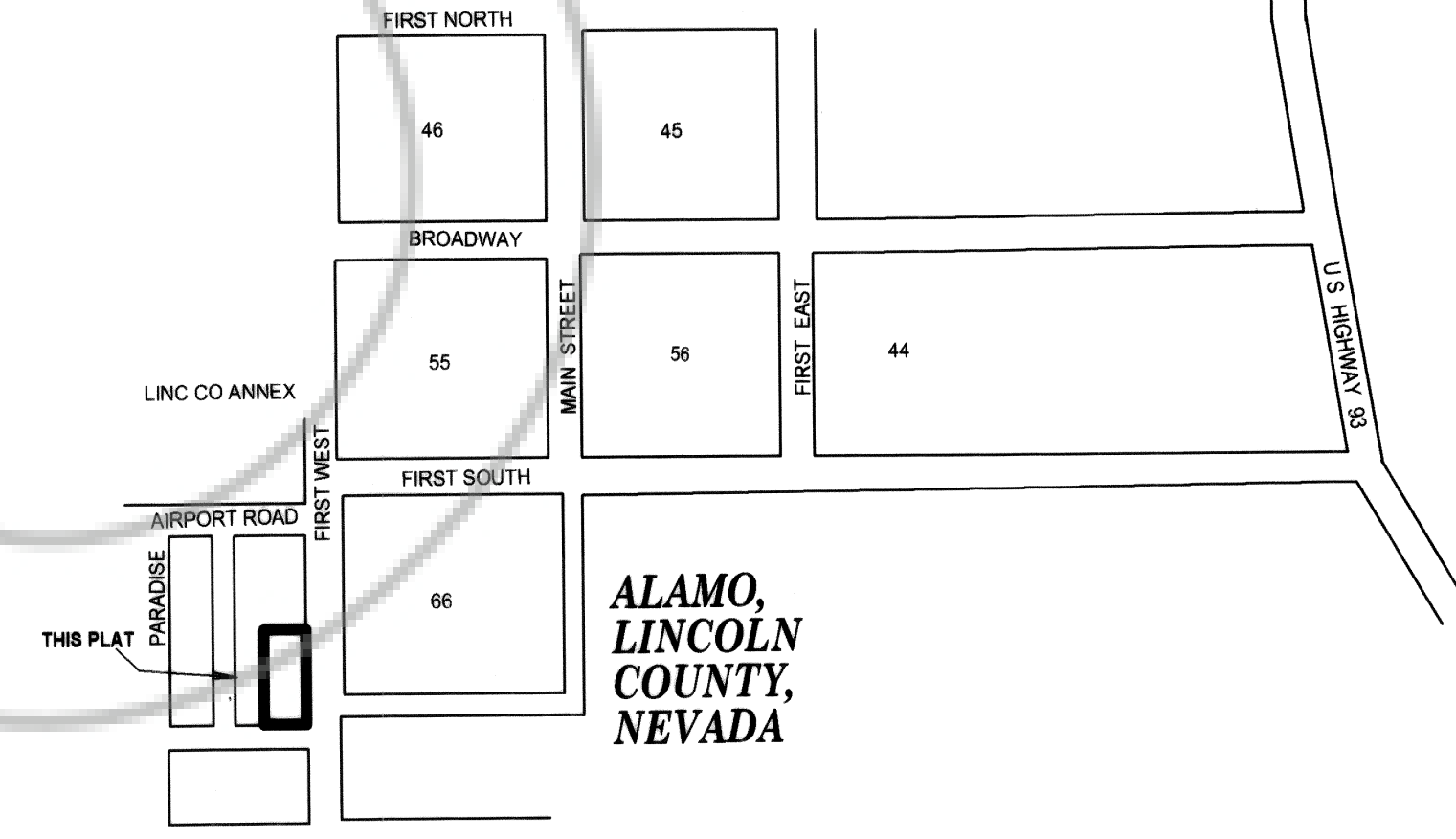
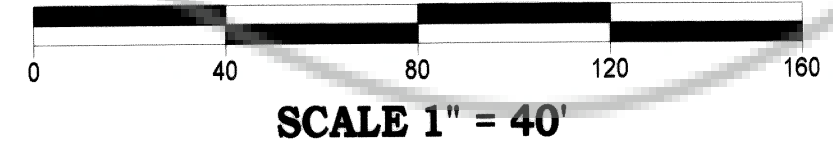

VICINITY MAP
NO SCALE

Lenard Smith
Land Survey
509 Main Street
P.O. Box 443
Caliente, Nevada 89008
Phone/Fax 775 726 3365
Cell Phone 775 962 1196

SURVEYOR'S CERTIFICATE

281

I, Lenard D. Smith, a Professional Land Surveyor licensed in the State of Nevada, certify that:

- This plat represents the results of a survey conducted under my direct supervision at the instance of Gerald H. Wilson
- The lands surveyed lie within Section 8, Township 7 South, Range 61 East, M.D.M. The survey was completed on
- This plat complies with the applicable state statutes and any local ordinances in effect on the date that the governing body gave its final approval.
- The monuments depicted on the plat are of the character shown, occupy the positions indicated and are of sufficient number and durability.

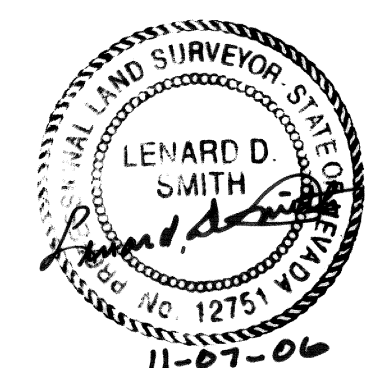

Lenard D. Smith P.L.S. 12751 Exp. June 30, 2008

OWNER'S CERTIFICATE

We certify that we are the owners of the properties shown on this plat

- That we have requested Lenard D. Smith, a Professional Land Surveyor to prepare it.
- That we authorize the recordation thereof.
- That we approve any easements as shown

Gerald H. Wilson Mary S. Wilson

ACKNOWLEDGEMENT

STATE OF NEVADA } ss
COUNTY OF LINCOLN } ss

This instrument was acknowledged before me on Nov. 7, 2006 by Gerald H. Wilson and Mary S. Wilson, freely and voluntarily for the purposes stated.

Cory B. Smith
Notary public
My commission expires Nov. 2, 2009



PLANNING COMMISSION

At the regular meeting of the Lincoln County Planning Commission held this 11 day of Dec., 2006, this map was examined and having been designated to represent the Lincoln County Commission, hereby does approve this map for recordation.

Vanessa J. Higer
Chairman attest

REFERENCES

Amended Parcel Map Plat Book B, Page 398
Parcel Map, Plat Book C, Page
Parcel Map, Plat Book C, Page
Lincoln County, Nevada Records

BASIS OF BEARING

The North line of Section 8, Township 7 South, Range 61 East, M.D.M. shown in Plat Book B, Page 398 as N 88°42'46" W

RECORDER'S CERTIFICATE

DOC # 128068
12/15/2006 01:34 PM
Official Record
RECORDING FURNISHED BY
LENARD SMITH
Lincoln County - NV
Recorder
Leslie Boucher
Fee \$21.00 Page 1 of 1
RPT1 Recorded By: LB
Book- C Page- 0281
128068

Subsequent Parcel Map

of Parcel 6, Plat Book C, Page
For Gerald H. and Mary S. Wilson

In Section 8, Township 7 South, Range 61 East,
M.D.M. In the Town of Alamo

C.B.S.