

MAP REFERENCES

Parcel map Plat Book A, Page 401, Lincoln County, Nevada
BLM Dependent resurvey dated October 1964

SURVEYOR'S CERTIFICATE

1. Lenard D. Smith, a Professional Land Surveyor licensed in the State of Nevada, certify that:
 1. This plat represents the results of a survey conducted under my direct supervision at the instance of Gordon Lytle.
 2. The lands surveyed lie within Sections 10 & 15, Township 1 North, Range 69 East M.D.M. The survey was completed on 2006.
 3. This plat complies with the applicable state statutes and any local ordinances in effect on the date that the governing body gave its final approval.
 4. The monuments depicted on the plat are of the character shown, occupy the positions indicated and are of sufficient number and durability.

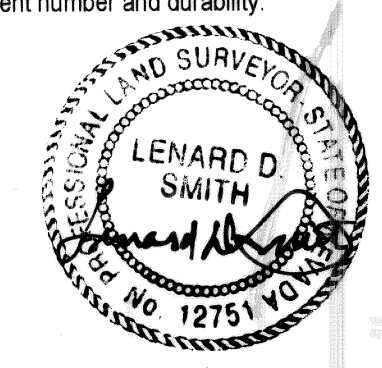

Lenard D. Smith P.L.S. 12751 Exp. 8/30/06

Curve Data

Id	Delta	Radius	Arc Length	Ch	Bear
C1	62°55'19"	149.97'	163.83'	121.18"	S 66°28'14" W
C2	27°46'23"	250.00'	121.18"	121.18"	S 21°17'23" W
C3	24°44'50"	700.00'	302.34'	302.34"	S 4°58'13" E
C4	25°29'44"	850.00'	378.11'	378.11"	S 4°30'02" E
C5	63°51'18"	52.00'	57.95'	57.95"	S 40°04'14" W
C6	83°37'14"	90.00'	131.35'	131.35"	S 30°11'16" W
C7	52°54'48"	90.00'	83.12'	83.12"	S 14°50'03" W
C8	28°50'53"	104.01'	52.57'	52.57"	S 31°10'3" W
C9	34°11'56"	82.49'	49.24'	49.24"	S 51°53'07" W
C10	44°33'39"	146.00'	113.55'	113.55"	S 47°58'54" W
C11	12°17'50"	538.44'	115.51'	115.51"	N 24°40'29" E
C12	50°44'28"	370.00'	327.67'	327.67"	S 45°51'38" W

OWNER'S CERTIFICATE

We certify that we are the owners of the properties shown on this plat
 1. That we have requested Lenard D. Smith, a Professional Land Surveyor to prepare it.
 2. That we authorize the recordation thereof.
 3. That we approve the easements as shown.

Gordon Lytle TRUSTEE
 Gordon and Betty Lytle Trust

ACKNOWLEDGEMENT

STATE OF NEVADA } ss
 COUNTY OF LINCOLN }
 This instrument was acknowledged before me on October 20, 2006 by
 Gordon Lytle, freely and voluntarily for the purposes stated.
Alison Hammond
 Notary public
 My commission expires Aug 26, 2007

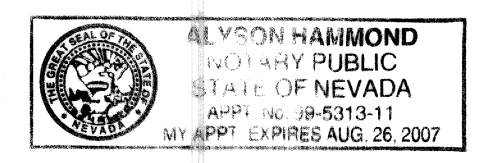

PLANNING COMMISSION

At the regular meeting of the Lincoln County Planning Commission held this
7th day of OCTOBER, 2006, this map
 was examined and hereby is approved for recordation.

Alison Hammond
 Chairman

BASIS OF BEARING

The North line of the NE1/4, Section 15, Township 1 North, Range 69 East, M.D.M. given in BLM Dependent resurvey notes dated 1964 as N 87°25' W

RECORDER'S CERTIFICATE

File number: 127897
 Recorded at the request of Lenard D. Smith
 Filed in Plat Book C, Page 277
 This 20th day of Nov, 2006
 at 2:39 p.m.
 LESLIE BOUCHER, RECORDER
 By *Leslie Boucher*
 \$20

A.P.N. 006-271-15

Lenard Smith
Land Survey
 509 Main Street
 P.O. Box 443
 Caliente, Nevada 89008
 Phone/Fax 775 726 3385
 Cell Phone 775 962 1196

Parcel Map
 For Gordon & Betty Lytle Trust
 In Sections 10 & 15, Township 1 North,
 Range 69 East, Mount Diablo Meridian