

SURVEYOR'S CERTIFICATE

I, Lenard D. Smith, a Professional Land Surveyor licensed in the State of Nevada, certify that

- This plat represents the results of a survey conducted under my direct supervision at the instance of James S. Toreson for Toreson Industries, Inc.
- The lands surveyed lie within Section 30, Township 3 South, Range 55 East, M.D.M. The survey was completed on August 22, 2006.
- No monuments of this subdivision were found except for those governing section corners as shown. Monuments which are shown set are of the character shown, occupy the positions indicated and are of sufficient number and durability.

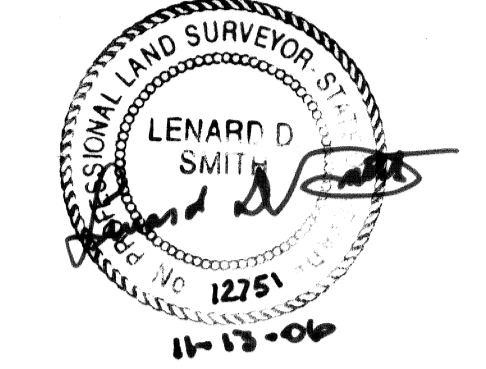

Lenard D. Smith P.L.S. 12751 Exp. June 30, 2008

REFERENCES

Lincoln Estates Unit No. 2 Subdivision, Plat Book A, Page 98
 Record of Survey, Plat Book C, Page 98
 Lincoln County, Nevada Records

BASIS OF BEARINGS

The North line of the NW1/4 Section 30, Township 3 South, Range 55 East shown in Plat Book A, Page 98 as S 88°50'51" E

MAP NOTE

Original record lot widths are maintained herein with the exception of the end lots in which the difference of our measurement is assigned, following the assumed intent of the original plat. Lot lengths have been proportioned to the difference in section measurements, which governed the original block lengths.

Found rebar with aluminum cap stamped L SMITH PLS 12751

24 19

25 30

50'

Gunderson Road
 S 00°22'17" W 278.56'
 N 00°21'24" E 278.63'

S 00°22'17" W 280.91'
 N 00°21'24" E 280.91'

S 00°22'17" W 2842.60'
 N 00°21'24" E 2642.67'

Range 54 East
 Range 55 East

25 30
 S 88°46'12" E 5428.99'
 N 88°46'19" W 5429.13'

Found rebar with aluminum cap stamped L SMITH

30 29

BASIS OF BEARING

S 88°50'51" E 2809.51' 2809.91'

N 88°50'51" W 188.76'

S 88°50'51" E 189.14'

S 88°50'51" E 504.00'

S 88°50'51" E 504.00'

N 88°50'51" W 168.00'

N 88°50'51" W 168.00'

N 88°50'51" W 168.00'

N 88°50'51" W 168.00'

N 88°50'51" W 168.00'

N 88°50'51" W 168.00'

N 88°50'51" W 168.00'

N 88°50'51" W 168.00'

N 88°50'51" W 168.00'

N 88°50'51" W 168.00'

N 88°50'51" W 168.00'

N 88°50'51" W 168.00'

N 88°50'51" W 168.00'

N 88°50'51" W 168.00'

N 88°50'51" W 168.00'

N 88°50'51" W 168.00'

N 88°50'51" W 168.00'

N 88°50'51" W 168.00'

N 88°50'51" W 168.00'

N 88°50'51" W 168.00'

N 88°50'51" W 168.00'

N 88°50'51" W 168.00'

N 88°50'51" W 168.00'

N 88°50'51" W 168.00'

N 88°50'51" W 168.00'

N 88°50'51" W 168.00'

N 88°50'51" W 168.00'

N 88°50'51" W 168.00'

N 88°50'51" W 168.00'

N 88°50'51" W 168.00'

N 88°50'51" W 168.00'

N 88°50'51" W 168.00'

N 88°50'51" W 168.00'

N 88°50'51" W 168.00'

N 88°50'51" W 168.00'

N 88°50'51" W 168.00'

N 88°50'51" W 168.00'

N 88°50'51" W 168.00'

N 88°50'51" W 168.00'

N 88°50'51" W 168.00'

N 88°50'51" W 168.00'

N 88°50'51" W 168.00'

N 88°50'51" W 168.00'

N 88°50'51" W 168.00'

N 88°50'51" W 168.00'

N 88°50'51" W 168.00'

N 88°50'51" W 168.00'

N 88°50'51" W 168.00'

N 88°50'51" W 168.00'

N 88°50'51" W 168.00'

N 88°50'51" W 168.00'

N 88°50'51" W 168.00'

19 Found Standard BLM Brass cap dated 1964

LEGEND

- Set rebar with plastic cap stamped L SMITH PLS 12751
- N 00°00'00" 00.00' Distance and bearing recorded in Plat Book A, Page 98
- Broken Tie
- 10' Utility Easement per Plat Book A, Page 98. 5' on each side of property line

Block VIII

Block VI

Holiday Lane

Parkdale Lane

Lot 32
64196 Sq. Ft.

Lot 31

Lot 30

Lot 29

Lot 28
51233 Sq. Ft.

Lot 27

Lot 26

Lot 16
63001 Sq. Ft.

Lot 15

Lot 14

Lot 13

Lot 12

Lot 11

Lot 10

cew
11-14-06

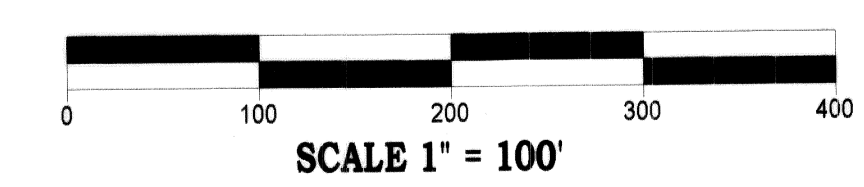

Lenard Smith Land Survey
 509 Main Street
 P.O. Box 443
 Caliente, Nevada 89008
 Phone/Fax 775 726 3365
 Cell Phone 775 962 1196

RECORDER'S CERTIFICATE

File number 127856
 Recorded at the request of Lenard D. Smith
 Filed in Plat Book C, Page 270
 This 14th day of Nov 2006
 at 4:16 p.m.
 LESLIE BOUCHER, RECORDER
 By Leslie Boucher
 #21

APN 010-111-08

RECORD OF SURVEY

Block 11, Lots 16, 28, & 32 in Lincoln Estates
 Unit No. 2, In Section 30, Township 3 South,
 Range 55 East M.D.M.

For Toreson Industries, Inc.