

SURVEYOR'S CERTIFICATE

I, Lenard D. Smith, a Professional Land Surveyor licensed in the State of Nevada, certify that
 1. This plat represents the results of a survey conducted under my direct supervision at the instance of Gerald H. Wilson
 2. The lands surveyed lie within Section 8, Township 7 South, Range 61 East, M.D.M. The survey was completed on Nov. 14, 2006
 3. This plat complies with the applicable state statutes and any local ordinances in effect on the date that the governing body gave its final approval.
 4. The monuments depicted on the plat are of the character shown, occupy the positions indicated and are of sufficient number and durability.

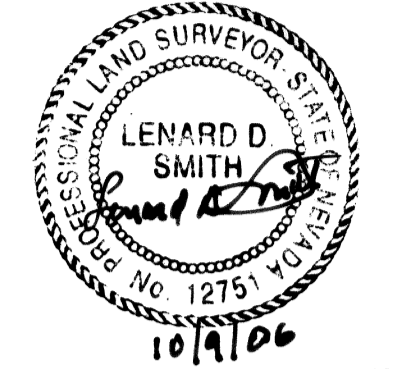

Lenard D. Smith P.L.S. 12751 Exp. June 30, 2008

OWNER'S CERTIFICATE

We certify that we are the owners of the properties shown on this plat
 1. That we have requested Lenard D. Smith, a Professional Land Surveyor to prepare it.
 2. That we authorize the recordation thereof.
 3. That we approve any easements as shown
 Gerald H. Wilson Mary S. Wilson
 Gerald H. Wilson Mary S. Wilson

ACKNOWLEDGEMENT

STATE OF NEVADA } ss
 COUNTY OF LINCOLN }
 This instrument was acknowledged before me on October 09, 2006 by Gerald H. Wilson and Mary S. Wilson, freely and voluntarily for the purposes stated.
 Cory B. Smith
 Notary public
 My commission expires Nov. 2, 2009

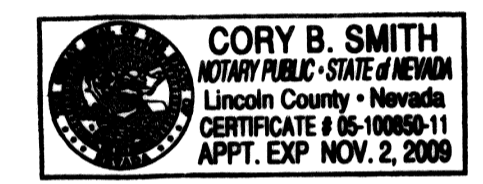

PLANNING COMMISSION

At the regular meeting of the Lincoln County Planning Commission held this 9th day of OCTOBER, 2006, this map was examined and having been designated to represent the Lincoln County Commission, hereby does approve this map for recordation.
 Chairman

REFERENCES

Amended Parcel Map Plat Book B, Page 398
 Parcel Map, Plat Book C, Page 264
 Lincoln County, Nevada Records

BASIS OF BEARING

The North line of Section 8, Township 7 South, Range 61 East, M.D.M. shown in Plat Book B, Page 398 as N 88°42'46" W

RECORDER'S CERTIFICATE

File number 127851
 Recorded at the request of Lenard D. Smith
 Filed in Plat Book C, Page 265
 This 14th day of Nov, 2006
 at 3:32 p.m.
 LESLIE BOUCHER, RECORDER
 By Leslie Boucher
 \$21.00

APN - 004 - 111 - 04

Subsequent Parcel Map
 of Parcel 3, Plat Book C, Page 264
 For Gerald H. and Mary S. Wilson
 In Section 8, Township 7 South, Range 61 East,
 M.D.M. In the Town of Alamo

Lenard Smith Land Survey
 509 Main Street
 P.O. Box 443
 Caliente, Nevada 89008
 Phone/Fax 775 726 3365
 Cell Phone 775 962 1196