

- LEGEND**
- Set rebar with plastic cap stamped L SMITH PLS 12751
 - Set rebar with plastic cap stamped RM L SMITH 12751
 - ⊕ Found rebar with plastic cap stamped L SMITH PLS 12751
 - ⊕ Found rebar with plastic cap stamped NEVADA PLS 6498
 - - - - - 42' Private roadway easement per Plat Book A, Page 468
 Note: Distance is scaled because no distance is given on original map
 - - - - - 30' Easement for ingress & egress per Plat Book B, Page 231
 - - - - - Easement per this map as described
 - - - - - Fence
 - - - - - Power line
 - - - - - Concrete ditch
 - - - - - Broken Tie

LINE DATA

ID	Bearing	Distance
L1	N 82° 08' 14" W	165.75
L2	S 81° 00' 46" W	15.82
L3	N 81° 00' 46" E	597.23
L4	S 80° 37' 22" E	135.54
L5	S 54° 41' 29" E	645.65
L6	S 30° 20' 12" E	221.15
L7	S 01° 16' 25" W	279.55
L8	N 81° 38' 31" E	337.96
L9	S 22° 50' 18" E	252.61
L10	S 52° 03' 47" E	238.32
L11	N 15° 12' 40" W	(35.54)
L12	N 66° 30' 56" E	12.15
L13	S 88° 50' 55" W	23.13
L14	N 89° 15' 28" W	112.41
L15	S 88° 59' 20" E	66.40

CURVE DATA

ID	Delta	Radius	Arc Length	Tangent
C1	82° 58' 24"	58.04'	81.15'	49.56'
C2	50° 57' 30"	36.06'	32.07'	17.18'
C3	29° 18' 37"	572.14'	292.69'	149.62'
C4	36° 51' 39"	170.45'	106.65'	56.80'

OWNER'S CERTIFICATE
 We certify that we are the owners of the properties shown on this plat
 2. That we approve any easements as shown
 3. That we authorize the recordation thereof.

Lamont C. Wadsworth
 Lamont C. Wadsworth

Annette Wadsworth
 Annette Wadsworth

ACKNOWLEDGEMENT
 STATE OF NEVADA } ss
 COUNTY OF LINCOLN }
 This instrument was acknowledged before me on August 23, 2006 by
 Lamont C & Annette Wadsworth, freely and voluntarily for the purposes stated.

Robin E. Simmers
 Notary public
 My commission expires Nov 6, 2006

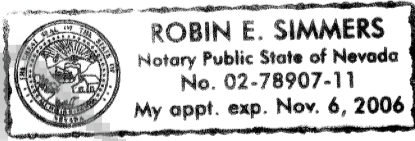

SURVEYOR'S CERTIFICATE

I, Lenard D. Smith, a Professional Land Surveyor licensed in the State of Nevada, certify that:
 1. This plat represents the results of a survey conducted under my direct supervision at the instance of Charles Wadsworth
 2. The lands surveyed lie within Section 19, Township 6 South, Range 61 East, M.D.M. The survey was completed on
 3. This plat complies with the applicable state statutes and any local ordinances in effect on the date that the governing body gave its final approval.
 4. The monuments depicted on the plat are of the character shown, occupy the positions indicated and are of sufficient number and durability.

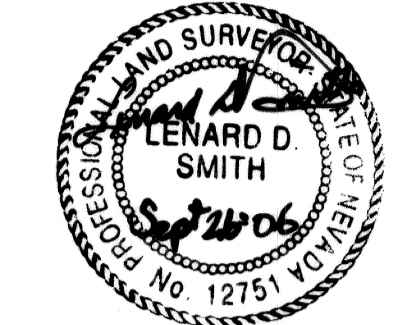

Lenard D. Smith P.L.S. 12751 Exp. June 30, 2008

OWNER'S CERTIFICATE

We certify that we are the owners of the properties shown on this plat
 1. That we have requested Lenard D. Smith, a Professional Land Surveyor to prepare it
 2. That we authorize the recordation thereof.
 3. That we approve any easements as shown

Charles E. Wadsworth Jr.
 Charles E. Wadsworth Jr.

Verla Wadsworth
 Verla Wadsworth

ACKNOWLEDGEMENT

STATE OF Nevada } ss
 COUNTY OF Lincoln }
 This instrument was acknowledged before me on August 23, 2006 by
 Charles E Wadsworth Jr. & Verla Wadsworth, freely and voluntarily for the purposes stated.

Robin E. Simmers
 Notary public
 My commission expires Nov 6, 2006

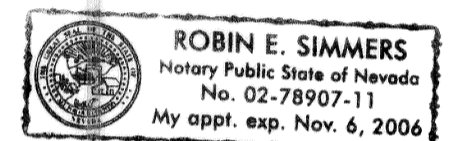

BASIS OF BEARINGS

The West line of the SW 1/4 Section 19, Township 6 South, Range 61 East M.D.M. given in Plat Book B, Page 231 as N 0° 26' 40" W

PLANNING COMMISSION

At the regular meeting of the Lincoln County Planning Commission held this 11 day of Sept, 2006, this map was examined and having been designated to represent the Lincoln County Commission, hereby does approve this map for recordation.

Charles E. Wadsworth Jr.
 Chairman

MAP REFERENCES

Parcel Map, Plat Book A, Page 468
 Record of Survey, Plat Book B, Page 231
 Subsequent Parcel Map, Plat Book C, Page 35A
 Deed Book 122, Page 468
 All in Lincoln County, Nevada Records

RECORDER'S CERTIFICATE

File number 127483
 Recorded at the request of Lenard D. Smith
 Filed in Plat Book C, Page 2516
 This 26 day of Sept, 2006
 at 2:51 pm.
 LESLIE BOUCHER, RECORDER
 By *Angie Elmer, Deputy*
 pd \$ 21.00

A.P.N. 011-160-15

Parcel Map
 For Charles E. Wadsworth Jr. and Verla Wadsworth
 In Section 19, Township 6 South, Range 61 East, M.D.M.

Lenard Smith Land Survey
 503 Main Street
 P.O. Box 443
 Caliente, Nevada 89008
 Phone/Fax 775 726 3365
 Cell Phone 775 962 1196