

# WC1 - WC10 CLAIM MAP

LINCOLN COUNTY, NEVADA  
T.2S, R.68E, SECTION 3  
M.D.B. & M.

T.1S R.68E 34 35  
T.2S 3 2

APPROXIMATE  
LOCATION OF  
SECTION CORNER

LOCATOR-OWNER:  
ALTAIR MINERALS, INC.  
1611 BRADLEY DRIVE  
EUGENE, OREGON 97401

ALL CORNERS AND LOCATION MONUMENTS  
ARE 2" X 2" WOODEN POSTS WITH METAL TAGS & FLAGGING.

APPROXIMATELY 1610 FT  
@ N22°5'E FROM THE  
NE CORNER OF WC10  
TO THE NE CORNER  
OF SECTION 3  
T2S, R68E

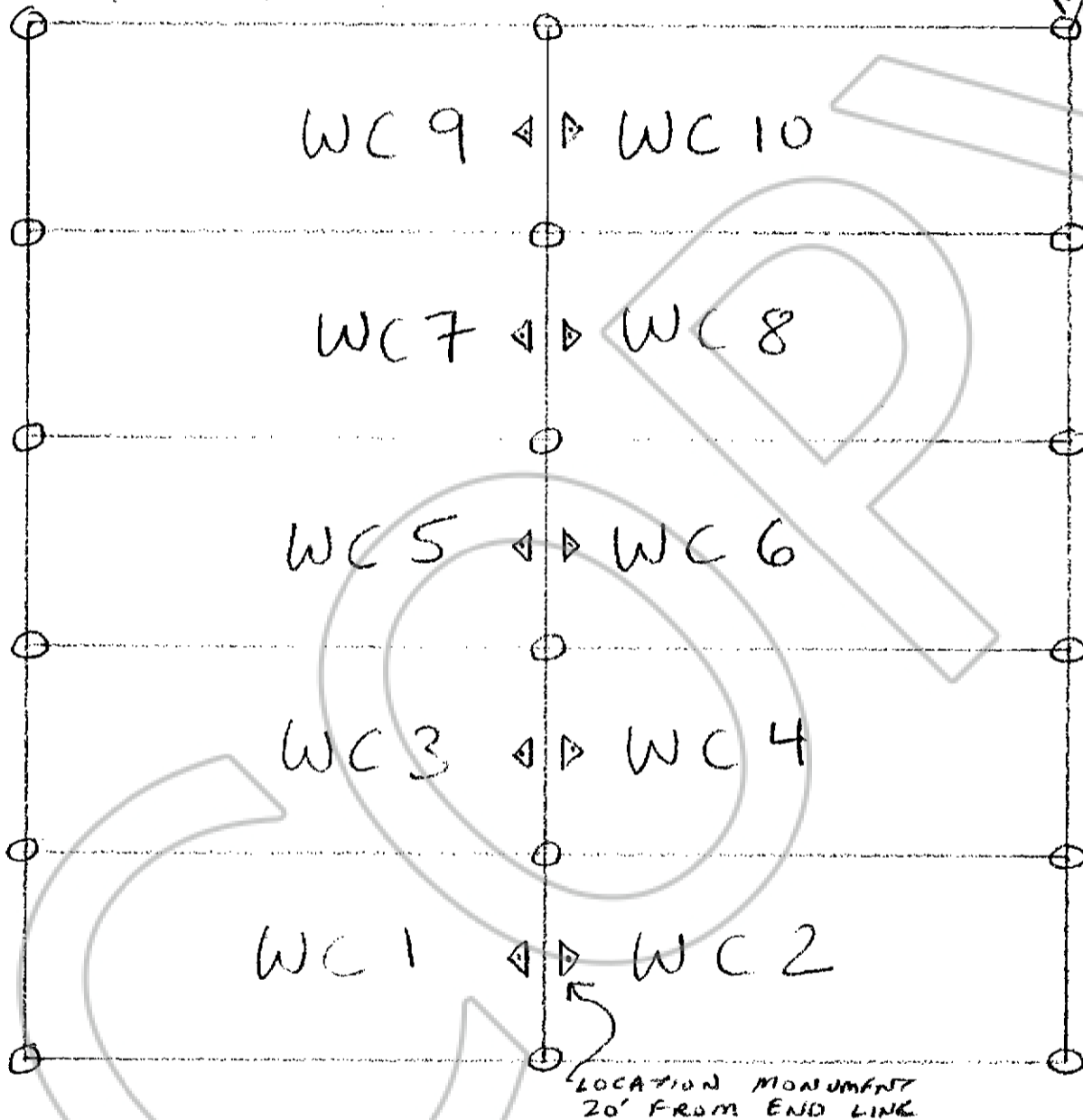

N

LOCATED ON: SEPTEMBER 1, 2006  
AFTER 12 NOON

127402

FILED FOR RECORDING  
AT THE REQUEST OF

Altair Minerals, Inc

2006 SEP 18 PM 12 10

LINCOLN COUNTY RECORDER  
FEE \$54.00  
LESLIE BOUCHER

