

SURVEYOR'S CERTIFICATE

I, Lenard D. Smith, a Professional Land Surveyor licensed in the State of Nevada, certify that:

1. This plat represents the results of a survey conducted under my direct supervision at the instance of Howard S. & Sherlyn Fackrell.
2. The lands surveyed lie within Section 9, Township 2 South, Range 68 East, M.D.M. The survey was completed on July 6, 2006.
3. This plat complies with the applicable state statutes and any local ordinances in effect on the date that the governing body gave its final approval.
4. The monuments depicted on the plat are of the character shown, occupy the positions indicated and are of sufficient number and durability.

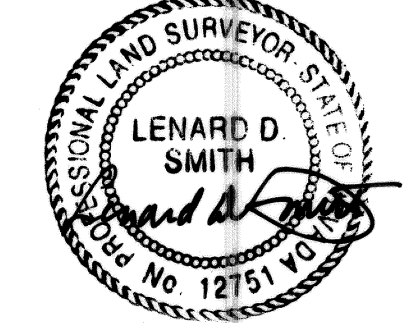

Lenard D. Smith, P.L.S. 12751 Exp. June 30, 2008

OWNER'S CERTIFICATE

We certify that we are the owners of the properties shown on this plat

1. That we have requested Lenard D. Smith, a Professional Land Surveyor to prepare it
2. That we authorize the recordation thereof.
3. That we approve all easements as shown

Howard S. Fackrell Howard S. Fackrell
Sherlyn Fackrell Sherlyn Fackrell

ACKNOWLEDGEMENT

STATE OF NEVADA)
COUNTY OF LINCOLN) ss

This instrument was acknowledged before me on August 15, 2006 by Howard S. Fackrell & Sherlyn Fackrell, freely and voluntarily for the purposes stated.

Benjamin S. Mangrum
Notary Public
My commission expires 01-08-2007

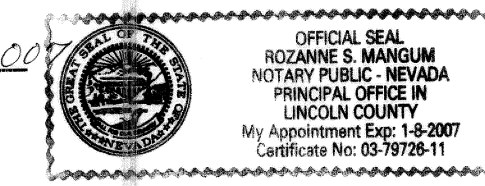

PLANNING COMMISSION

At the regular meeting of the Lincoln County Planning Commission held this 14th day of aug., 2006, this map was examined and having been designated to represent the Lincoln County Commission, hereby does approve this map for recordation.

Charles D. Wolfe
Chairman attest

BASIS OF BEARINGS

The South line of the SW1/4 SW1/4 Section 9, Township 2 South, Range 68 East, M.D.M. shown as N 89°54'53" E in Plat Book B, Page 209, Lincoln County Nevada Records

RECORDER'S CERTIFICATE

File number 127075
Recorded at the request of Lenard D. Smith
Filed in Plat Book C, Page 245
This 15 day of August 2006
at 3:21 p.m.
LESLIE BOUCHER, RECORDER
By Amy Elum, Deputy
rd. \$ 21.00

A.P.N. 002-250-05

Parcel Map Merger and Resubdivision
For Howard S. & Sherlyn Fackrell
In Panaca Townsite (The SE1/16SW1/6 Section 9, T. 2 S., R. 68 E., M.D.M.)

LEGEND

- Set #5 rebar with plastic cap stamped L SMITH PLS 12751
- Parcel line
- - - - - easement line
- Property line, Plat Book A, Page 267
- W- Existing water service line
- R Record measurements, Plat Bk B, Pg. 209

VICINITY MAP PANACA TOWNSITE (PART)

NO SCALE

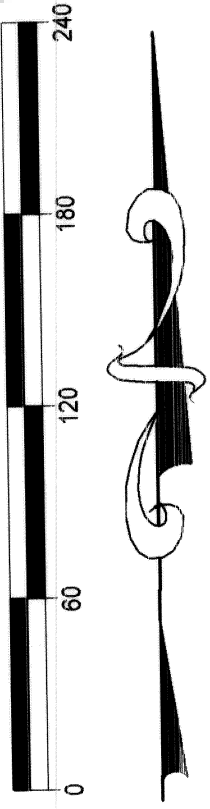

Scale: 1" = 60'

MAP REFERENCES

Record of Survey, Plat Book A, Page 267
Record of Survey, Plat Book B, Page 209
All in Lincoln County, Nevada Records



MAP NOTES

The original map of this property was made as a Record of Survey (Plat Book A, Page 267), then additional land was added via another Record of Survey (Plat Book B, Page 209) to correct the aliquot parts of Section nine, as determined by a Bureau of Land Management Dependent Resurvey. This map is developed to revert the property to one parcel as originally intended and then to divide Parcel 2 out of it.

No original monuments were found which located this property. Location here is determined from dimensions of original maps.

Also of note, the Dependent Resurvey by the Bureau of Land Management has not as yet been approved and therefore are subject to change.

BASIS OF BEARING

US Government (B.L.M.)
R = 27°08'20"
R = 200.00'
L = 94.73'
C = 93.85'
C Brg. = N 58°29'27" E

L = 89°11'00"
R = 120.08'
L = 144.97'
C = 136.32'
C Brg. = N 83°45'37" E

