

Marvin Thornburgh

SURVEYOR'S CERTIFICATE

216

- I, Lenard D. Smith, a Professional Land Surveyor licensed in the State of Nevada certify that:
1. This plat represents the results of a survey conducted under my direct supervision at the instance of Mark Vernon
 2. The lands surveyed lie within Section 2, Township 4 North, Range 67 East, M.D.M. The survey was completed on May 18, 2006
 3. The monuments depicted on the plat are of the character shown, occupy the positions indicated, and are of sufficient number and durability.

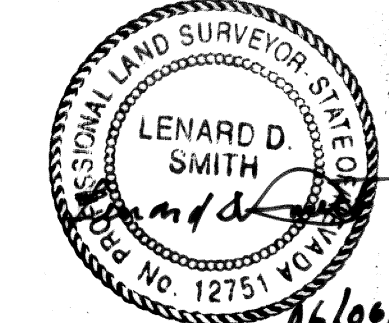

Lenard D. Smith PLS 12751, Exp. 6/30/08

References

Record of Survey Plat Book A, Page 312, Lincoln County, Nevada Records

Basis of Bearings

The North line of the South 1/2 Section 2, Township 4 North, Range 67 East M.D.M. recorded in Plat Book A, Page 312, Lincoln County Nevada records as N 89°53'07" W

SE1/4 Lot 7,
Section 2, T. 4 N., R. 67 E., M.D.M.
10.000 Acres

Susanne Wilkin Trust

LEGEND

- ⊕ Found Found, #4 rebar with plastic cap stamped OWENS PLS 2884 (Set several flagged lath on line, each course)
- Parcel line
- ⌋ Broken Tie
- R Recorded in Plat Book A, Page 312

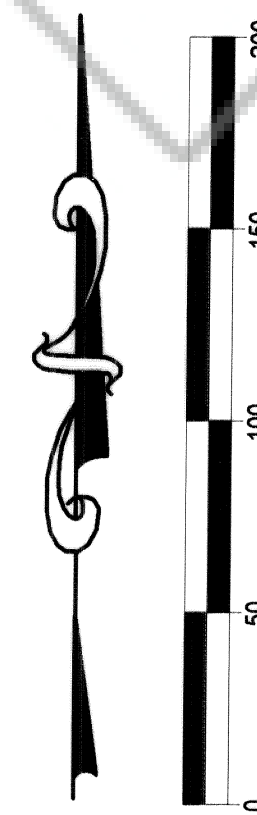

Scale 1"=50'

N 89°52'07" W 659.77'
R: N 89°53'09" W 659.58'

William & Melba Lynch Trust

BASIS OF BEARING
N 89°53'07" W 5276.80'
R: N 89°53'07" W 5277.13'

3
Found GLO Brass Cap

1
Found GLO Brass Cap

RECORDER'S CERTIFICATE

File No. 126623
Recorded at the request of
Lenard D. Smith
Filed Plat Book C, Page 216
Lincoln County, Nevada Records
Date June 6, 2006
at 2:40 p.m.
LESLIE BOUCHER, RECORDER
by Amey Evans, Deputy

A.P.N. 006-041-28 & 60

RECORD OF SURVEY

Assessor's Parcel Number 006-041-28 & 006-041-60
The SE 1/4, Lot 7, Section 2, Township 4 North,
Range 67 East, M.D.M.

For Mark Vernon

Lenard D. Smith
Land Survey
509 Main Street
P.O. Box 443
Caliente, Nevada 89008
Phone/Fax 775 726 3365
Cell Phone 775 962 1196