

David J & Jill Hansen

SURVEYOR'S CERTIFICATE

204

I, Lenard D. Smith, a Professional Land Surveyor licensed in the State of Nevada, certify that:

1. This plat represents the results of a survey conducted under my direct supervision at the instance of John and Sharon Marich
2. The lands surveyed lie within Section 5, Township 7 South, Range 61 East, M.D.M. The survey was completed on (date)
3. This plat complies with the applicable state statutes and any local ordinances in effect on the date that the governing body gave its final approval.
4. The monuments depicted on the plat are of the character shown, occupy the positions indicated and are of sufficient number and durability.

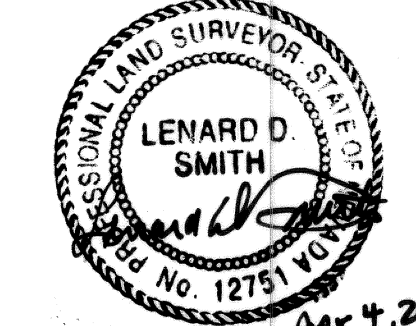

Lenard D. Smith P.L.S. 12751 Exp. 6/30/06
 Apr 4, 2006

OWNER'S CERTIFICATE

We certify that we are the owners of the properties shown on this plat

1. That we have requested Lenard D. Smith, a Professional Land Surveyor to prepare it.
2. That we authorize the recordation thereof.
3. That we approve the easement as shown

John Marich John Marich
Sharon Marich Sharon Marich
David Shumway David Shumway
Denise Shumway Denise Shumway

ACKNOWLEDGEMENT

State of Nevada)
 County of Lincoln)
 This instrument was acknowledged before me on April 14, 2006
 by John and Sharon Marich and executed freely and voluntarily for the purposes stated.

Robin E. Simmers
 Notary Public
 My Commission Expires Nov 6, 2006

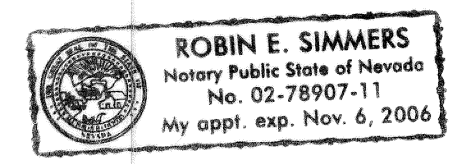

ACKNOWLEDGEMENT

State of Nevada)
 County of Lincoln)
 This instrument was acknowledged before me on April 14, 2006
 by David and Denise Shumway and executed freely and voluntarily for the purposes stated.

Robin E. Simmers
 Notary Public
 My Commission Expires Nov 6, 2006

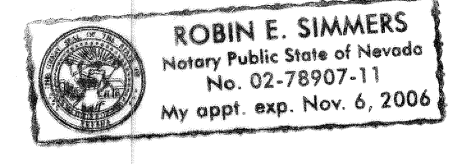

PLANNING COMMISSION

At the regular meeting of the Lincoln County Planning Commission held this
8th day of May, 2006, this map
 was examined and hereby is approved for recordation.

Warren S. Heigler
 Chairman

RECORDER'S CERTIFICATE

File number 126510
 Recorded at the request of Lenard D. Smith
 Filed in Plat Book C, Page 204
 This 12 day of May, 2006
 at 11:55 a.m.
 LESLIE BOUCHER, RECORDER
 By *Ami Jean Dopy*
 \$21.00

A.P.N. 004-151-15

Parcel Map

For
**Michael John Marich, Sharon Marich,
 David Shumway, and Denise Shumway**

In the S1/2NE1/4NW1/4SW1/4, Section 5,
 Township 7 South, Range 61 East, M.D.M



LEGEND

- Found original iron stake, no identification, set #5 rebar & cap stamped L SMITH PLS 12751 alongside.
- Set #5 rebar & plastic cap stamped L SMITH PLS 12751
- Parcel boundary line
- Street centerline
- Easement for ingress & egress
- R: Recorded in Plat Book A, Page 255, Lincoln County, Nevada Records

BASIS OF BEARINGS

The basis of bearings is the south line of Parcels 15-1 through 15-3 of the Parcel Map Plat Book A, Page 255 of Lincoln County Records, given as S 89°34'26" W.

MAP REFERENCES

Parcel Map, Plat Book A, Page 255, Lincoln County, Nevada Records
 Deed Book 165, Page 539, Lincoln County, Nevada Records
 Record of Survey, Plat Book A, Page 254, Lincoln County, Nevada Records

MAP NOTE

This property (and others in this vicinity) were originally laid out as aliquot parts of Section 5, however the stakes found were generally about a foot west of those positions. The owners state that the rebar called for on the map were never set, but the found iron stakes were accepted as property corners.

ALAMO, NEVADA VICINITY MAP

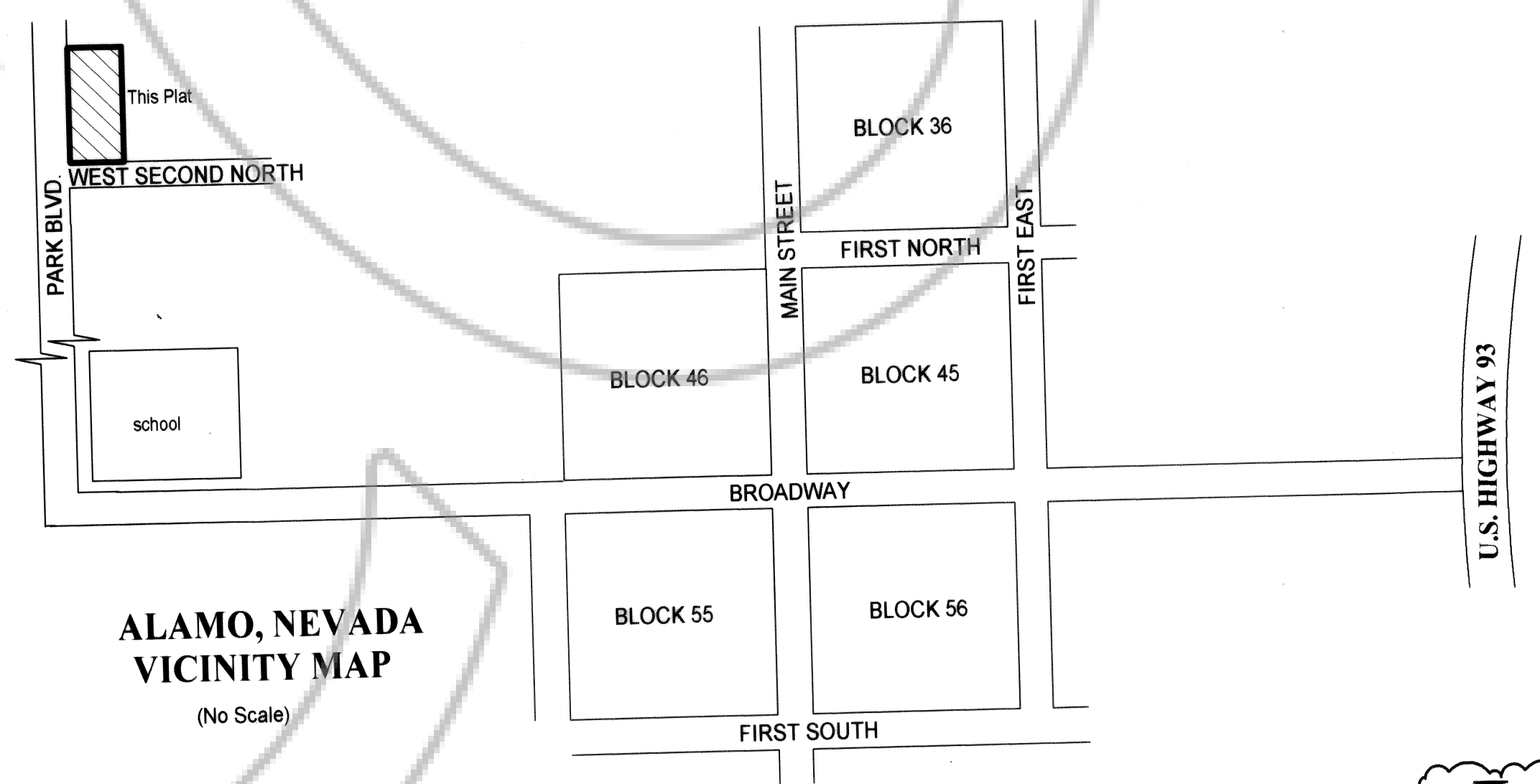

Found concrete monument with brass disk stamped RLS 3644
 6 5
 7 8