

SURVEYOR'S CERTIFICATE

I, SPENCER W. HAFEN, A PROFESSIONAL LAND SURVEYOR REGISTERED IN THE STATE OF NEVADA, DO HEREBY CERTIFY THAT:

1. THIS PLAT REPRESENTS THE RESULTS OF A SURVEY CONDUCTED BY ME, OR UNDER MY DIRECT SUPERVISION AT THE INSTANCE OF PHILLIP M. & LESLIE D. BOUCHER.
2. THE LANDS SURVEYED LIE WITHIN SEC. 15, T. 1 N., R. 67 E., M.D.M., TOWN OF PIOCHE, LINCOLN COUNTY, NEVADA, AND THE SURVEY WAS COMPLETED ON JAN. 19, 2006.
3. THIS PLAT COMPLIES WITH THE APPLICABLE STATE STATUTES AND ANY LOCAL ORDINANCES IN EFFECT ON THE DATE THAT THE GOVERNING BODY GAVE ITS FINAL APPROVAL.
4. THE MONUMENTS DEPICTED ON THIS PLAT ARE OF THE CHARACTER SHOWN, OCCUPY THE POSITIONS INDICATED AND ARE OF SUFFICIENT NUMBER AND DURABILITY.

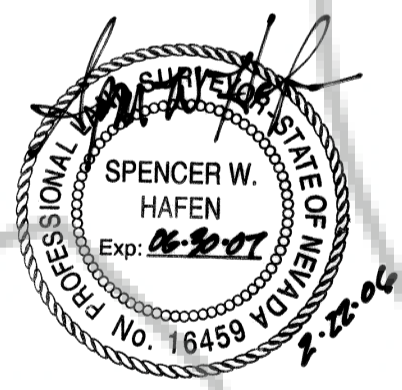

OWNER'S CERTIFICATE

WE, PHILLIP M. & LESLIE D. BOUCHER, DO HEREBY CERTIFY THAT BEING THE OWNERS OF THE LAND HEREON SHOWN, HAVE CAUSED THIS PROPERTY TO BE PLOTTED INTO PARCELS, AND EASEMENTS AS SHOWN AND, DO HEREBY DEDICATE ALL SHOWN PUBLIC UTILITY EASEMENTS TO THE PUBLIC UTILITY AGENCIES FOR THE CONSTRUCTION AND MAINTENANCE OF SURFACE AND SUBTERRANEAN UTILITIES, AND DO HEREBY CONSENT TO THE PREPARATION AND RECORDATION OF THIS PARCEL MAP.

Phillip M. Boucher 2/15/06 *Leslie D. Boucher* 2/15/06
 PHILLIP M. BOUCHER DATE LESLIE D. BOUCHER DATE

ACKNOWLEDGMENT

STATE OF NEVADA SS
 COUNTY OF LINCOLN

THIS INSTRUMENT WAS ACKNOWLEDGED BEFORE ME ON THIS 15 DAY OF February, 2006, BY PHILLIP M. BOUCHER & LESLIE D. BOUCHER.

Sharon Harrison
 MY COMMISSION EXPIRES ON THE 26 DAY OF August, 2007.

STATEMENT

ANY SUBSEQUENT CHANGES TO THIS MAP SHOULD BE EXAMINED AND MAY BE DETERMINED BY REFERENCE TO THE COUNTY RECORDER'S CUMULATIVE MAP INDEX, N.R.S. 278.5695.

LINCOLN COUNTY PLANNING COMMISSION APPROVAL

THIS IS TO CERTIFY THAT THE ZONING AND COMPREHENSIVE PLANNING, OF THE COUNTY OF LINCOLN, NEVADA ON THIS 13 DAY OF Feb., 2006, DID APPROVE FOR THE PURPOSE OF LAND DIVISION AND DO HEREBY ACCEPT IN BEHALF OF THE PUBLIC, THIS PLAT AND ANY PARCEL OF LAND OFFERED FOR DEDICATION FOR PUBLIC USE IN CONFORMITY WITH THE TERMS OF THE OFFER OF DEDICATION PER N.R.S. 278.010 THROUGH 278.630, INCLUSIVE.

Charles J. Hughes 02-13-06
 CHAIRMAN, LINCOLN COUNTY PLANNING COMMISSION DATE

TOWN OF PIOCHE APPROVAL

THIS MAP HAS BEEN REVIEWED AND APPROVED ON THIS _____ DAY OF _____, 2006, BY THE TOWN BOARD OF THE TOWN OF PIOCHE AS A PARCEL MAP.

Glenora Zelch 2-22-06
 CHAIRMAN, TOWN BOARD OF PIOCHE DATE

Norma Baylan 2-22-06
 ATTEST CLERK DATE

BASIS OF BEARING

THE BASIS OF BEARING IS N. 89°53'32" W., BEING THE BEARING BETWEEN A 2" BRASS CAP, PLS 3644, BEING THE SW COR. OF SEC. 15, T. 1 N., R. 67 E., AND A 2" BRASS CAP, PLS 3644, BEING THE S1/4 COR. OF SAID SEC. 15. SAID BEARING IS SHOWN ON PARCEL MAP BOOK PLAT A, PAGE 242, OF THE OFFICIAL RECORDS OF THE LINCOLN COUNTY RECORDER.

REFERENCE DOCUMENTS

1. PARCEL MAP BOOK PLAT A, PAGE 242, DATED 4/10/1985.
2. GRANT, BARGAIN AND SALE DEED BOOK 76, PAGE 11, DATED 6/30/1987.

LEGEND

- SET 5/8" REBAR W/ ALUM. CAP MARKED "S HAFEN PLS 16459".
- FOUND 1/2" REBAR W/ PLASTIC CAP MARKED "RLS 6498".
- FOUND 5/8" REBAR W/ NO I.D.
- (R) RECORD DATA FROM PM A-242 AS NOTED IN REFERENCE DOCUMENTS HEREON.
- (M) MEASURED DATA
- R/W RIGHT-OF-WAY
- I.E.&U.E. INGRESS, EGRESS & UTILITY EASEMENT

VICINITY MAP

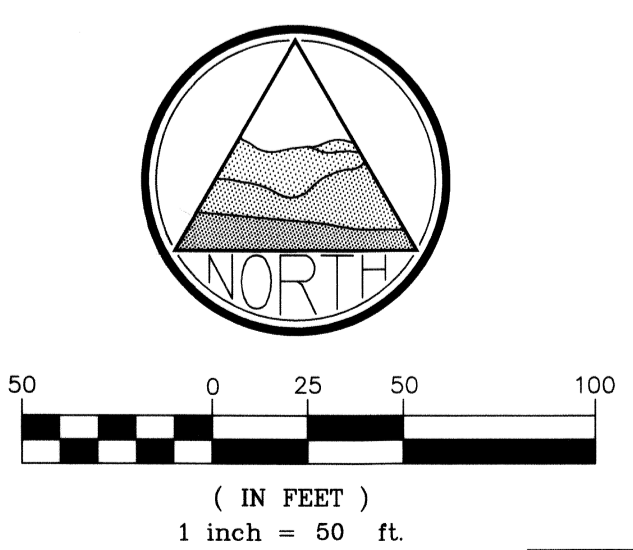
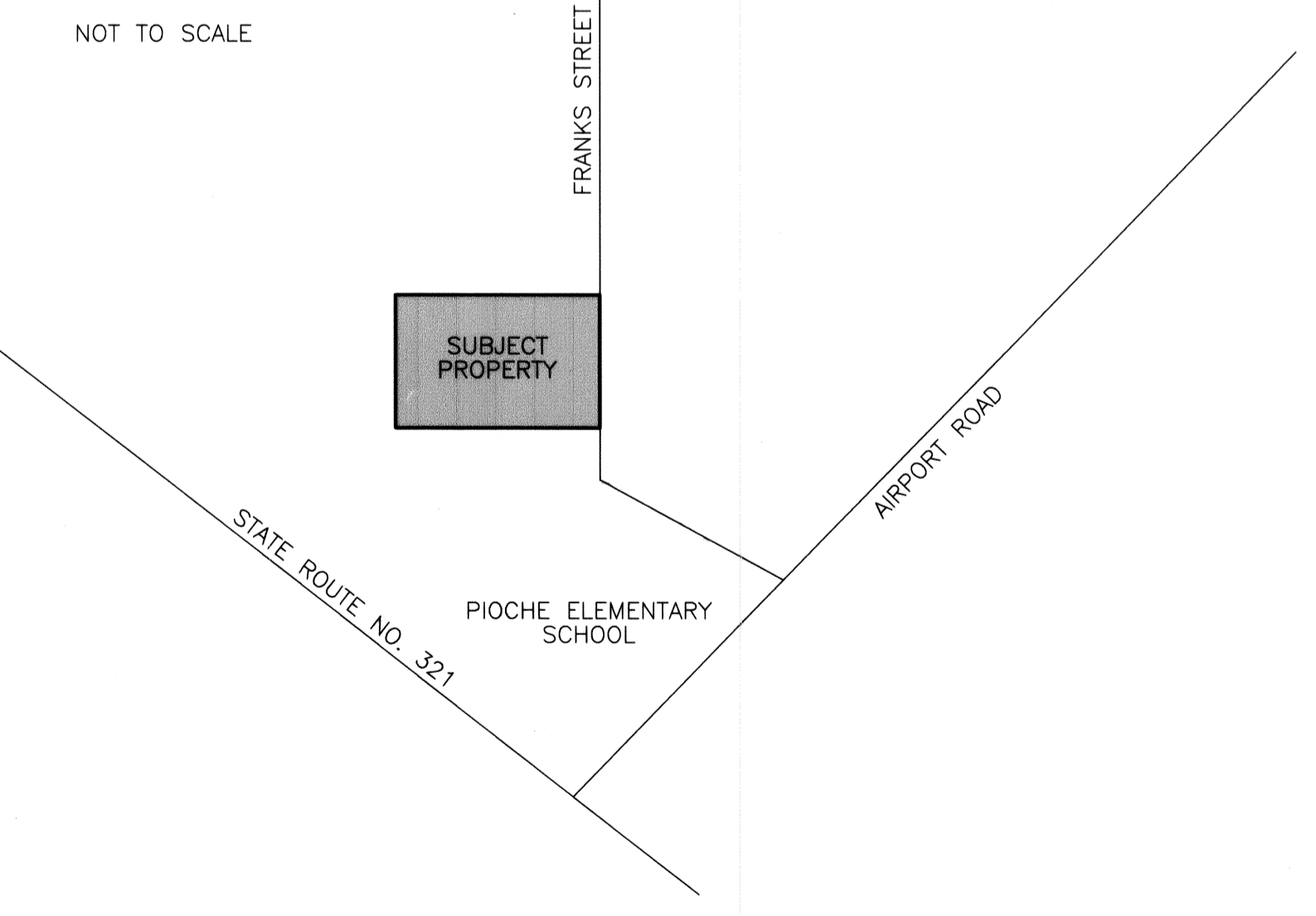

PARCEL MAP
 FOR
PHILLIP M. AND LESLIE D. BOUCHER
 A DIVISION OF PARCEL 6, PARCEL MAP BOOK PLAT A, PAGE 242,
 SITUATED WITHIN SEC. 15, T. 1 N., R. 67 E., M.D.M.,
 TOWN OF PIOCHE, LINCOLN COUNTY, NEVADA

HAFEN LAND SURVEYING, L.L.C.
 LAND, WATER & MINERAL SURVEYING
 P.O. BOX 255
 305 S. 3RD STREET
 PANACA, NV 89042
 775-728-4306

NO. **125984**
 FILED AT THE REQUEST OF:
 HAFEN LAND SURVEYING, L.L.C.
 DATE 2/22/2006 AT 11:41 am
 BOOK PLAT C PAGE 171
 LINCOLN COUNTY, NEVADA, RECORDS
 LESLIE BOUCHER, RECORDER
 FEE 21.00 DEPUTY Aut Lane