

FILED FOR RECORDING
AT THE REQUEST OF

Steven W. Klomp Dmd

MAP FILING FORM

Map of the STEKLO #1-7

Mining Claim Group, in Section 25, 36, Township 1 SOUTH

Range G7E, in the

PIOCHE

Mining District,

LINCOLN County, Nevada,

LINCOLN COUNTY RECORDER
FEE 1274.00 DEP
LESLIE DOUGHER

Located on the 27 day of AUGUST, 2005 by

Locator name and address (please print):

WAYNE & RACHEL KLOMP

PO Box 308

PANAMA, NV 89042

RECORDER'S STAMP

Describe here the position of the Claim Location Monument, if one is used

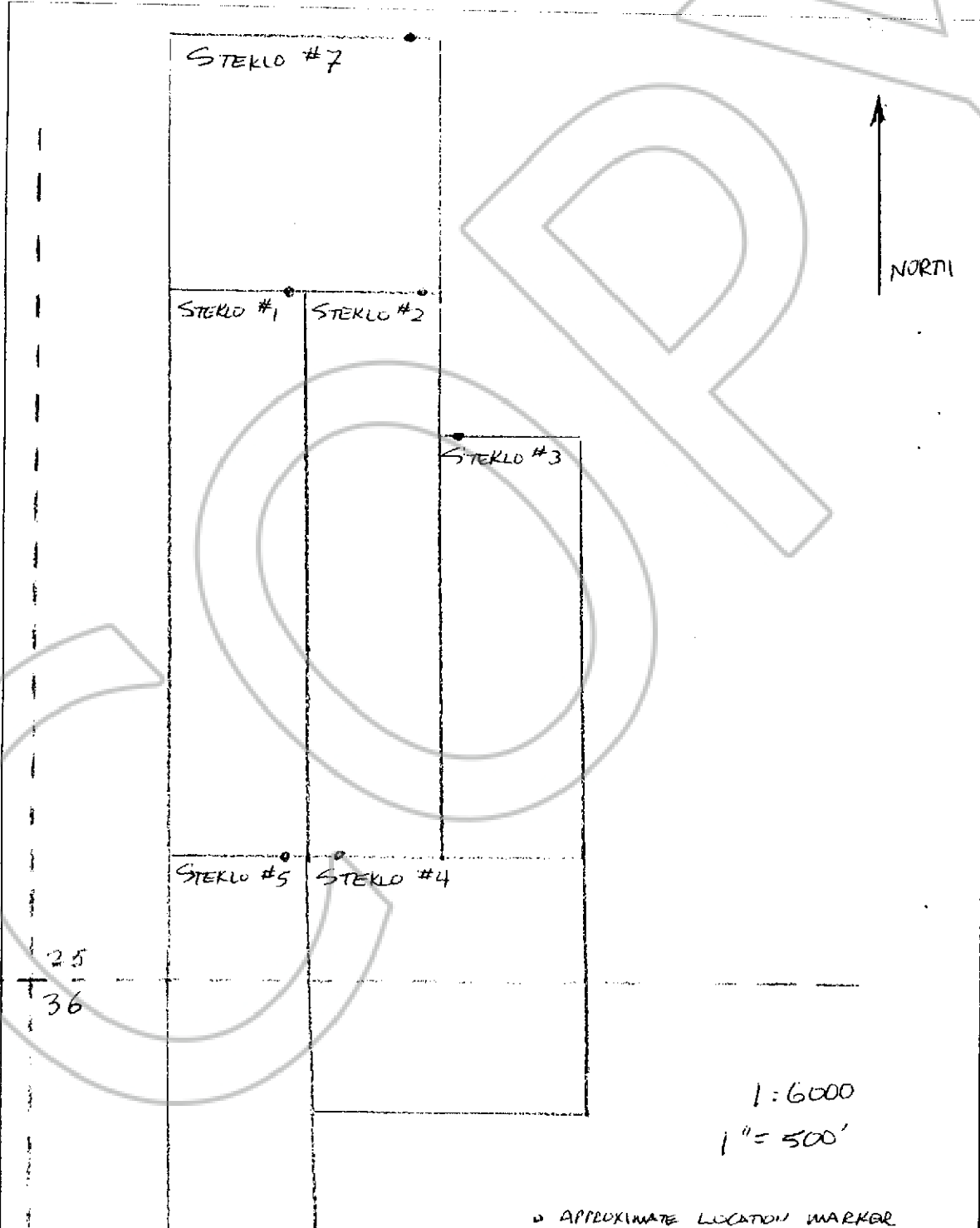

APPROXIMATE LOCATION MARKER

Suggested Form - Nevada Division of Minerals (REV. 6/29/2005 LV)
Map Filing Form - NRS 517.010