

124739

FILED FOR RECORDING
AT THE REQUEST OF

First American Title
2005 JUN 9 PM 3 46

Assessor's Parcel # 003-121-24

WHEN RECORDED MAIL TO:

FIRST AMERICAN TITLE CO.
2490 PASO VERDE PARKWAY
ENDERSON, NV 89074

LINCOLN COUNTY RECORDED
FEE \$500
LESLIE BOUCHER

AFFIDAVIT County of Lincoln
**CONVERSION OF MANUFACTURE HOME
FROM PERSONAL TO REAL PROPERTY**

PART I. TO BE COMPLETED BY APPLICANT

FOR RECORDER'S USE ONLY

1. Owner/Buyer Name GMAC MORTGAGE CORPORATION
2. Physical Location 269 KIYA PLACE, CALIENTE, NV 89008
3. Description: Year 1996 Manufacturer GOLDEN WEST Model GOLDEN WEST
Length 792"/792" Width 162"/162" Serial Number GMCA21L23776AB
4. New Lien holder (if any): N/A Address _____
5. Unsecured Property Taxes are paid in full through fiscal year 2004/05 Amount \$ N/A

LAND MUST BE OWNED BY THE OWNER OF THE MANUFACTURED/MOBILE HOME
Legal Description: Lot _____ Block _____ Subdivision _____

SEE LEGAL ATTACHED

**ALL DOCUMENTS RELATED TO THE HOME AS PERSONAL PROPERTY MUST BE FORWARDED TO
THE MANUFACTURED HOUSING DIVISION BEFORE IT CAN BE CONVERTED TO REAL PROPERTY.**

PART II. OWNER/BUYER NOTARIZED SIGNATURES

The undersigned, as owner(s)/buyer(s) of the above described manufactured home/mobile home and owner(s) of the land shown above, affirm that the running gear has been removed per NRS 361.244, the home has been installed in accordance with all state and local building codes and agree(s) to the conversion of the above described home to Real Property, understanding that any liens or encumbrances on the unit may become a lien on the land.

<u>X</u> _____ Owner/Buyer	_____ Date	_____	_____ Date
-------------------------------	------------	-------	------------

<u>GMAC MORTGAGE CORPORATION</u> Print or Type Name	_____	_____	_____
--------------------------------------------------------	-------	-------	-------

On May 2, 2005, before me the undersigned, a Notary Public in and for the State of Nevada, County of Clark, personally appeared Glenn Stevens and fairhead who acknowledged that he executed this affidavit.

[Signature]
Notary Public My Commission Expires 9/30/2009

PART III. The above described home will be placed on the next tax roll of Lincoln County as real property upon receipt of the Real Property Notice.

NOTICE: This conversion is valid only if the above information is true and correct:

<u>Melanie K McBride</u> Signature of County Assessor	<u>6/9/2005</u> Date	<u>Melanie K. McBride</u> Print Name/Title	<u>Deputy Assessor</u>
----------------------------------------------------------	-------------------------	-----------------------------------------------	------------------------

DISTRIBUTION: Send recorded affidavit, title, and any related documents with a check for \$50 to:
Manufactured Housing Division, 2501 E. Sahara Ave, #204, Las Vegas, NV 89104

EXHIBIT "A"
LEGAL DESCRIPTION

That portion of Section 7, Township 4 South, Range 67 East, M.D.B. & M., Lincoln County, Nevada, more particularly described as follows:

Parcel 7A of Parcel Map recorded December 2, 1994 in Book A of Plats, page 435 as File 102807 in the Recorder's Office, Lincoln County, Nevada.

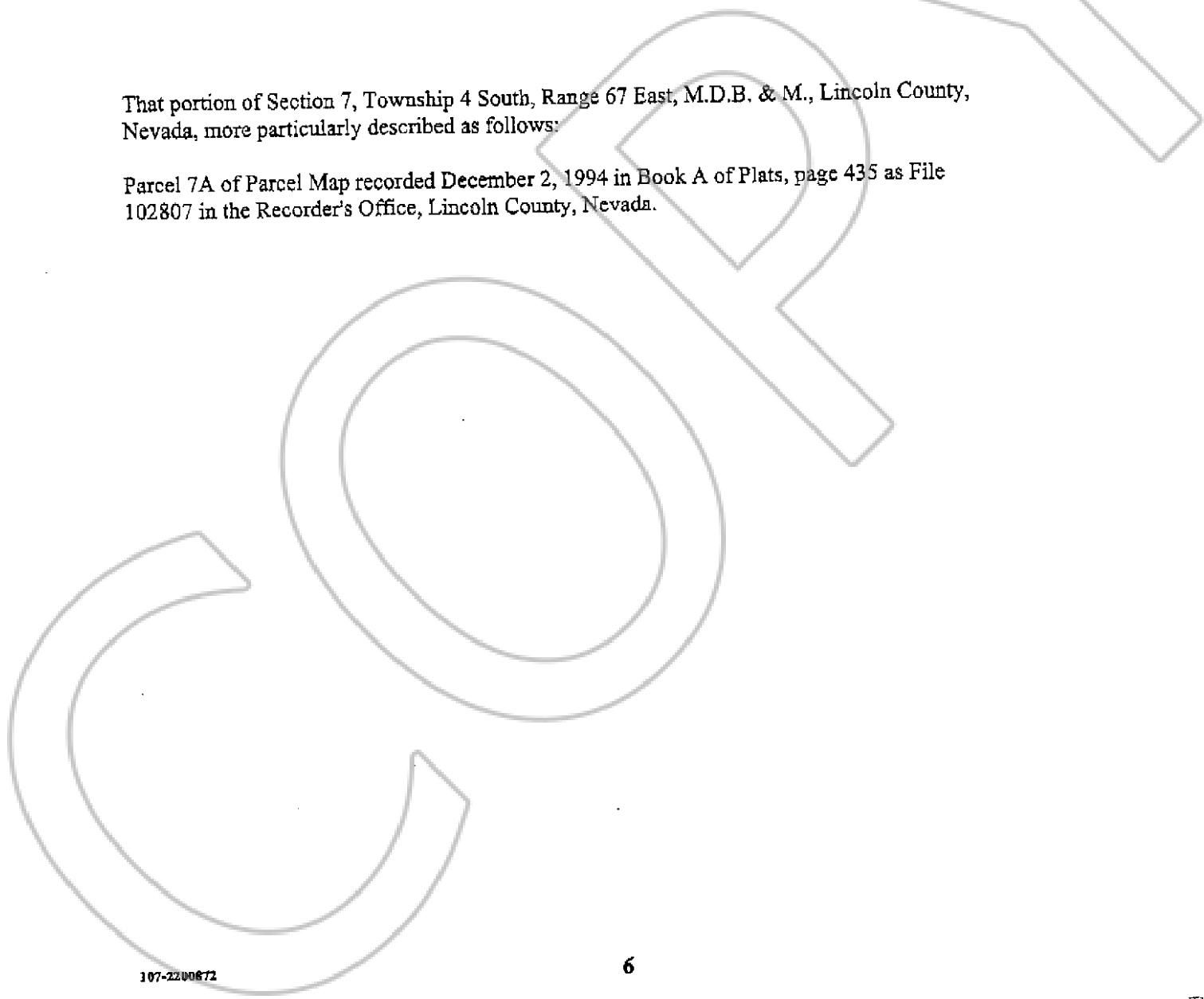

107-2200872