

SURVEYOR'S CERTIFICATE

I, Lenard D. Smith, a Professional Land Surveyor licensed in the State of Nevada, certify that:

1. This plat represents the results of a survey conducted under my direct supervision at the instance of Pioche Public Utilities.
2. The lands surveyed lie within the Town of Pioche, Lincoln County, Nevada in Section 22, T. 1 N., R. 67 E., M.D.M. The survey was completed on March 31, 2005.
3. The monuments depicted on the plat are of the character shown, occupy the positions indicated and are of sufficient number and durability.

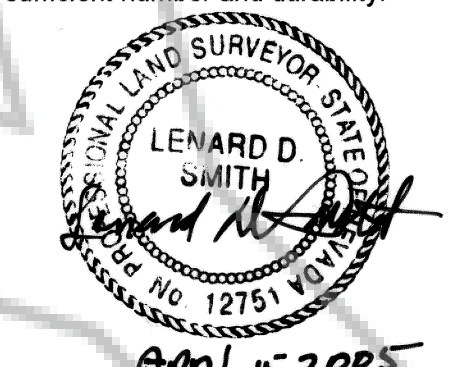

April 15, 2005
 Lenard D. Smith P.L.S. 12751 (expires June 30, 2006)

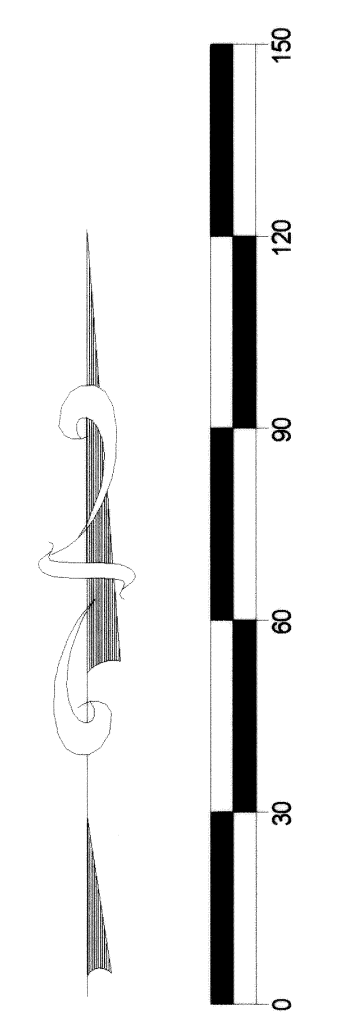

SCALE: 1" = 30'

RECORDER'S CERTIFICATE

File No. 124326

Recorded at the request of Lenard D. Smith

Filed in Plat Book C, Page 113

This 15th day of April, 2005

at 2:40 P.M.

LESLIE BOUCHER, LINCOLN COUNTY RECORDER

Leslie Boucher

By \$21.00

RECORD OF SURVEY

FOR PIOCHE PUBLIC UTILITIES

In Block 17, Townsite of Pioche,
 Lincoln County, Nevada

In Section 22, T. 1 N., R. 67 E., M.D.M.

Lenard D. Smith LAND SURVEY

509 main street
 P.O. Box 443
 Caliente, Nevada 89008
 Phone/Fax 775 726 3365