

Certificate of ~~Location~~ of Location (Lode Claim) 123978

STATE of Nevada)
) SS.
COUNTY of Lincoln)

FILED FOR RECORDING
AT THE REQUEST OF

David Jenkins

2005 MAR 4 PM 4 44

with the laws and regulations of the

LINCOLN COUNTY RECORDER

FEES \$50 DEPA

LESLIE BOUCHER

Notice is hereby given that the undersigned, has located a lode mining claim in accordance with the laws and regulations of the United States and the State of Utah.

Claim Name: Dino 150 Location Date: March 1, 2005

Location Description

Discovery monument is 2888 feet, at a bearing of 233° from the following natural / permanent monument: NE corner of section 31 T35, R71E

Point of beginning is the end-center line lying 1400 feet at a bearing of west from the location (discovery) monument, and running thence 300 feet at a bearing of north to corner monument No. 1, thence 1500 feet at a bearing of east to corner monument No. 2, thence 600 feet at a bearing of south to corner monument No. 3, thence 1500 feet at a bearing of west to corner monument No. 4, thence 300 feet at a bearing of north to the end-center line and point of beginning

Said claim occupies portions of the following quarter sections of the U.S. Government survey grid: NW 1/4 and NE 1/4 of section 31 T35, R71E

Locators (name and mailing address of each claimant):

Name: S & B Industrial Minerals
Address: North America Inc.
200 Berwyn Park
Suite 101
Berwyn Pa 10912
David Jenkins (agent)
David Jenkins

NE Corner section 31

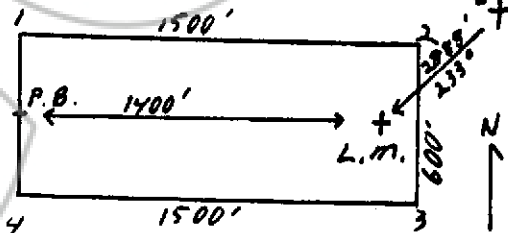

Dated this 4 day of March 2005

By David Jenkins

Owner, Claimant, Agent

Subscribed and sworn to before me this 4 day

of March 2005

Jenica M. Seewers

NOTARY PUBLIC

Recorder's Stamp

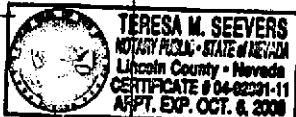

000 197 net 447