

Certificate of Location (Lode Claim)

123955

STATE of Nevada

FILED FOR RECORDING AT THE REQUEST OF

COUNTY of Lincoln

David Jenkins

Notice is hereby given that the undersigned, has located a lode mining claim in accordance with the laws and regulations of the United States and the State of Utah.

2005 MAR 4 PM 4:42 LINCOLN COUNTY RECORDER FEE \$20.00 LEBLIE DOUGLASS

Claim Name: Dina 127 Location Date: March 1, 2005

Location Description

Discovery monument is 2218 feet, at a bearing of 89 degrees from the following natural / permanent monument: SW corner of section 29 T35 R71E

Point of beginning is the end-center line lying 1400 feet at a bearing of west from the location (discovery) monument, and running thence 300 feet at a bearing of north to corner monument No. 1, thence 1500 feet at a bearing of east to corner monument No. 2, thence 600 feet at a bearing of south to corner monument No. 3, thence 1500 feet at a bearing of west to corner monument No. 4, thence 300 feet at a bearing of north to the end-center line and point of beginning

Said claim occupies portions of the following quarter sections of the U.S. Government survey grid: SW 1/4 of section 29 and NW 1/4 of section 32 T35, R71E

Locators (name and mailing address of each claimant):

Name: S + B Industrial Minerals Address: North America Inc. 200 Berwyn Park Suite 101 Berwyn Pa 10312 David Jenkins (agent) David Jenkins

SW corner section 29.

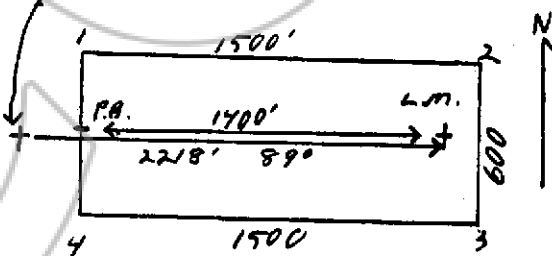

Dated this 4 day of March 2005

By David Jenkins

Owner, Claimant, Agent

Subscribed and sworn to before me this 4 day

of March 2005 Teresa M. Seevers

NOTARY PUBLIC

Recorder's Stamp



BOOK 127 PAGE 424