

Certificate of Location (Lode Claim) 123947

STATE of Nevada)

FILED FOR RECORDING
AT THE REQUEST OF

COUNTY of Lincoln)

David Jenkins

2005 MAR 4 PM 4 42

Notice is hereby given that the undersigned, has located a lode mining claim in accordance with the laws and regulations of the United States and the State of Utah.

LINCOLN COUNTY RECORDS
FEE 20.00
LESLIE BOUCHER

Claim Name: Dine 119 Location Date: March 1, 2005

Location Description

Discovery monument is 7409 feet, at a bearing of 201° from the following natural / permanent monument: NE corner of section 32 T35, R71E

Point of beginning is the end-center line lying 1400 feet at a bearing of west from the location (discovery) monument, and running thence 300 feet at a bearing of north to corner monument No. 1, thence 1500 feet at a bearing of east to corner monument No. 2, thence 600 feet at a bearing of south to corner monument No. 3, thence 1500 feet at a bearing of west to corner monument No. 4, thence 300 feet at a bearing of north to the end-center line and point of beginning

Said claim occupies portions of the following quarter sections of the U.S. Government survey grid: SE 1/4 and SW 1/4 of section 32 T35, R71E

NE corner section 32

Locators (name and mailing address of each claimant):

Name: S + B Industrial minerals
Address: North America Inc.
200 Berwyn Park
Suite 101
Berwyn Pa 10312
David Jenkins (agent)
David Jenkins

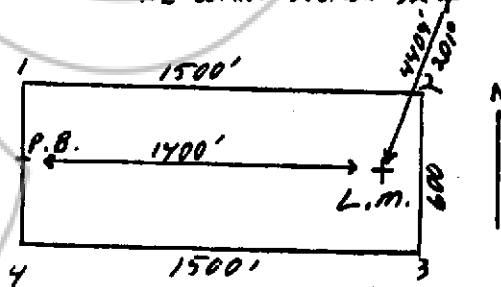

Witness this 4 day of March, 2005
By David Jenkins

Subscribed and sworn to before me this 4 day
of March, 2005
Teresa M. Seevers

NOTARY PUBLIC



Recorder's Stamp

BOOK 107 PAGE 416