

Certificate of Location (Lode Claim) 123946

STATE of Nevada )  
 ) SS.  
COUNTY of Lincoln )

FILED FOR RECORDING  
AT THE REQUEST OF  
David Jenkins  
2005 MAR 4 PM 4 42  
LINCOLN COUNTY RECORDER  
FEE \$50 DEPA  
LESLIE BOUCHER

Notice is hereby given that the undersigned, has located a lode mining claim in accordance with the laws and regulations of the United States and the State of Utah.

Claim Name: Dine 118 Location Date: March 1, 2005

Location Description

Discovery monument is 3918 feet, at a bearing of 204° from the following natural / permanent monument: NE corner of section 32 T35, R71E

Point of beginning is the end-center line lying 1400 feet at a bearing of west from the location (discovery) monument, and running thence 300 feet at a bearing of north to corner monument No. 1, thence 1500 feet at a bearing of east to corner monument No. 2, thence 600 feet at a bearing of south to corner monument No. 3, thence 1500 feet at a bearing of west to corner monument No. 4, thence 300 feet at a bearing of north to the end-center line and point of beginning

Said claim occupies portions of the following quarter sections of the U.S. Government survey grid: SW 1/4 and SE 1/4 of section 32 T35, R71E

Locators (name and mailing address of each claimant):

Name: S + B Industrial Minerals  
Address: North America Inc.  
200 Berwyn Park  
Suite 101  
Berwyn Pa 19312  
David Jenkins (agent)  
David Jenkins

NE corner section 32 +

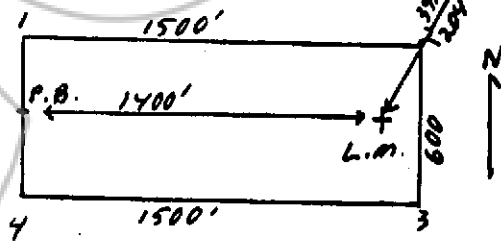

Dated this 4 day of March, 2005

By David Jenkins  
Corner, Claim Agent

Subscribed and sworn to before me this 4 day

of March 2005  
Teresa M. Seevers

NOTARY PUBLIC



Recorder's Stamp

BOOK 107 PAGE 415