

Certificate of Location (Lode Claim)

123944

STATE of Nevada

COUNTY of Lincoln

)  
) SS.  
)

FILED FOR RECORDING  
AT THE REQUEST OF

David Jenkins

Notice is hereby given that the undersigned, has located a lode mining claim in accordance with the laws and regulations of the United States and the State of Utah.

2005 MAR 4 PM 4 41  
LINCOLN COUNTY RECORDER  
FEE \$20.00 DEPT  
LESLIE BOUCHER

Claim Name: Dina 116 Location Date: March 1, 2005

Location Description

Discovery monument is 6867' feet, at a bearing of 213° from the following natural / permanent monument: NE corner of section 32 T35, R71E

Point of beginning is the end-center line lying 1400 feet at a bearing of west from the local (discovery) monument, and running thence 300 feet at a bearing of north to corner monument No. 1, thence 1500 feet at a bearing of east to corner monument No. 2, thence 600 feet at a bearing of south to corner monument No. 3, thence 1500 feet at a bearing of west to corner monument No. 4, thence 300 feet at a bearing of north to the end-center line and point of beginning.

Said claim occupies portions of the following quarter sections of the U.S. Government survey grid: NW 1/4 and NE 1/4 of section 32 T35, R71E

Locators (name and mailing address of each claimant):

Name: S + B Industrial Minerals  
Address: North America Inc.  
200 Berwyn Park  
Suite 101  
Berwyn Pa 19312  
David Jenkins (agent)  
David Jenkins

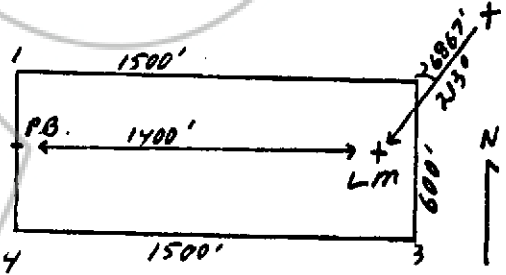

Dated this 4 day of March, 2005  
By David Jenkins

Subscribed and sworn to before me this 4 day  
of March, 2005  
Teresa Meevers

NOTARY PUBLIC

Recorder's Stamp



BOOK 107 PAGE 413