

Map of the Empy Mining Claim Group
 in Section 36 T 3 S, R 68 E MDBM
 Section 31 T 3S R69E
 Section 1 T4S R68E
 Section 6 T4S R69
 in the Unknown Mining District,
 Lincoln County, Nevada.
 Located on the 21th day of November, 2004

Locator name and address:

Landmark Minerals (US) Inc.
 P.O. Box 18127
 Reno, NV 89511

N65W 340 feet to
 Common Corner
 S36, T3S, R68E
 S31, T3S, R69E
 S1, T4S, R68E
 S6, T4S, R69E

Recorders Stamp

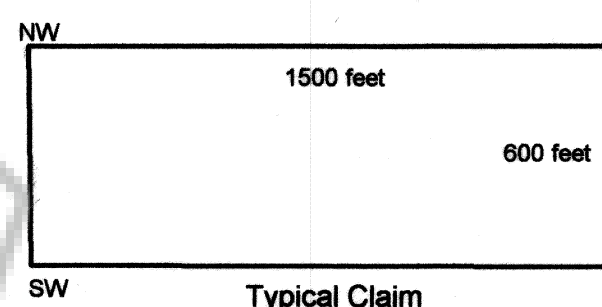
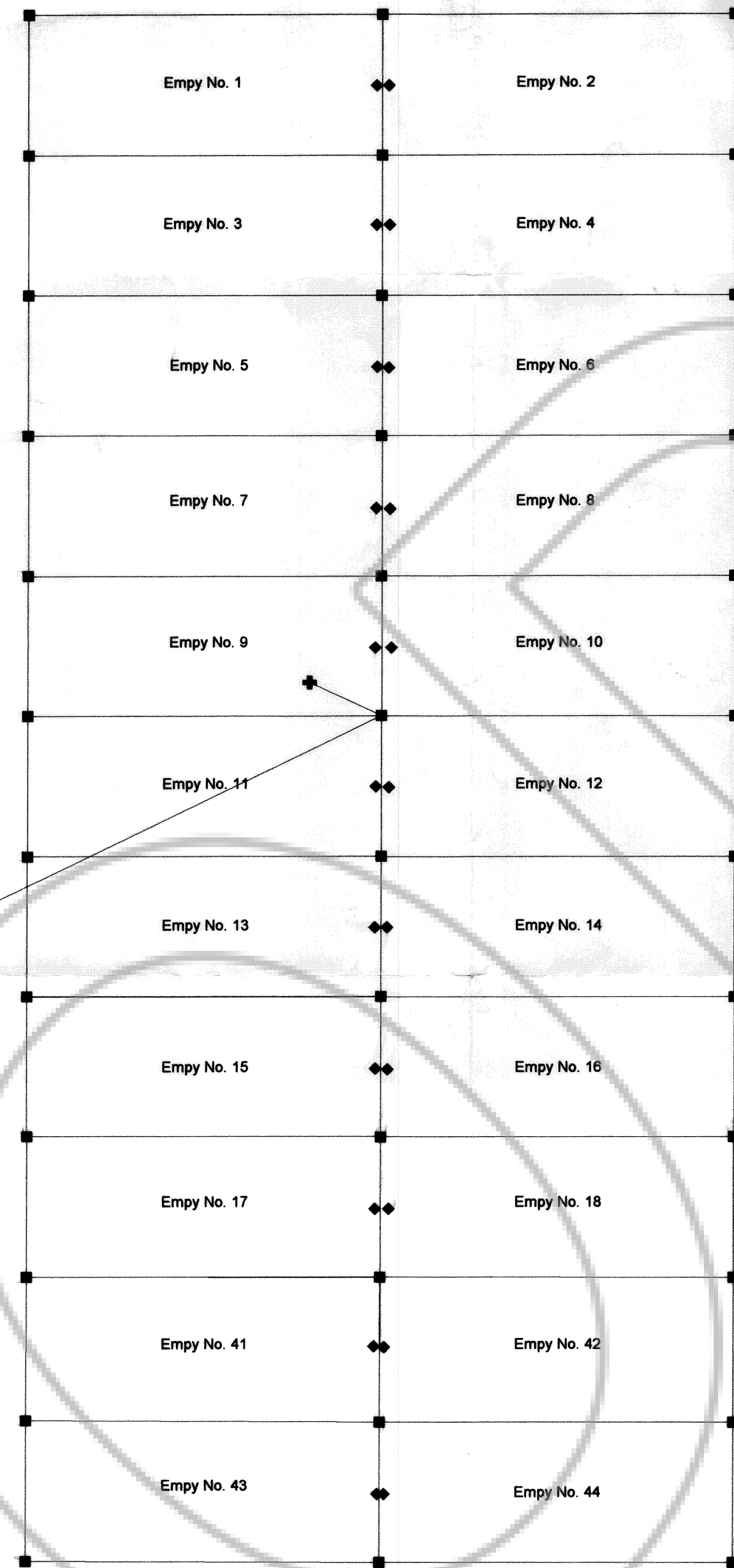

Typical Claim
 Corners marked by 1 1/2" by 1 1/2" inch X 4'
 Wooden Posts. Location Monument on center
 line about 10 feet from end of claim.
 ◆ Location Monuments
 ■ Corner Posts

123907

AND RECORDED AT REGISTRY
 Alan Morris
 Feb 15, 2005
 55 MINUTES PAST 2 O'CLOCK
 IN BOOK 197 OF OFFICIAL
 RECORDS, PAGE 21 LINCOLN
 COUNTY, NEVADA. Leslie Boucher
 Amy Elmer, Deputy

197-21