

SURVEYOR'S CERTIFICATE

I, Lenard D. Smith, a Professional Land surveyor registered in the State of Nevada, certify that:

1. This plat represents the results of a survey conducted under my supervision at the instance of John G. Barton, jr.
2. The land surveyed lies within Section 7, T. 4 S., R. 67 E., M.D.M. in the City of Caliente, in Lincoln County, Nevada. The survey was completed on December 10, 2005.
3. This plat complies with applicable statutes of this state and any local ordinances in effect on the date that the survey was completed, and the survey was conducted in accordance with Chapter 625 of the Nevada Administrative Code.
4. The monuments depicted on the plat are of the character shown, occupy the positions indicated, and are of sufficient durability.

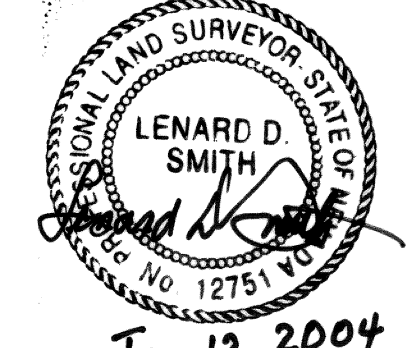

Lenard D. Smith PLS 12751 (Expires June 30, 2004)

BASIS OF BEARINGS

The Basis of Bearings is the centerline of Lincoln Street between the monuments set by R.E. Fonger, between the First Street and Second Street intersections, recorded Plat Book B, Page 59 of Lincoln County, Nevada Records. The bearing is N 45° 02' 40" E.

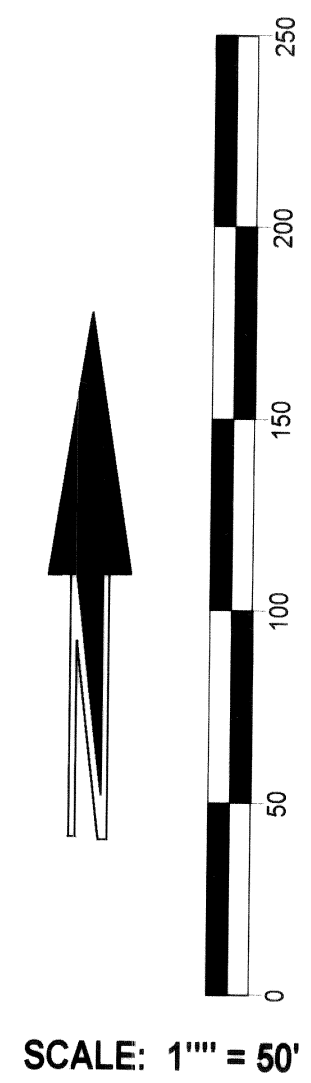

SCALE: 1" = 50'

Lincoln Street (Right of Way Street)

First Street

A Street

BLOCK C

BLOCK B

Lot 6
22,029 Sq. Ft.

MAP REFERENCE AND NOTES

The Westend Addition Plat of the City of Caliente, Lincoln County, Nevada recorded Plat Book A Page 44. A Record of Survey of Block B and C of this Westend Addition recorded Plat Book B, Page 59.

This plat is patterned after the above referenced Record of Survey Plat Book B, Page 59. It is noted that the original Plat of Plat Book A, Page 44 is lacking in detail and the lots from 5 through 17 do not add up to the distances on the ground. There is lacking over 100 feet. This plat as well as the Plat of Book B, Page 59 is proportioned from the west occupational fence of Lot 14 to the east end of the block (at 1st Street). From that point, the proportioned lot widths fairly closely follows other occupation fences.

LEGEND

- ⊙ Set #5 rebar & plastic cap stamped L SMITH PLS 12751
- ⊕ Set P-K nail and disc stamped L SMITH PLS 12751
- △ Found concrete monument with brass cap or remaining post of brass cap, R.E. Fonger, unrecorded map of the City of Caliente in possession of L.D. Smith.
- ⊙ Found Street well with 3" brass cap stamped OWENS PLS 2884, no recorded maps found. (Unrecorded and unsigned map in possession of the City of Caliente)
- Lot line
- Block line
- - - Street centerline

RECORDER'S CERTIFICATE

File No. 123631
 Recorded at the request of
 Lenard D. Smith
 Filed Plat Book C, Page 96
 Lincoln County, Nevada Records
 Date Jan 13, 2005
 at 1:43 pm
 LESLIE BOUCHER, RECORDER
 by Amy Elmer, Deputy

RECORD OF SURVEY

For John G. Barton, jr.

*In Block C of the Westend Addition
 to the City of Caliente, Lincoln County,
 Nevada, Section 7, T. 4 S., R. 67 E., M.D.M.*

Lenard Smith
 Land Survey
 509 Main Street
 P.O. Box 443
 Caliente, Nevada 89008
 Phone/Fax 775 726 3365