

R.70 E.

R.71 E.

Section

Line

North

Sec 24

Sec 19

Due East

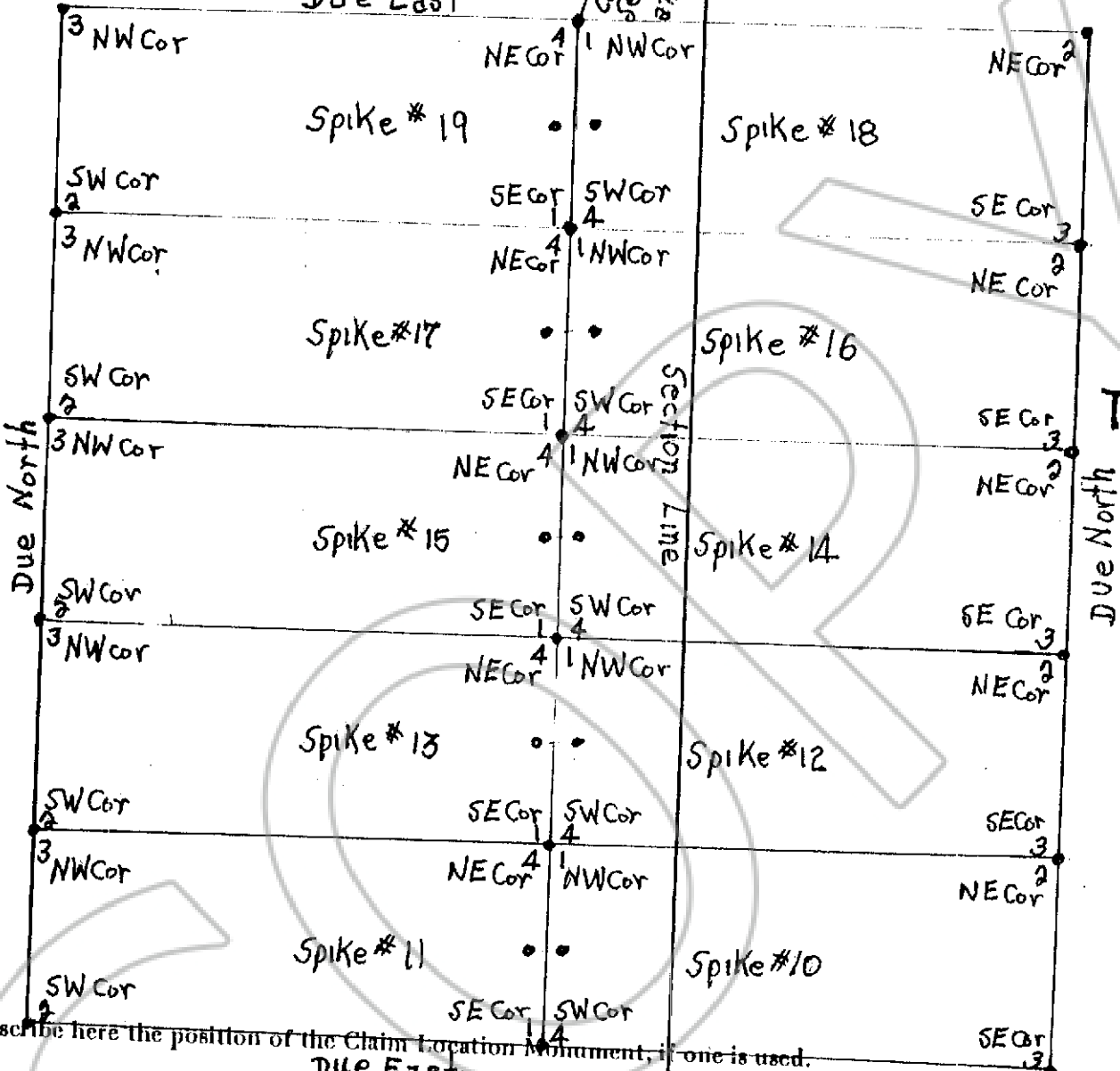

1200' N.30° E. To
Common Corner of
Sections 18, 19, 17
and Sections 13, 14, 15, R.70 E.

Section
Line

T.75.

Describe here the position of the Claim Location Monument, if one is used.

MAP OF THE SPIKE GROUP OF LOBE CLAIMS
Lincoln County, Nevada, Unknown Mining Dist.
Located in the NE 1/4 & SE 1/4 sec 24, T.75., R.70 E. &
Map of the Spike in the NW 1/4 & SW 1/4 Sec 19, T.75., R.71 E.

0 500' 1000'
Scale 1 Inch = 500 Feet

in Section 24 Township, 7 S. Range 70 E.
Section 19 Township 7 S. Range 70 E.
in the Unknown Mining District,
Lincoln County, Nevada.

Located on the 18 day of October, 192004 by
Preston L. Hafen
Locator name and address (please print)
Preston L. Hafen
115 South Main
Veyo, Utah 84782

RECORDER'S STAMP

FILED FOR RECORDING
AT THE REQUEST OF
Preston L. Hafen
2004 NOV 8 AM 11 56
LINCOLN COUNTY RECORDER
FEE \$154.00
DEP
LESLIE BOUCHER

123367