

CALIENTE CITY PLANNING COMMISSION

At the regular meeting of the Caliente City Planning Commission meeting held this 12 day of October, 2004 this plat was examined and is hereby recommended for approval.

Stan S. Wallis
Chairman

CALIENTE CITY COUNCIL

At the regular meeting of the Caliente City Council held this 21st day of October, 2004, this plat was examined and approved for recordation.

The City of Caliente accepts the dedication of the Meadow Valley Wash area as shown for public purposes.

Kevin Adams Mayor
David Lytle Attest: City Clerk

BASIS OF BEARINGS

The Basis of Bearings as shown on the James H. Gottfredson Addition to the City of Caliente on Holt Avenue, shown on Plat Book A, Page 72, Lincoln County, Nevada Records (S44°29'W).

SURVEYOR'S CERTIFICATE

I, Lenard D. Smith, a Professional Land Surveyor registered in the State of Nevada, certify that:

- This plat represents the results of a survey conducted under my supervision at the instance of Wesley A. Holt. I have conducted a field survey and have properly identified the proposed boundary line adjustments.
- The land surveyed lies within Section 7, T. 4 S., R. 67 E., M.D.M. the survey was completed on _____.
- This plat complies with applicable statutes of this state and any local ordinances in effect on the date that the survey was completed. The survey was conducted in accordance with Chapter 625 of the Nevada Administrative Code.
- The monuments depicted on the plat are of the character shown, occupy the positions indicated, and are of sufficient durability. All corners and angle points of the adjusted boundary line have been defined by monuments.
- This map is not in conflict with the provisions of NRS 278.010 to 278.630 inclusive.

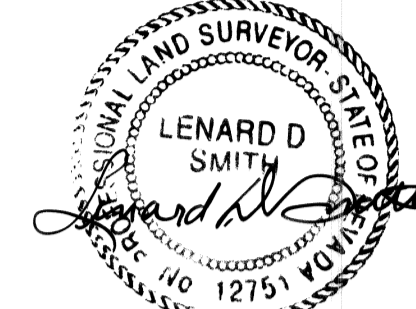

Lenard D. Smith, P.L.S. 12751 Exp. 6/30/04

OWNER'S CERTIFICATE

- I have examined this plat and authorize the recording, thereof.
- I agree to execute the required documents creating any easements which is shown.
- I agree to execute the required documents abandoning any existing easement pursuant to the provisions of NRS 278.010 to 278.630 inclusive.
- All property taxes on the land for the fiscal year have been paid.
- Any lender with an impound account for the payment of taxes has been notified of the adjustment of the boundary line or the transfer of the land.

Wesley A. Holt
Wesley A. Holt

ACKNOWLEDGEMENT

The above person has appeared before me and have executed the Owner's Certificate freely and voluntarily for the purposes stated.

David Lytle Notary Public
Date 10-6-04

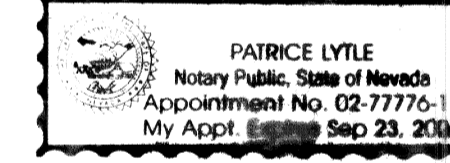

MAP REFERENCES

JAMES H. GOTTFREDSON ADDITION TO THE CITY OF CALIENTE, Plat Book A, Page 72 of Lincoln County, Nevada Records.

RECORD OF SURVEY Plat Book B, Page 103, of Lincoln County, Nevada Records.

Parcel Map of Lots 4 & 5 of the Block A, James H. Gottfredson Subdivision recorded Plat Book A, Page 285, Lincoln Co. Nevada Records.

Parcel Map, plat Book C, Page _____ of Lincoln Co. Nevada Records

RECORDER'S CERTIFICATE

File Number 123341

Recorded at the request of Lenard D. Smith

Filed Plat Book C, Page 84 Lincoln County, Nevada Records

Date Nov. 5, 2004 at 1:02 p m

LESLEIE BOUCHER, RECORDER
Leslie Boucher

PARCEL MAP MERGER

Subsequently Parceling Parcel 2 with Mergers, of Parcel Map Plat Book C, Page 82 of Lincoln County, Nevada Records

IN SECTION 7, T. 4 S., R. 67 E., M.D.M.

Portion of LOT 4, and all of LOTS 5, 6 and 7 of the JAMES H. GOTTFREDSON ADDITION TO CITY OF CALIENTE, in LINCOLN COUNTY, NEVADA

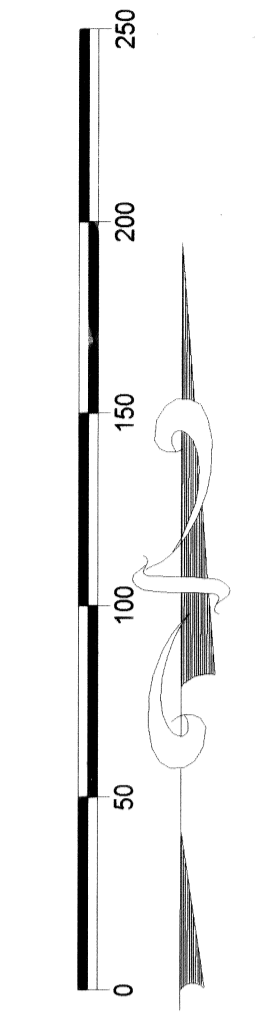

SCALE: 1" = 50.00'

LEGEND

- Found 5/8" rebar & cap stamped L SMITH PLS 12751
- ⊕ Found PK Nail & disk stamped L SMITH PLS 12751
- △ Found old conc. monument and disk center stem (Disk missing) from unrecorded map by RE Fonger PLS 4235. Represents Lincoln Street centerline. Map in possession of L. Smith.
- + Found Street Centerline Wall marked P.L.S. 2884, slightly sunk & paved over. No maps recorded.
- See tabulation below of individual lot area (Square Feet)
- 12,345 Combined total area of merged properties (see tabulation below) (1,234)
- Individual area of Lots or Parcels prior to merging.

AREA DATA OF MERGED LOTS WITH PARCELS

PARCEL NUMBER	ORIGINAL LOT AS FENCED Square feet	BE MERGED REAR LOT TO BE MERGED Square feet	COMBINED TOTAL Square feet
1	7,679	8,985	16,664
2	11,156	11,923	23,079
3	5,847	5,307	10,954
4		not merged	

OWNER'S CERTIFICATE

STATE OF NEVADA } ss
COUNTY OF LINCOLN

We certify that we are the owners of the presently existing lots in Block A of the Gottfredson Subdivision of the City of Caliente, Lincoln County, Nevada as shown hereon and agree to the existing fence sidelines as shown. Additionally, where applicable agree to the mergers of lots and properties as shown.

- Lot 1 *Dale Wallis*
Dale Wallis
- Lot 2 *Beuford G. Sanders*
Beuford G. Sanders
- Lot 3 *Brian R. Elkins* *Melanie Elkins*
BRYAN R. ELKINS Melanie Elkins

ACKNOWLEDGEMENT

STATE OF NEVADA } ss
COUNTY OF LINCOLN

This is to certify that Brian R. Elkins, Melanie Elkins, Beuford G. Sanders and Dale Lloyd Wallis have appeared before me, a Notary Public, and have executed the Owner's Certificate in behalf of their respective properties of this plat, freely and voluntarily for the purposes stated.

Patricia Lytle Notary Public
PATRICIA LYTLE
Notary Public, State of Nevada
Appointment No. 02-77776-11
My Appt. Expires Sep 23, 2006

