

SURVEYOR'S CERTIFICATE

I, SPENCER W. HAFEN, A PROFESSIONAL LAND SURVEYOR LICENSED IN THE STATE OF NEVADA, DO HEREBY CERTIFY THAT:

1. THIS PLAT REPRESENTS THE RESULTS OF A SURVEY CONDUCTED BY ME, OR UNDER MY DIRECT SUPERVISION AT THE INSTANCE OF HI-DESERT SPRINGS CORPORATION, LLC.
2. THE LANDS SURVEYED LIE WITHIN THE NE 1/4 OF SEC. 1, T. 6 S., R. 60 E., M.D.M., AND THE SURVEY WAS COMPLETED ON OCT. 28, 2004.
3. THIS PLAT COMPLIES WITH THE APPLICABLE STATE STATUTES AND ANY LOCAL ORDINANCES IN EFFECT ON THE DATE THE SURVEY WAS COMPLETED AND PERFORMED IN ACCORDANCE WITH THE NEVADA ADMINISTRATIVE CODE STANDARDS OF PRACTICE FOR A PROFESSIONAL LAND SURVEYOR.
4. THE MONUMENTS DEPICTED ON THIS PLAT ARE OF THE CHARACTER SHOWN, OCCUPY THE POSITIONS INDICATED AND ARE OF SUFFICIENT NUMBER AND DURABILITY.

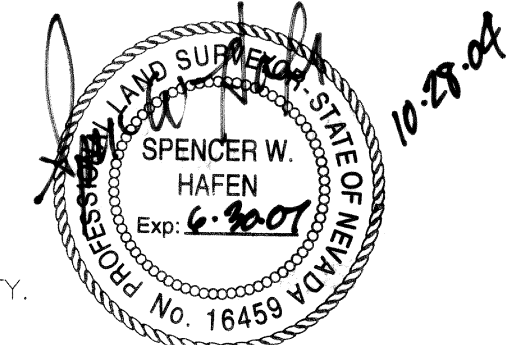

SPENCER W. HAFEN
PROFESSIONAL LAND SURVEYOR
NEVADA CERTIFICATE NO. 16459

STATEMENT

ANY SUBSEQUENT CHANGES TO THIS MAP SHOULD BE EXAMINED AND MAY BE DETERMINED BY REFERENCE TO THE COUNTY RECORDER'S CUMULATIVE MAP INDEX, N.R.S. 278.5695.

BASIS OF BEARING

S. 14°47'18" E. BEING THE BEARING ON THE LINE FROM THE UNITED STATES COAST AND GEODETIC SURVEY (USC&GS) BRASS CAP "ASH", AND THE UNITED STATES COAST AND GEODETIC SURVEY (USC&GS) BRASS CAP "CORRAL", SAID BEARING IS BASED UPON THE NORTH AMERICAN DATUM OF 1983 (NAD83), NEVADA STATE PLANE EAST ZONE (2701) COORDINATE SYSTEM.

REFERENCE DOCUMENTS

1. 1873 G.L.O. SURVEY OF T. 6 S., R. 60 E., M.D.M.
2. 1964 B.L.M. DEPENDENT RESURVEY OF T. 5 S., R. 60 E., M.D.M.
3. 1994 B.L.M. DEPENDENT RESURVEY OF T. 6 S., R. 60 E., M.D.M.
4. RECORD OF SURVEY OF ASH SPRINGS SUBDIVISION BOOK PLAT A, PAGE 74.
5. RECORD OF SURVEY BOOK PLAT A, PAGE 414.
6. GRANT, BARGAIN, SALE DEED, BOOK 115, PAGE 194.
7. GRANT, BARGAIN, SALE DEED, BOOK 114, PAGE 14.
8. GRANT, BARGAIN, SALE DEED, BOOK 154, PAGE 442.
9. GRANT, BARGAIN, SALE DEED, BOOK 107, PAGE 597.
10. DEED BOOK E-1, PAGE 259.
11. DEED BOOK G-1, PAGE 39.
12. DEED BOOK 107, PAGE 619.
13. DEED BOOK 188, PAGE 217.

LEGEND

- ◆ FOUND SEC. COR. AS DESCRIBED.
- FOUND 1/4 SEC. COR. AS DESCRIBED.
- FOUND 1.5" IRON PIPE
- SET 5/8" REBAR W/ CAP MARKED "S HAFEN PLS 16459", UNLESS OTHERWISE NOTED.
- R/W RIGHT-OF-WAY
- (M) MEASURED DATA
- (R) RECORDED DATA

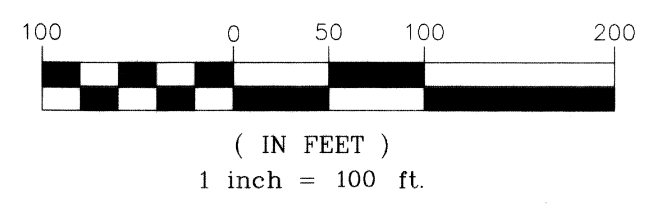

RECORD OF SURVEY

FOR
HI-DESERT SPRINGS CORPORATION, LLC
SITUATED WITHIN THE NE 1/4 OF SEC. 1, T. 6 S., R. 60 E., M.D.M., LINCOLN COUNTY, NEVADA

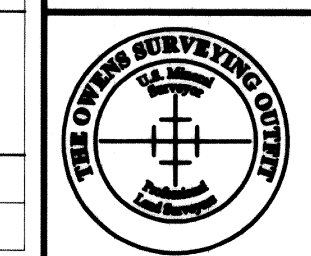

THE OWENS SURVEYING OUTFIT, INC.
Water Right, Mineral & Land Surveying throughout the West
P.O. BOX 1330
650 HARDY WAY SUITE 201
MESQUITE, NV 89024
702-346-2930

NO. **123311**
FILED AT THE REQUEST OF:
THE OWENS SURVEYING OUTFIT, INC.
DATE **11-1-04** AT **10:53 AM**
BOOK PLAT **C** PAGE **81**
LINCOLN COUNTY, NEVADA, RECORDS
LESLIE BOUCHER, RECORDER
FEE \$21.00 DEPUTY

POINT NAME	GEOGRAPHIC COORDINATES NAD83		NAD83 STATE PLANE COORDINATES (NV EAST ZONE)					CONVERGENCE	COMBINED FACTOR	POINT DESCRIPTION
	NAD83		METERS		US SURVEY FEET		ELEVATION NAVD88			
	LATITUDE	LONGITUDE	NORTHING	EASTING	NORTHING	EASTING				
CORRAL	37°24'20.36410" N	115°10'21.38156" W	8294722.7142	236360.8387	1071.4272	27213602.7716	775460.5182	3598.3294	0'14'58.20291"	U.S.G.S. B.C. DATED 1969
ASH	37°27'21.88297" N	115°11'20.43296" W	8300312.1047	234885.2873	1149.8234	27231940.63	770619.48	3772.38	0'14'23.32278"	U.S.G.S. B.C. DATED 1969