

122780

A.P.N. # 01-240-21

R.P.T.T. \$ 58.50

ESCROW NO. 19029415

RECORDING REQUESTED BY:

COW COUNTY TITLE

MAIL TAX STATEMENTS TO:
SAME AS BELOW

FILED FOR RECORDING
AT THE REQUEST OF

Cow County Title

2004 AUG 6 PM 4 40

LINCOLN COUNTY RECORDER
FEE 15⁰⁰ 58.50 DEPT 10
LESLIE BOUCHER

WHEN RECORDED MAIL TO:
JOHN & JANICE PALMERI
1101 PYRAMID DR
LAS VEGAS NV 89108

(Space Above for Recorder's Use Only)

GRANT, BARGAIN, SALE DEED

THIS INDENTURE WITNESSETH: That **THOMAS GERALD PRYATEL and DEBORAH L. PRYATEL**, husband and wife as joint tenants

in consideration of \$10.00, the receipt of which is hereby acknowledged, does hereby Grant, Bargain Sell and Convey to **JOHN PALMERI and JANICE PALMERI**, husband and wife as joint tenants

and to the heirs and assigns of such Grantee forever, all that real property situated in the County of **LINCOLN** State of Nevada, bounded and described as:

SEE EXHIBIT "A" ATTACHED HERETO AND MADE A PART HEREOF

Together with all and singular the tenements, hereditaments and appurtenances thereunto belonging or in anywise appertaining, and any reversions, remainders, rents, issues or profits thereof.

DATE: July 21, 2004

Thomas Gerald Pryatel

THOMAS GERALD PRYATEL

Deborah L. Pryatel

DEBORAH L. PRYATEL

STATE OF Utah
COUNTY OF Washington ss.

This instrument was acknowledged before me on
by THOMAS GERALD PRYATEL and DEBORAH L. PRYATEL

Signature *Jan Smith*

Notary Public (One inch margin on all sides of document for Recorder's Use Only)

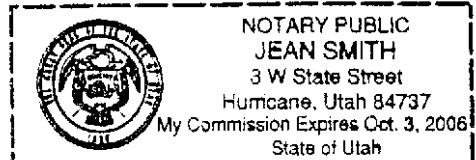

EXHIBIT "A"

LEGAL DESCRIPTION

ESCROW NO.: 19029415

A portion of the South Half (S 1/2) of the Southwest Quarter (SW 1/4) of the Northeast Quarter (NE 1/4) of Section 14, Township 1 North, Range 67 East, M.D.B. & M., more particularly described as follows:

Parcel 2 of that certain parcel map recorded August 22, 1994 in the office of the County Recorder of Lincoln County, Nevada in Book A of Plats, page 428 as File No. 102258, Lincoln County, Nevada records.

ASSESSOR'S PARCEL NUMBER FOR 2004 - 2005: 01-240-21

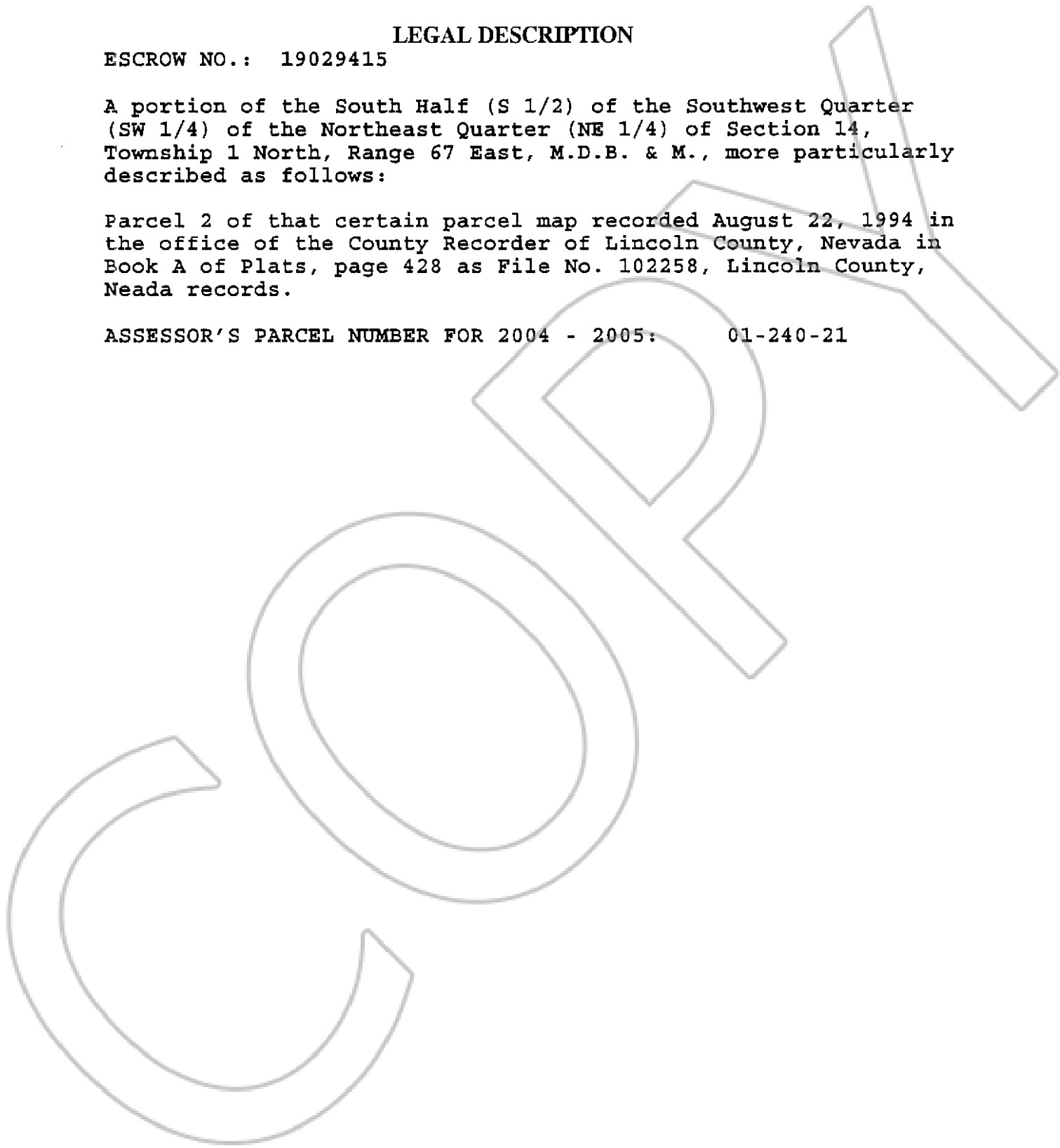

**STATE OF NEVADA
DECLARATION OF VALUE**

FOR RECORDERS OPTIONAL USE ONLY
 Document/Instrument No.: 122780
 Book: 189 Page: 270
 Date of Recording: Aug 6, 2004
 Notes: _____

1. Assessor Parcel Number(s):
 a) 01-240-21
 b) _____
 c) _____
 d) _____

2. Type of Property:
 a) XX Vacant Land b) _____ Single Family Res.
 c) _____ Condo/Townhouse d) _____ 2-4 Plex
 e) _____ Apartment Bldg. f) _____ Comm'l/Ind'l
 g) _____ Agricultural h) _____ Mobile Home
 i) Other: _____

3. Total Value/Sales Price of Property \$ 15,000.00
 Deed in Lieu of Foreclosure Only (Value of Property) \$ _____
 Transfer Tax Value \$ _____
 Real Property Transfer Tax Due: \$ 58.50

4. If Exemption Claimed:
 a. Transfer Tax Exemption, per NRS 375.090, Section: _____
 b. Explain Reason for Exemption: _____

5. Partial Interest: Percentage being transferred: _____ %

The undersigned declares and acknowledges, under penalty of perjury, pursuant to NRS 375.060 and NRS 375.110, that the information provided is correct to the best of their information and belief, and can be supported by documentation if called upon to substantiate the information provided herein. Furthermore, the disallowance of any claimed exemption or other determination of additional tax due, may result in a penalty of 10% of the tax due plus interest at 1% per month. Pursuant to NRS 375.030, the Buyer and Seller shall be jointly and severally liable for any additional amount owed

Signature: Thomas Gerald Pryatel Capacity: _____

Signature: Nehorah L Pryatel Capacity: _____

SELLER (GRANTOR) INFORMATION
(required)

Print Name: THOMAS GERALD PRYATEL
 Address: 6939 FOOTHILL DR.
 City/State/Zip: HURRICANE, UT 84737

BUYER (GRANTEE) INFORMATION
(required)

Print Name: JOHN PALMERI
 Address: 1101 PYRAMID DR
 City/State/Zip: LAS VEGAS, NV 89108

COMPANY/PERSON REQUESTING RECORDING (required if not the Seller or Buyer)

Company Name: COW COUNTY TITLE Escrow No.: 19029415
 Address: 363 Erie Main St.
 City/State/Zip: Tonopah, NV 89049

(AS A PUBLIC RECORD THIS FORM MAY BE RECORDED/MICROFILMED)