

SURVEYOR'S CERTIFICATE

I, JAMES J. OWENS, A PROFESSIONAL LAND SURVEYOR REGISTERED IN THE STATE OF NEVADA, DO HEREBY CERTIFY THAT:

1. THIS PLAT REPRESENTS THE RESULTS OF A SURVEY CONDUCTED BY ME, OR UNDER MY DIRECT SUPERVISION AT THE INSTANCE OF JIM VINCENT OF J&S PROPERTIES.
2. THE LANDS SURVEYED LIE WITHIN THE SW1/4 SE1/4 OF SEC. 10, T. 1 N., R. 67 E., M.D.M., AND THE SURVEY WAS COMPLETED ON JAN. 10, 2004.
3. THIS PLAT COMPLIES WITH THE APPLICABLE STATE STATUTES AND ANY LOCAL ORDINANCES IN EFFECT ON THE DATED THE SURVEY WAS COMPLETED AND PERFORMED IN ACCORDANCE WITH THE NEVADA ADMINISTRATIVE CODE STANDARDS OF PRACTICE FOR A PROFESSIONAL LAND SURVEYOR.
4. THE MONUMENTS DEPICTED ON THIS PLAT ARE OF THE CHARACTER SHOWN, OCCUPY THE POSITIONS INDICATED AND ARE OF SUFFICIENT NUMBER AND DURABILITY.

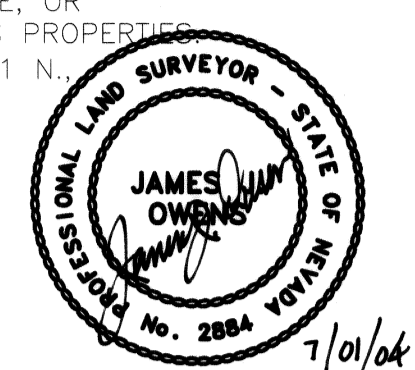

OWNER'S CERTIFICATE

I, JIM VINCENT OF J&S PROPERTIES, DO HEREBY CERTIFY THAT BEING THE OWNER OF THE LAND HEREON SHOWN, HAVE CAUSED THIS PROPERTY TO BE PLOTTED INTO PARCELS, AND EASEMENTS AS SHOWN AND, DO HEREBY DEDICATE ALL SHOWN PUBLIC UTILITY EASEMENTS TO THE PUBLIC UTILITY AGENCIES FOR THE CONSTRUCTION AND MAINTENANCE OF SURFACE AND SUBTERRANEAN UTILITIES, AND DO HEREBY CONSENT TO THE PREPARATION AND RECORDATION OF THIS PARCEL MAP.

Jim Vincent 7/3/04
 JIM VINCENT, OF J & S PROPERTIES DATE

ACKNOWLEDGMENT

STATE OF NEVADA SS
 COUNTY OF CLARK
 THIS INSTRUMENT WAS ACKNOWLEDGED BEFORE ME ON THIS 3 DAY OF July 2004, BY Jim Vincent BY JIM VINCENT.
 MY COMMISSION EXPIRES ON THE 12 DAY OF NOVEMBER 2007.

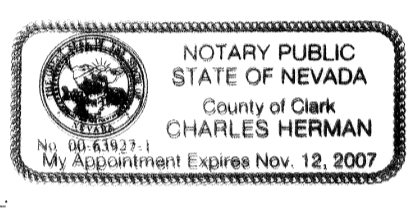

LINCOLN COUNTY COMMISSION APPROVAL

THIS MAP HAS BEEN REVIEWED AND APPROVED ON THIS 6th DAY OF July, 2004, BY THE LINCOLN COUNTY COMMISSIONERS AS A PARCEL MAP.

George J. Row 7-6-04
 CHAIRMAN, LINCOLN COUNTY COMMISSION DATE

[Signature] 7-6-04
 ATTEST: CLERK DATE

LINCOLN COUNTY PLANNING COMMISSION APPROVAL

THIS IS TO CERTIFY THAT THE ZONING AND COMPREHENSIVE PLANNING, OF THE COUNTY OF LINCOLN, NEVADA ON THIS 6th DAY OF July, 2004, DID APPROVE FOR THE PURPOSE OF LAND DIVISION AND DO HEREBY ACCEPT IN BEHALF OF THE PUBLIC, THIS PLAT AND ANY PARCEL OF LAND OFFERED FOR DEDICATION FOR PUBLIC USE IN CONFORMITY WITH THE TERMS OF THE OFFER OF DEDICATION PER N.R.S. 278.010 THROUGH 278.630, INCLUSIVE.

Sharon Zeh 6-21-04
 CHAIRMAN, LINCOLN COUNTY PLANNING COMMISSION DATE

TOWN OF PIOCHE APPROVAL

THIS MAP HAS BEEN REVIEWED AND APPROVED ON THIS 8th DAY OF June, 2004, BY THE TOWN BOARD OF THE TOWN OF PIOCHE AS A PARCEL MAP.

William O. [Signature] 6-8-04
 CHAIRMAN, TOWN OF PIOCHE, TOWN BOARD DATE

ATTEST: CLERK DATE

REFERENCE DOCUMENTS

1. RECORD OF SURVEY BOOK PLAT B, PAGE 339, DATED SEPT. 27, 2000.
2. PARCEL MAP BOOK PLAT C, PAGE 49.

STATEMENT

ANY SUBSEQUENT CHANGES TO THIS MAP SHOULD BE EXAMINED AND MAY BE DETERMINED BY REFERENCE TO THE COUNTY RECORDER'S CUMULATIVE MAP INDEX, N.R.S. 278.5695.

LEGEND

- SET 5/8" REBAR W/ PLASTIC CAP MARKED "OWENS PLS 2884".
- FOUND 5/8" REBAR W/ PLASTIC CAP MARKED "OWENS PLS 2884".
- FOUND 2" BRASS CAP MARKED PLS 3644 IN 6" CONC. MON, UNLESS OTHERWISE NOTED.

BASIS OF BEARING

THE BASIS OF BEARING IS A LINE BETWEEN THE SE COR. AND THE S1/4 COR. OF SEC. 10, T. 1 N., R. 67 E., M.D.M., AS SHOWN ON RECORD OF SURVEY BOOK PLAT B, PAGE 339, WHICH BEARS N. 88° 50' 55" E.

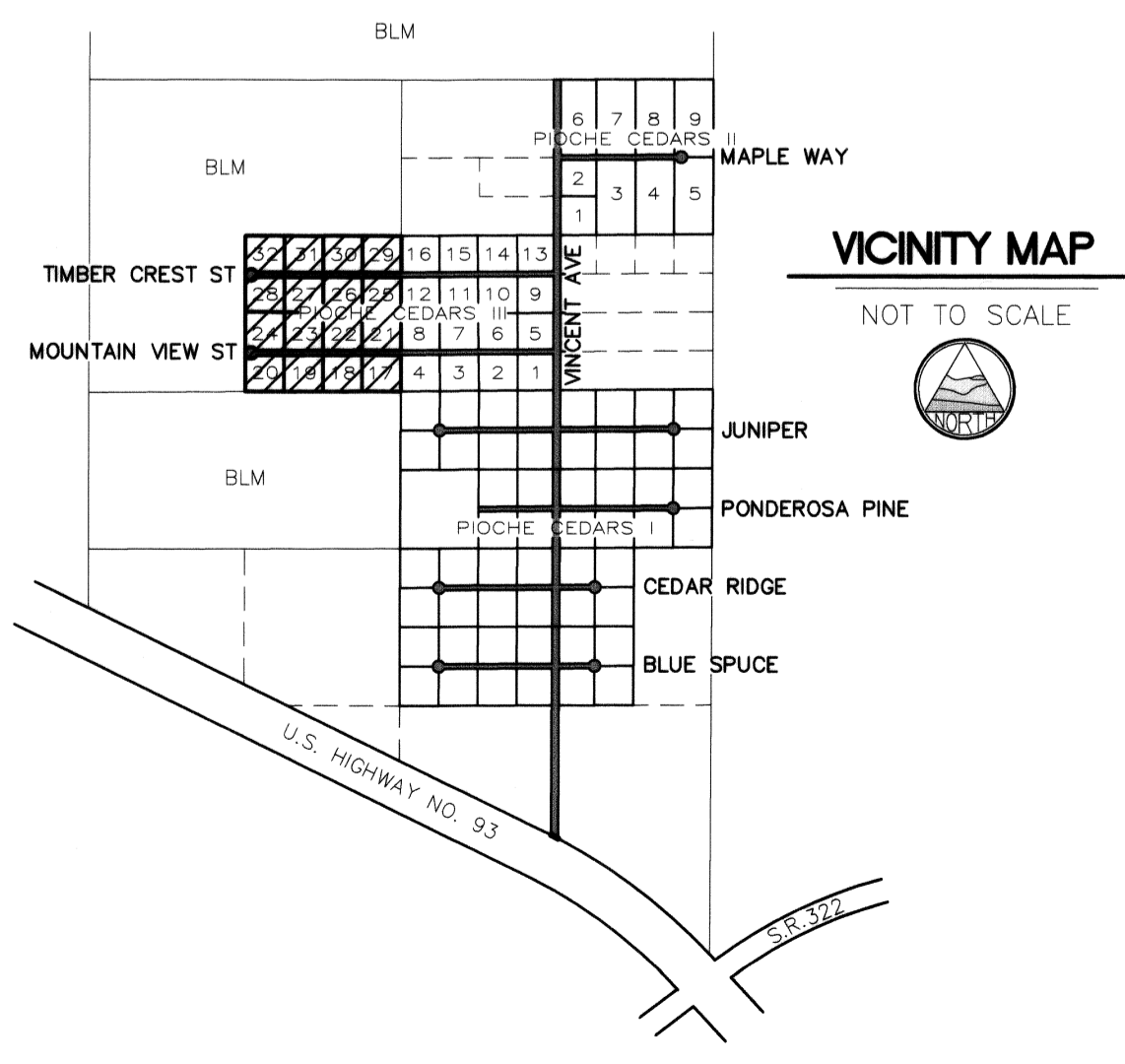
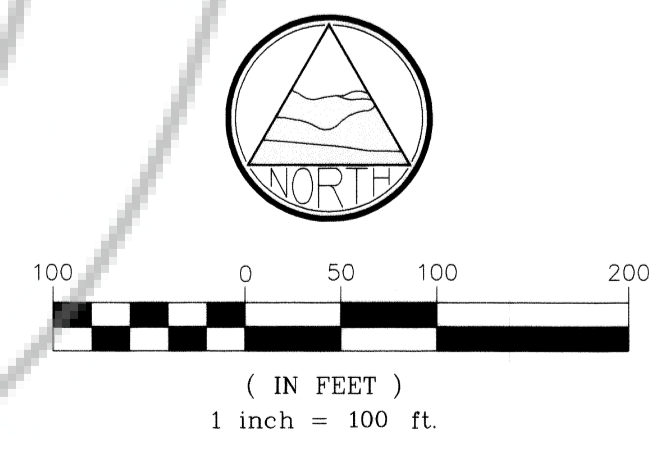

PARCEL MAP
 FOR
J AND S PROPERTIES
 SITUATED WITHIN THE SW1/4 SE1/4 OF SEC. 10, T. 1 N., R. 67 E., M.D.M., TOWN OF PIOCHE, LINCOLN COUNTY, NEVADA

THE OWENS SURVEYING OUTFIT, INC.
 P.O. BOX 540
 99 W HOLLYWOOD
 PIOCHE, NV 89043
 775-962-5115

NO. 122620
 FILED AT THE REQUEST OF:
 THE OWENS SURVEYING OUTFIT, INC.
 DATE 7-12-04 AT 3:23
 BOOK PLAT C PAGE 61
 LINCOLN COUNTY, NEVADA, RECORDS
 LESLIE BOUCHER, RECORDER
 FEE 2100 *Leslie Boucher* DEPUTY