

**LEGEND**

- SET 5/8" REBAR W/ PLASTIC CAP MARKED "OWENS PLS 2884"
- FOUND 1/2" REBAR W/ PLASTIC CAP MARKED "HULSE PLS 6498"
- FOUND 2" BRASS CAP MARKED PLS 3644 IN 6" CONC. MON.

**BASIS OF BEARING**

THE BASIS OF BEARING IS A LINE BETWEEN THE SE COR. AND THE E1/4 COR. OF SEC. 10, T. 1 N., R. 67 E., M.D.M., AS SHOWN ON RECORD OF SURVEY BOOK PLAT B, PAGE 339, WHICH BEARS N. 00°13'27" W.

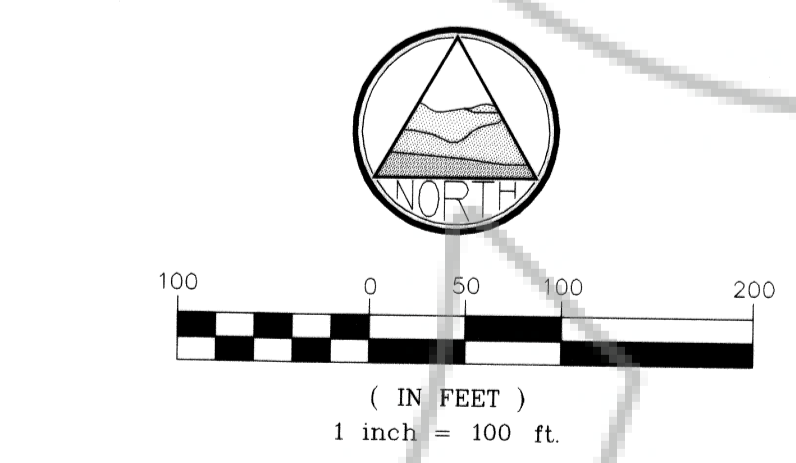

| CURVE TABLE |            |        |         |         |
|-------------|------------|--------|---------|---------|
| CURVE       | DELTA      | RADIUS | LENGTH  | TANGENT |
| C1          | 55°09'00"  | 20.00' | 19.25'  | 10.44'  |
| C2          | 145°09'00" | 50.00' | 126.67' | 159.31' |

**SURVEYOR'S CERTIFICATE**

I, JAMES J. OWENS, A PROFESSIONAL LAND SURVEYOR REGISTERED IN THE STATE OF NEVADA, DO HEREBY CERTIFY THAT:  
 1. THIS PLAT REPRESENTS THE RESULTS OF A SURVEY CONDUCTED BY ME, OR UNDER MY DIRECT SUPERVISION AT THE INSTANCE OF JIM VINCENT.  
 2. THE LANDS SURVEYED LIE WITHIN THE NE1/4 OF SEC. 10, T. 1 N., R. 67 E., M.D.M., AND THE SURVEY WAS COMPLETED ON OCT. 10, 2003.  
 3. THIS PLAT COMPLIES WITH THE APPLICABLE STATE STATUTES AND ANY LOCAL ORDINANCES IN EFFECT ON THE DATED THE SURVEY WAS COMPLETED AND PERFORMED IN ACCORDANCE WITH THE NEVADA ADMINISTRATIVE CODE STANDARDS OF PRACTICE FOR A PROFESSIONAL LAND SURVEYOR.  
 4. THE MONUMENTS DEPICTED ON THIS PLAT ARE OF THE CHARACTER SHOWN, OCCUPY THE POSITIONS INDICATED AND ARE OF SUFFICIENT NUMBER AND DURABILITY.

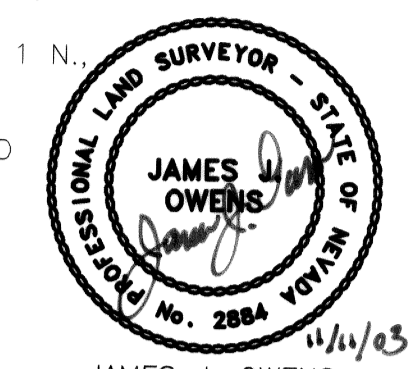

**OWNER'S CERTIFICATE**

I, JIM VINCENT, DO HEREBY CERTIFY THAT BEING THE OWNER OF THE LAND HEREON SHOWN, HAVE CAUSED THIS PROPERTY TO BE PLOTTED INTO PARCELS, AND EASEMENTS AS SHOWN AND, DO HEREBY DEDICATE ALL SHOWN PUBLIC UTILITY EASEMENTS TO THE PUBLIC UTILITY AGENCIES FOR THE CONSTRUCTION AND MAINTENANCE OF SURFACE AND SUBTERRANEAN UTILITIES, AND DO HEREBY CONSENT TO THE PREPARATION AND RECORDATION OF THIS PARCEL MAP.

*Jim Vincent* 11/7/03  
 JIM VINCENT DATE

**ACKNOWLEDGMENT**

STATE OF NEVADA SS  
 COUNTY OF CLARK  
 THIS INSTRUMENT WAS ACKNOWLEDGED BEFORE ME ON THIS 7 DAY OF November, 2003, BY JIM VINCENT.  
*J. Randall*  
 MY COMMISSION EXPIRES ON THE 23 DAY OF October, 2006

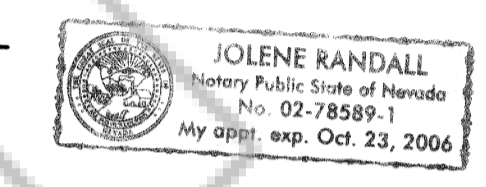

**LINCOLN COUNTY COMMISSION APPROVAL**

THIS MAP HAS BEEN REVIEWED AND APPROVED ON THIS 3<sup>rd</sup> DAY OF November, 2003, BY THE LINCOLN COUNTY COMMISSIONERS AS A PARCEL MAP.  
*George T. Rowe* 11-3-03  
 CHAIRMAN, LINCOLN COUNTY COMMISSION DATE  
*Cornie Hogan* 11-3-03  
 ATTEST: CLERK DATE

**LINCOLN COUNTY PLANNING COMMISSION APPROVAL**

THIS IS TO CERTIFY THAT THE ZONING AND COMPREHENSIVE PLANNING, OF THE COUNTY OF LINCOLN, NEVADA ON THIS 20 DAY OF Oct., 2003, DID APPROVE FOR THE PURPOSE OF LAND DIVISION AND DO HEREBY ACCEPT IN BEHALF OF THE PUBLIC, THIS PLAT AND ANY PARCEL OF LAND OFFERED FOR DEDICATION FOR PUBLIC USE IN CONFORMITY WITH THE TERMS OF THE OFFER OF DEDICATION PER N.R.S. 278.010 THROUGH 278.630, INCLUSIVE.  
*Sharon R. Smith* 10-20-03  
 CHAIRMAN, LINCOLN COUNTY PLANNING COMMISSION DATE

**TOWN OF POCHE APPROVAL**

THIS MAP HAS BEEN REVIEWED AND APPROVED ON THIS 14 DAY OF Oct., 2003, BY THE TOWN BOARD OF THE TOWN OF POCHE AS A PARCEL MAP.  
*Shannon Zloch* 11-17-03  
 CHAIRMAN, TOWN OF POCHE TOWN BOARD DATE  
*Darlene Bayler* 11-17-03  
 ATTEST: CLERK DATE

**REFERENCE DOCUMENTS**

- 1. PARCEL MAP BOOK PLAT 'C', PAGE 16, DATED 11/17/2003.

**STATEMENT**

ANY SUBSEQUENT CHANGES TO THIS MAP SHOULD BE EXAMINED AND MAY BE DETERMINED BY REFERENCE TO THE COUNTY RECORDER'S CUMULATIVE MAP INDEX, N.R.S. 278.5695.

**SUBSEQUENT PARCEL MAP**  
 FOR  
**JIM VINCENT**  
 SITUATED WITHIN THE NE1/4 SE1/4 OF SEC. 10, T. 1 N., R. 67 E., M.D.M., TOWN OF POCHE, LINCOLN COUNTY, NEVADA

**THE OWENS SURVEYING OUTFIT, INC.**  
 Water Right, Mineral & Land Surveying Throughout the West  
 P.O. BOX 540  
 99 W HOLLYWOOD  
 POCHE, NV 89043  
 775-962-5115

NO. **121255**  
 FILED AT THE REQUEST OF:  
 THE OWENS SURVEYING OUTFIT, INC.  
 DATE Nov. 17, 2003 AT 3:07 p.m.  
 BOOK PLAT C PAGE 17  
 LINCOLN COUNTY, NEVADA, RECORDS  
 LESLIE BOUCHER, RECORDER  
 FILED BY Sharon

LC-436  
 S.HAFEN