

LEGEND

- Set #5 rebar with cap stamped L SMITH PLS 12751
- ⊕ Found #5 rebar & plastic cap stamped PLS 6204
- Found #5 rebar & plastic cap stamped L SMITH PLS 12751

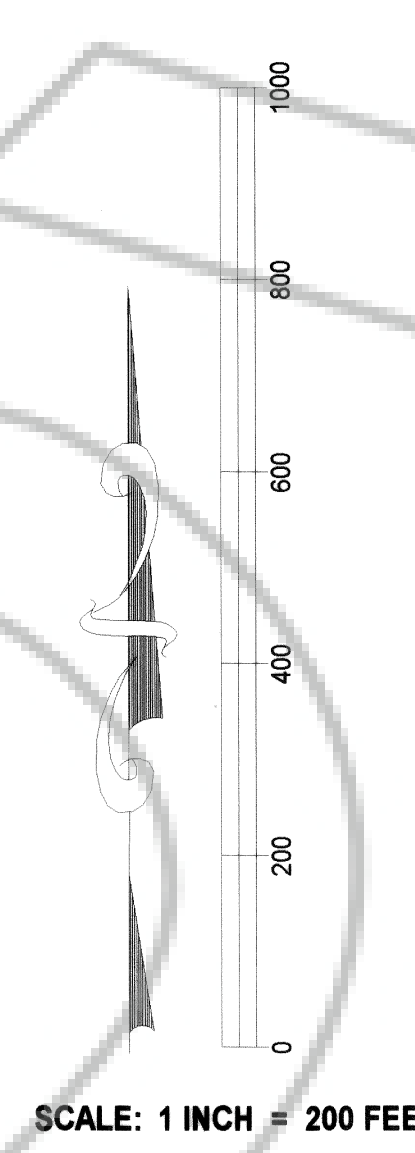

SCALE: 1 INCH = 200 FEET

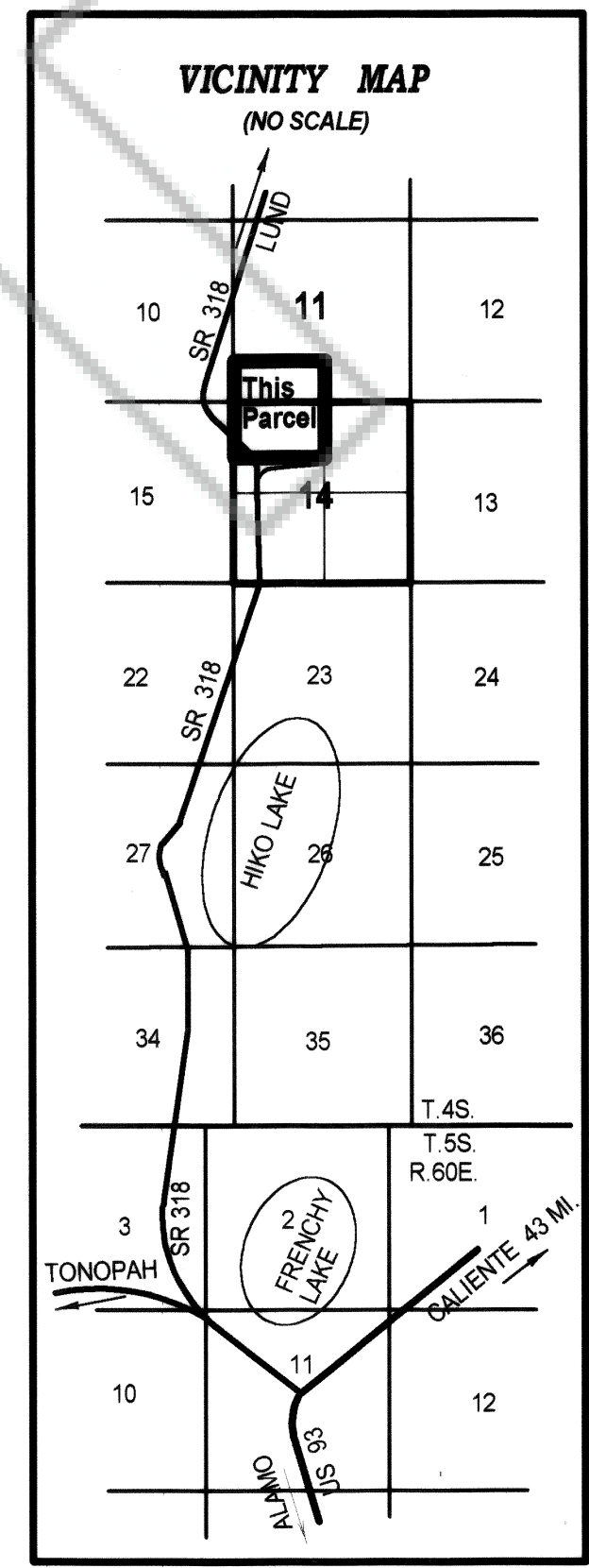

VICINITY MAP
(NO SCALE)

SURVEYOR'S CERTIFICATE

I, Lenard D. Smith, a Professional Land Surveyor licensed in the State of Nevada, certify that:

1. This plat represents the results of a survey conducted under my direct supervision at the instance of Keith Whipple and Michael Cannon.
2. The lands surveyed lie within Section 11 and 14, T. 4 S., R. 60 E., M.D.M. The survey was completed on _____.
3. This plat complies with the applicable state statutes and any local ordinances in effect on the date that the governing body gave its final approval.
4. The monuments depicted on the plat are of the character shown, occupy the positions indicated and are of sufficient number and durability.

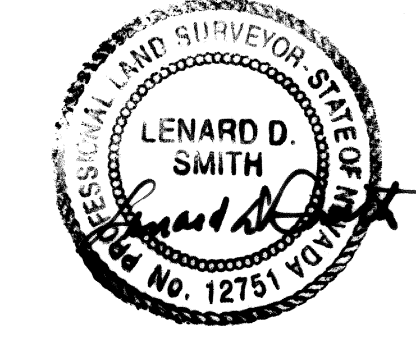

Lenard D. Smith P.L.S. 12751 Exp. 6/30/04

OWNERS CERTIFICATE

State of Nevada } ss
County of Lincoln

We certify that we are the owners of the parcels of this plat and that we have requested Lenard D. Smith, a Professional Land Surveyor, to prepare this map and authorize its recordation.

Keith Whipple *Gwendolyn Whipple*
Keith Whipple Gwendolyn Whipple

ACKNOWLEDGEMENT

The above persons have appeared before me and have executed the Owner's Certificate freely and voluntarily for the purposes stated.

Betty Jo Jarvis *Janet S. Boyle*
Notary Public Date: January 2, 2003

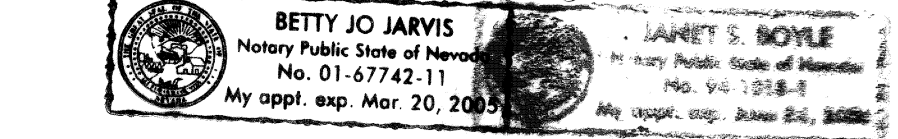

PLANNING COMMISSION

At the regular meeting of the Lincoln County Planning Commission held this 13th day of January, 2003, this map was examined and recommended for approval.

Steve R. Jankley
Chairman

BASIS OF BEARINGS

Bearings are based on the west line of the northwest quarter of Section 14, T. 4S., R. 60E., M.D.M. as shown on the Parcel Map filed Plat Book B, Page 415, Sheet two as N 00°31'53" E.

MAP REFERENCES

The Subdivision of this Section 14 is given on the map, Plat Book B, Page 415, Sheet two of Lincoln County, Nevada Records. This map divides Parcel 1 of the Parcel Map Plat Book A, Page 464, of Lincoln County, Nevada Records.

COUNTY COMMISSION

At the regular meeting of the Lincoln County Commission held this 21st day of January, 2003, this map was examined and approved for recordation.

George Z. Rowe *W.D. DePatty*
Chairman att: Co. Clerk

RECORDER'S CERTIFICATE

File number **119405**
Recorded at the request of Lenard D. Smith
Filed in Plat Book B, Page 469
This 20th day of January, 2003
at 2:33 p.m.
LESLIE BOUCHER, RECORDER
By *Darlene Deery*
Deputy

PARCEL MAP
FOR KEITH AND GWEN WHIPPLE
IN THE S1/2SW1/4 SECTION 11 AND THE
N1/2 SECTION 14, TOWNSHIP 4 SOUTH,
RANGE 60 EAST MOUNT DIABLO MERIDIAN,
LINCOLN COUNTY, NEVADA

Lenard D. Smith
Land Survey
509 Main Street
P.O. Box 443
Caliente, Nevada 89008
Phone/Fax 775 726 3365