

**HISTORY REPEATS**

**1. PLAN OF OPERATION UNDER 3809.11:**

**NAME:** Willard G. Pete  
Edwin Mc Cormies

**MAILING ADDRESS:** PO Box 483  
Caliente, NV 89008

**TAXPAYER IDENTIFICATION NUMBER OF THE OPERATOR (S):**  
Willard G. Pete, social security #530-12-0370

**BLM SERIAL NUMBER (S) OF ANY UNPATENTED MINING (S) WHERE  
DISTURBANCE WOULD OCCUR:**  
History Repeats #1, N.M.C. 703947  
History Repeats #2, N.M.C. 704378  
Disturbance would occur, History Repeats #1 N.M.C. 703947

**IF THE OPERATOR IS A CORPORATION, YOU MUST IDENTIFY ONE  
INDIVIDUAL AS THE POINT OF CONTACT:**  
(Owner) Willard G. Pete

You must notify B.L.M. in writing within 30 calendar days of any change of operator or corporate point of contact or in the mailing address of the operator or corporate point of contact.

**2. DISCRPTION OF OPERATIONS:**

**A DESCRIPTION OF THE EQUIPMENT, DEVICES, OR PRACTICES YOU  
PURPOSE TO USE DURING OPERATION INCLUDING APPLICABLE:**  
Backhoe, compressor, drills, powder, pick, and shovels

**MAPS OF THE PROJECT AREA AT AN APPROPRIATE SCALE SHOWING  
THE LOCATION OF EXPLORATION ACTIVITIES, DRILL SITES, MINING  
ACTIVITIES, PROCESSING FACILITIES, WASTE ROCK AND TAILING  
DISPOSAL AREAS, SUPPORT FACILITIES, STRUCTURES, BUILDINGS,  
AND ACCESS ROUTES:**  
See enclosed map

RR #1  
NMC 703947

Where disturbance would occur  
100 FT. AREA

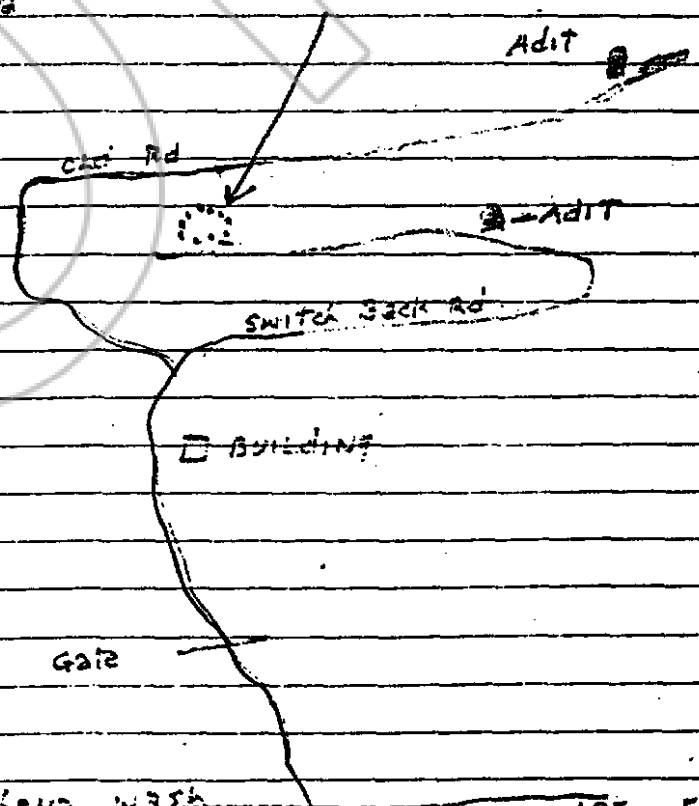

Helena Wash

COPY

118602

FILED FOR RECORDING  
AT THE REQUEST OF

*Willard G. Deke*

2002 AUG 8 PM 1 55

LINCOLN COUNTY RECORDER  
FEE \$14.00 DEP  
LESLIE BOUCHER AB