

Office of the Treasurer and Ex-officio  
Tax Receiver of Lincoln County, Nevada

Treasurer's Certificate for Holding  
Property for Delinquent Tax for  
the Fiscal Year 2001-2002

I, Kathy C. Hiatt, Treasurer of the County of Lincoln, State of Nevada, do hereby certify that the following named tax-payers were assessed for the Fiscal Year 2001-2002 on property and the tax thereon is \$ 46,253.72; that the same became delinquent on the first Monday in June, 2002, to wit:

On the 9th day of May, 2002, that notice of delinquency was duly advertised according to law, and that the above tax, together with penalty and costs of advertising, remained unpaid on the first Monday in June, to-wit: the 3rd day of June, 2002.

That under and by virtue of the provisions of Chapter 361.565, as amended, I, Kathy C. Hiatt, as Treasurer and Tax Receiver of said County, executed this Tax Certificate authorizing the County Treasurer, as Trustee for the State and County, to hold the property described herein for a period of two (2) years after date hereof. The property which is hereinafter described is held subject to redemption within two (2) years from date hereof, by payment of said taxes and accruing taxes, penalties and costs together with interest at the rate of 10% (ten percent) per annum from date due until paid as provided by law, such redemption to be made in accordance with provisions of the Civil Practice Act of this state in regard to real property, sold under execution.

The property held under this certificate is more particularly described as follows:

SEE ATTACHED LISTS

APN	NAME	TAX	PENALTY	ADV/REC	TOTAL DUE
APN 02-221-03	ADAMSON, CHADLEY STORY & EVELYN	\$170.37	\$27.00	\$16.00	\$213.37
APN 02-221-04	ADAMSON, STEVEN & EVELYN	\$887.28	\$140.50	\$16.00	\$1,043.78
APN 03-143-12	BARNETT, GARY V. & VERDA	\$543.64	\$42.58	\$16.00	\$602.22
APN 03-091-16	BART, JOHN A.	\$280.29	\$44.42	\$16.00	\$340.71
APN 02-091-05	BELINGHERI, JOHN & LAURA M.	\$197.65	\$9.56	\$16.00	\$223.21
APN 01-331-02	BENKINSKIS, GEORGE	\$265.44	\$44.00	\$16.00	\$325.44
APN 01-072-08	BENDINSKIS, GEORGE J	\$290.13	\$45.96	\$16.00	\$352.09
APN 03-012-02	BLACKMORE, ARTHUR	\$276.30	\$43.77	\$16.00	\$336.07
APN 03-022-01	BLACKMORE, ARTHUR	\$2,101.41	\$332.74	\$16.00	\$2,450.15
APN 03-061-01	BLACKMORE, ARTHUR	\$982.82	\$155.64	\$16.00	\$1,154.46
APN 13-030-47	BRADLEY, RONALD & GORDENA TRUST	\$73.92	\$5.80	\$16.00	\$95.72
APN 13-030-44	BRADLEY, WAYNE & GORDENA TRUST	\$69.60	\$5.45	\$16.00	\$91.05
APN 13-030-45	BRADLEY, WAYNE & GORDENA TRUST	\$85.20	\$6.67	\$16.00	\$107.87
APN 13-030-46	BRADLEY, WAYNE & GORDENA TRUST	\$65.84	\$5.16	\$16.00	\$87.00
APN 03-077-14	BROWN, ANNA	\$254.08	\$40.26	\$16.00	\$310.34
APN 14-070-07	BROWN, ANNA MAE	\$112.23	\$17.79	\$16.00	\$146.02
APN 13-170-39	BUCK, FRANKLIN J	\$524.05	\$83.00	\$16.00	\$623.05
APN 12-170-30	BULLOCH, BOYD & PATRICIA	\$17.50	\$4.01	\$16.00	\$37.51
APN 12-210-04	BULLOCH, BOYD & PATRICIA	\$4.24	\$0.97	\$16.00	\$21.21
APN 12-210-21	BULLOCH, BOYD & PATRICIA	\$9.08	\$2.07	\$16.00	\$27.15
APN 02-142-05	BULLOCH, BOYD C & PATRICIA	\$605.00	\$95.82	\$16.00	\$716.82
APN 02-142-06	BULLOCH, BOYD C & PATRICIA	\$84.80	\$19.37	\$16.00	\$120.17
APN 02-141-01	BULLOCH, BOYD C. & PATRICIA	\$2.81	\$0.64	\$16.00	\$19.45
APN 12-170-10	BULLOCH, BOYD C. & PATRICIA	\$0.67	\$0.16	\$16.00	\$16.83
APN 12-170-19	BULLOCH, BOYD C. & PATRICIA	\$139.38	\$22.10	\$16.00	\$177.48
APN 12-170-20	BULLOCH, BOYD C. & PATRICIA	\$189.81	\$30.08	\$16.00	\$235.89
APN 13-030-23	CALABRESE, M FRANKLIN & DELLORAH	\$66.18	\$5.18	\$16.00	\$87.36
APN 04-121-01	CANNING, GORDON & SUSAN	\$359.86	\$28.19	\$16.00	\$404.05
APN 11-110-21	CHAMBERLAIN, ALAN & YVONNE	\$601.51	\$95.26	\$16.00	\$712.77
APN 01-191-33	CHAVIS, MARGIE	\$1,199.28	\$189.90	\$16.00	\$1,405.18
APN 04-132-02	CHEENEY, LAWRENCE L. & EVERLY J	\$328.56	\$37.78	\$16.00	\$382.34
APN 03-171-06	CLARK, LEWIS E & MAUD L	\$99.15	\$4.80	\$16.00	\$119.95
APN 02-031-07	COLLET R.J & JUNE	\$156.32	\$7.55	\$16.00	\$179.87
APN 03-171-07	COTTRELL, TED	\$260.95	\$41.34	\$16.00	\$318.29
APN 02-072-06	CRAGER, ROBERT SCOTT	\$372.08	\$40.30	\$16.00	\$428.38
APN 10-160-16	DAY, DAVID & BERNADINE	\$667.56	\$140.00	\$16.00	\$823.56
APN 13-150-05	DEBEVC, ROGER & JACQUALINE	\$120.53	\$19.10	\$16.00	\$155.63
APN 10-134-04	DUPUIS, BERNARD P	\$21.51	\$4.92	\$16.00	\$42.43
APN 10-134-13	DUPUIS, BERNARD P.	\$21.51	\$4.92	\$16.00	\$42.43
APN 06-071-01	EISEL, JAMES G	\$277.92	\$44.03	\$16.00	\$337.95
APN 02-073-04	FERGUSON, KAREN HARMON	\$254.93	\$40.39	\$16.00	\$311.32
APN 01-240-50	FERNANDEZ, BILLY F. & TAMI D.	\$241.44	\$32.94	\$16.00	\$290.38
APN 14-010-06	FLASKO, LOUIS FAMILY TRUST	\$319.76	\$25.05	\$16.00	\$360.81
APN 12-200-14	FRANCIS, KATHLEEN	\$300.89	\$47.67	\$16.00	\$364.56
APN 13-042-11	GARRETT, EDWARD LEE	\$48.61	\$2.35	\$16.00	\$66.96
APN 09-011-21	GEMMILL BROTHERS, ET AL	\$14.33	\$3.27	\$16.00	\$33.60
APN 08-291-22	GRASSY KNOLL DEVELOPMENT, LLC	\$621.33	\$98.39	\$16.00	\$735.72
APN 01-074-25	GRATTO, EARL & CALRANELL	\$40.01	\$9.13	\$16.00	\$65.14
APN 04-151-25	GULL, KENNETH & LORI	\$104.47	\$16.56	\$16.00	\$137.03
APN 04-151-43	GULL, KENNETH & LORI	\$969.92	\$153.59	\$16.00	\$1,139.51
APN 04-151-44	GULL, KENNETH & LORI	\$96.01	\$21.92	\$16.00	\$133.93
APN 01-121-06	HARRISON, MICHAEL & MARIE	\$139.20	\$16.01	\$16.00	\$171.21
APN 04-151-29	HESS, ROBERTA A	\$4.66	\$0.28	\$16.00	\$20.94
APN 04-151-33	HESS, ROBERTA A	\$4.66	\$0.28	\$16.00	\$20.94
APN 11-120-07	HI DESERT SPRINGS CORP. LLC	\$556.52	\$98.59	\$16.00	\$671.11
APN 11-120-11	HI DESERT SPRINGS CORP. LLC	\$3,444.38	\$545.38	\$16.00	\$4,005.76
APN 11-120-12	HI DESERT SPRINGS CORP. LLC	\$953.69	\$151.02	\$16.00	\$1,120.71
APN 11-120-13	HI DESERT SPRINGS CORP. LLC	\$1,277.13	\$202.24	\$16.00	\$1,495.37
APN 11-120-14	HI DESERT SPRINGS CORP. LLC	\$2,914.70	\$461.53	\$16.00	\$3,392.23
APN 11-210-01	HIGBEE, E. EDWIN JR. & RICHARD	\$355.33	\$134.44	\$16.00	\$505.77
APN 09-011-22	HOLLINGSHEAD, PATSY W	\$365.68	\$57.92	\$16.00	\$439.60
APN 12-180-16	HOLLINGSWORTH, MILTON & PACITA	\$282.04	\$22.09	\$16.00	\$320.13
APN 12-110-24	HORLACHER, RONALD H & AUDREY G	\$55.94	\$12.79	\$16.00	\$84.73
APN 02-073-21	HULSE, ERNEST & VICKIE	\$135.01	\$21.40	\$16.00	\$172.41
APN 02-181-02	HUNT, DOROTHY R.	\$30.07	\$1.45	\$16.00	\$47.52
APN 01-092-08	JOSEPH, JUDITH A TRUST	\$909.29	\$143.99	\$16.00	\$1,069.28
APN 01-191-23	JOSEPH, JUDITH A.	\$1,022.81	\$161.97	\$16.00	\$1,200.78
APN 01-092-07	JOSEPH, JUDITH TRUST	\$616.12	\$97.57	\$16.00	\$729.69

APN 13-041-28	KINDBERG, JACK W.	\$38.71	\$8.84	\$16.00	\$63.55
APN 02-041-01	LDS CHURCH	\$101.39	\$16.09	\$16.00	\$133.48
APN 02-051-01	LDS CHURCH	\$95.03	\$21.69	\$16.00	\$132.72
APN 02-081-01	LDS CHURCH	\$19.48	\$4.44	\$16.00	\$39.92
APN 02-111-01	LDS CHURCH	\$17.84	\$4.07	\$16.00	\$37.91
APN 02-171-01	LDS CHURCH	\$17.84	\$4.07	\$16.00	\$37.91
APN 02-201-01	LDS CHURCH	\$16.90	\$3.86	\$16.00	\$36.76
APN 04-141-47	LEAVITT, JAMES D & JESSIE L	\$175.88	\$20.17	\$16.00	\$212.05
APN 11-200-31	LEAVITT, LANE & HEIDE	\$25.08	\$1.21	\$16.00	\$42.29
APN 01-063-05	LESICKA, LELAND R & TONI L	\$27.78	\$5.23	\$16.00	\$49.01
APN 11-220-10	MASON, TIM & YVONNE	\$298.86	\$47.34	\$16.00	\$362.20
APN 11-220-11	MASON, TIMOTHY & YVONNE	\$116.46	\$18.46	\$16.00	\$150.92
APN 04-161-08	MASON, TIMOTHY B & YVONNE S	\$60.87	\$13.89	\$16.00	\$90.76
APN 04-042-10	MASON, TIMOTHY B. ET AL	\$180.94	\$28.68	\$16.00	\$225.62
APN 13-190-09	MCGILL, NANCY & MICHAEL S	\$80.96	\$6.34	\$16.00	\$103.30
APN 08-291-21	METAL CRAFT TRAILERS	\$66.62	\$15.21	\$16.00	\$97.83
APN 13-090-06	MINNIEAR, ARDIL L. & ARDIL L	\$143.02	\$22.67	\$16.00	\$181.69
APN 03-182-12	MOFFIT, RAY B	\$180.99	\$20.81	\$16.00	\$217.80
APN 03-088-05	MOSSER, DEAN A	\$398.61	\$63.13	\$16.00	\$477.74
APN 03-131-07	MOSSER, DEAN A	\$256.89	\$40.70	\$16.00	\$313.59
APN 06-361-03	MOSSER, DEAN A	\$181.78	\$28.79	\$16.00	\$226.57
APN 13-160-01	OESTERLE, BILL & HANSEN, SHIRLEY	\$10.00	\$0.48	\$16.00	\$26.48
APN 13-180-01	OESTERLE, BILL & HANSEN, SHIRLEY	\$10.00	\$0.48	\$16.00	\$26.48
APN 03-077-24	OESTERLE, BILL & HANSEN, SHIRLEY	\$574.82	\$33.64	\$16.00	\$624.46
APN 12-170-22	PEREZ, COLECTO & CARMELIA	\$227.35	\$36.00	\$16.00	\$279.35
APN 01-341-20	PORTER, FRANK C JR & SANDRA L	\$183.90	\$29.14	\$16.00	\$229.04
APN 01-341-21	PORTER, FRANK C JR & SANDRA L	\$197.22	\$31.25	\$16.00	\$244.47
APN 01-341-26	PORTER, FRANK C JR & SANDRA L	\$201.16	\$31.88	\$16.00	\$249.04
APN 01-341-27	PORTER, FRANK C JR & SANDRA L	\$199.60	\$31.63	\$16.00	\$247.23
APN 08-061-11	POULSEN, MARK G & SUZANNE G	\$92.37	\$21.09	\$16.00	\$129.46
APN 01-250-11	ROBINSON, ANDREW T	\$142.74	\$16.41	\$16.00	\$175.15
APN 02-102-18	SCHIEFER, JOHN & ZELMA TRUST	\$175.76	\$27.84	\$16.00	\$219.60
APN 01-103-03	SCHNEPF, FREDERICK & MARY TRUST	\$147.43	\$23.68	\$16.00	\$187.11
APN 03-201-06	SCHWEYER, PETER & ROBIN	\$15.29	\$3.49	\$16.00	\$34.78
APN 03-201-07	SCHWEYER, PETER & ROBIN	\$49.16	\$11.23	\$16.00	\$76.39
APN 03-184-01	SHEARER, GLORIA & DONALD	\$103.83	\$11.16	\$16.00	\$130.99
APN 03-073-05	SKAGGS, ANDREW & BETH	\$105.94	\$16.80	\$16.00	\$138.74
APN 11-180-20	SPENCER, ISAAC 5. & JUDITH A	\$32.91	\$3.55	\$16.00	\$52.46
APN 13-041-01	STEVENS, FRANK & PATRICIA	\$141.68	\$22.46	\$16.00	\$180.14
APN 13-041-02	STEVENS, FRANK & PATRICIA	\$506.82	\$80.27	\$16.00	\$603.09
APN 13-041-06	STEVENS, FRANK & PATRICIA	\$98.49	\$22.48	\$16.00	\$136.97
APN 13-041-20	STEVENS, FRANK & PATRICIA	\$98.49	\$22.48	\$16.00	\$136.97
APN 04-041-27	STEWART, CHARLES JR	\$729.66	\$115.56	\$16.00	\$861.22
APN 08-360-11	STEWART, LEO K & DELORES E	\$2,210.83	\$350.07	\$16.00	\$2,576.90
APN 08-360-12	STEWART, LEO K. & DELORES	\$686.45	\$108.70	\$16.00	\$811.15
APN 10-123-04	TORSON INDUSTRIES INC	\$11.46	\$2.62	\$16.00	\$30.08
APN 10-123-05	TORSON INDUSTRIES INC	\$11.46	\$2.62	\$16.00	\$30.08
APN 10-082-01	TORSON INDUSTRIES INC	\$53.52	\$12.23	\$16.00	\$81.75
APN 10-122-09	TORSON INDUSTRIES INC	\$9.77	\$2.23	\$16.00	\$28.00
APN 10-122-13	TORSON INDUSTRIES INC	\$11.23	\$2.56	\$16.00	\$29.79
APN 10-122-15	TORSON INDUSTRIES INC	\$11.23	\$2.56	\$16.00	\$29.79
APN 10-123-06	TORSON INDUSTRIES INC	\$11.46	\$2.62	\$16.00	\$30.08
APN 10-123-07	TORSON INDUSTRIES INC	\$11.46	\$2.62	\$16.00	\$30.08
APN 10-131-01	TORSON INDUSTRIES INC	\$9.77	\$2.23	\$16.00	\$28.00
APN 10-131-02	TORSON INDUSTRIES INC	\$10.75	\$2.46	\$16.00	\$29.21
APN 10-131-03	TORSON INDUSTRIES INC	\$10.75	\$2.46	\$16.00	\$29.21
APN 10-131-07	TORSON INDUSTRIES INC	\$10.75	\$2.46	\$16.00	\$29.21
APN 10-131-08	TORSON INDUSTRIES INC	\$9.77	\$2.23	\$16.00	\$28.00
APN 10-131-12	TORSON INDUSTRIES INC	\$10.75	\$2.46	\$16.00	\$29.21
APN 10-131-14	TORSON INDUSTRIES INC	\$10.75	\$2.46	\$16.00	\$29.21
APN 10-131-15	TORSON INDUSTRIES INC	\$10.75	\$2.46	\$16.00	\$29.21
APN 10-131-16	TORSON INDUSTRIES INC	\$9.77	\$2.23	\$16.00	\$28.00
APN 10-132-01	TORSON INDUSTRIES INC	\$9.77	\$2.23	\$16.00	\$28.00
APN 10-132-02	TORSON INDUSTRIES INC	\$10.75	\$2.46	\$16.00	\$29.21
APN 10-132-03	TORSON INDUSTRIES INC	\$10.75	\$2.46	\$16.00	\$29.21
APN 10-132-05	TORSON INDUSTRIES INC	\$10.75	\$2.46	\$16.00	\$29.21
APN 10-132-06	TORSON INDUSTRIES INC	\$10.75	\$2.46	\$16.00	\$29.21
APN 10-132-08	TORSON INDUSTRIES INC	\$9.77	\$2.23	\$16.00	\$28.00
APN 10-132-09	TORSON INDUSTRIES INC	\$9.77	\$2.23	\$16.00	\$28.00

APN 10-132-10	TORESON INDUSTRIES INC	\$10.75	\$2.46	\$16.00	\$29.21
APN 10-132-11	TORESON INDUSTRIES INC	\$10.75	\$2.46	\$16.00	\$29.21
APN 10-132-12	TORESON INDUSTRIES INC	\$10.75	\$2.46	\$16.00	\$29.21
APN 10-132-14	TORESON INDUSTRIES INC	\$10.75	\$2.46	\$16.00	\$29.21
APN 10-132-15	TORESON INDUSTRIES INC	\$10.75	\$2.46	\$16.00	\$29.21
APN 10-132-16	TORESON INDUSTRIES INC	\$9.77	\$2.23	\$16.00	\$28.00
APN 10-134-08	TORESON INDUSTRIES INC	\$9.77	\$2.23	\$16.00	\$28.00
APN 10-134-10	TORESON INDUSTRIES INC	\$10.75	\$2.46	\$16.00	\$29.21
APN 10-134-12	TORESON INDUSTRIES INC	\$10.75	\$2.46	\$16.00	\$29.21
APN 10-134-14	TORESON INDUSTRIES INC	\$10.75	\$2.46	\$16.00	\$29.21
APN 10-042-04	TORESON INDUSTRIES INC	\$24.17	\$5.52	\$16.00	\$45.69
APN 10-042-05	TORESON INDUSTRIES INC	\$22.73	\$5.19	\$16.00	\$43.92
APN 10-046-03	TORESON INDUSTRIES INC	\$4.89	\$1.11	\$16.00	\$22.00
APN 10-051-01	TORESON INDUSTRIES INC	\$33.98	\$7.76	\$16.00	\$57.74
APN 10-081-01	TORESON INDUSTRIES INC	\$53.52	\$12.23	\$16.00	\$81.75
APN 10-083-01	TORESON INDUSTRIES INC	\$53.52	\$12.23	\$16.00	\$81.75
APN 10-084-01	TORESON INDUSTRIES INC	\$53.52	\$12.23	\$16.00	\$81.75
APN 10-092-01	TORESON INDUSTRIES INC	\$76.95	\$17.58	\$16.00	\$110.53
APN 10-093-01	TORESON INDUSTRIES INC	\$76.95	\$17.58	\$16.00	\$110.53
APN 10-094-01	TORESON INDUSTRIES INC	\$76.50	\$17.48	\$16.00	\$109.98
APN 10-101-01	TORESON INDUSTRIES INC	\$76.71	\$17.52	\$16.00	\$110.23
APN 10-102-01	TORESON INDUSTRIES INC	\$76.71	\$17.52	\$16.00	\$110.23
APN 10-103-01	TORESON INDUSTRIES INC	\$76.71	\$17.52	\$16.00	\$110.23
APN 10-104-01	TORESON INDUSTRIES INC	\$77.21	\$17.62	\$16.00	\$110.83
APN 10-111-04	TORESON INDUSTRIES INC	\$11.98	\$2.74	\$16.00	\$30.72
APN 10-116-04	TORESON INDUSTRIES INC	\$11.46	\$2.62	\$16.00	\$30.08
APN 10-118-01	TORESON INDUSTRIES INC	\$82.10	\$18.75	\$16.00	\$116.85
APN 10-122-02	TORESON INDUSTRIES INC	\$25.14	\$5.75	\$16.00	\$46.89
APN 10-124-11	TORESON INDUSTRIES INC	\$10.75	\$2.46	\$16.00	\$29.21
APN 10-041-01	TORESON INDUSTRIES INC	\$34.70	\$7.93	\$16.00	\$58.63
APN 10-043-01	TORESON INDUSTRIES INC	\$61.13	\$13.97	\$16.00	\$91.10
APN 10-044-01	TORESON INDUSTRIES INC	\$61.13	\$13.97	\$16.00	\$91.10
APN 10-045-01	TORESON INDUSTRIES INC	\$61.13	\$13.97	\$16.00	\$91.10
APN 10-046-02	TORESON INDUSTRIES INC	\$57.89	\$13.21	\$16.00	\$87.10
APN 10-047-01	TORESON INDUSTRIES INC	\$61.13	\$13.97	\$16.00	\$91.10
APN 10-048-01	TORESON INDUSTRIES INC	\$61.13	\$13.97	\$16.00	\$91.10
APN 10-049-01	TORESON INDUSTRIES INC	\$61.13	\$13.97	\$16.00	\$91.10
APN 10-052-01	TORESON INDUSTRIES INC	\$24.94	\$5.71	\$16.00	\$46.65
APN 10-053-01	TORESON INDUSTRIES INC	\$60.33	\$13.77	\$16.00	\$90.10
APN 10-054-01	TORESON INDUSTRIES INC	\$67.09	\$15.32	\$16.00	\$98.41
APN 10-055-01	TORESON INDUSTRIES INC	\$60.33	\$13.77	\$16.00	\$90.10
APN 10-056-01	TORESON INDUSTRIES INC	\$60.33	\$13.77	\$16.00	\$90.10
APN 10-057-01	TORESON INDUSTRIES INC	\$60.33	\$13.77	\$16.00	\$90.10
APN 10-058-01	TORESON INDUSTRIES INC	\$60.33	\$13.77	\$16.00	\$90.10
APN 10-059-01	TORESON INDUSTRIES INC	\$60.33	\$13.77	\$16.00	\$90.10
APN 10-061-01	TORESON INDUSTRIES INC	\$68.42	\$15.63	\$16.00	\$100.05
APN 10-062-01	TORESON INDUSTRIES INC	\$42.01	\$9.59	\$16.00	\$67.60
APN 10-063-01	TORESON INDUSTRIES INC	\$46.92	\$10.72	\$16.00	\$73.64
APN 10-065-01	TORESON INDUSTRIES INC	\$46.92	\$10.72	\$16.00	\$73.64
APN 10-065-01	TORESON INDUSTRIES INC	\$46.92	\$10.72	\$16.00	\$73.64
APN 10-066-01	TORESON INDUSTRIES INC	\$46.92	\$10.72	\$16.00	\$73.64
APN 10-067-01	TORESON INDUSTRIES INC	\$46.92	\$10.72	\$16.00	\$73.64
APN 10-068-01	TORESON INDUSTRIES INC	\$46.92	\$10.72	\$16.00	\$73.64
APN 10-071-01	TORESON INDUSTRIES INC	\$90.89	\$20.75	\$16.00	\$127.64
APN 10-072-01	TORESON INDUSTRIES INC	\$47.67	\$10.89	\$16.00	\$74.56
APN 10-073-01	TORESON INDUSTRIES INC	\$47.67	\$10.89	\$16.00	\$74.56
APN 10-074-01	TORESON INDUSTRIES INC	\$47.67	\$10.89	\$16.00	\$74.56
APN 10-075-01	TORESON INDUSTRIES INC	\$47.67	\$10.89	\$16.00	\$74.56
APN 10-076-01	TORESON INDUSTRIES INC	\$47.67	\$10.89	\$16.00	\$74.56
APN 10-077-01	TORESON INDUSTRIES INC	\$47.67	\$10.89	\$16.00	\$74.56
APN 10-091-01	TORESON INDUSTRIES INC	\$76.95	\$17.58	\$16.00	\$110.53
APN 10-112-01	TORESON INDUSTRIES INC	\$109.97	\$17.44	\$16.00	\$143.41
APN 10-113-01	TORESON INDUSTRIES INC	\$112.92	\$17.90	\$16.00	\$146.82
APN 10-114-03	TORESON INDUSTRIES INC	\$105.81	\$16.78	\$16.00	\$138.59
APN 10-115-01	TORESON INDUSTRIES INC	\$77.21	\$17.62	\$16.00	\$110.83
APN 10-116-03	TORESON INDUSTRIES INC	\$71.82	\$16.40	\$16.00	\$104.22
APN 10-117-01	TORESON INDUSTRIES INC	\$82.10	\$18.75	\$16.00	\$116.85
APN 10-121-01	TORESON INDUSTRIES INC	\$110.68	\$17.54	\$16.00	\$144.22
APN 10-122-01	TORESON INDUSTRIES INC	\$9.77	\$2.23	\$16.00	\$28.00



APN 10-122-03	TORESON INDUSTRIES INC	\$11.23	\$2.56	\$16.00	\$29.79
APN 10-122-04	TORESON INDUSTRIES INC	\$11.23	\$2.56	\$16.00	\$29.79
APN 10-122-05	TORESON INDUSTRIES INC	\$11.23	\$2.56	\$16.00	\$29.79
APN 10-122-06	TORESON INDUSTRIES INC	\$11.23	\$2.56	\$16.00	\$29.79
APN 10-122-07	TORESON INDUSTRIES INC	\$11.23	\$2.56	\$16.00	\$29.79
APN 10-122-08	TORESON INDUSTRIES INC	\$9.77	\$2.23	\$16.00	\$28.00
APN 10-122-10	TORESON INDUSTRIES INC	\$10.75	\$2.46	\$16.00	\$29.21
APN 10-122-11	TORESON INDUSTRIES INC	\$10.75	\$2.46	\$16.00	\$29.21
APN 10-122-12	TORESON INDUSTRIES INC	\$10.75	\$2.46	\$16.00	\$29.21
APN 10-122-16	TORESON INDUSTRIES INC	\$9.55	\$2.18	\$16.00	\$27.73
APN 10-123-01	TORESON INDUSTRIES INC	\$9.77	\$2.23	\$16.00	\$28.00
APN 10-123-03	TORESON INDUSTRIES INC	\$11.46	\$2.62	\$16.00	\$30.08
APN 10-123-10	TORESON INDUSTRIES INC	\$11.46	\$2.62	\$16.00	\$30.08
APN 10-123-11	TORESON INDUSTRIES INC	\$11.46	\$2.62	\$16.00	\$30.08
APN 10-123-12	TORESON INDUSTRIES INC	\$11.46	\$2.62	\$16.00	\$30.08
APN 10-123-13	TORESON INDUSTRIES INC	\$11.46	\$2.62	\$16.00	\$30.08
APN 10-123-15	TORESON INDUSTRIES INC	\$11.46	\$2.62	\$16.00	\$30.08
APN 10-123-16	TORESON INDUSTRIES INC	\$9.77	\$2.23	\$16.00	\$28.00
APN 10-124-01	TORESON INDUSTRIES INC	\$9.77	\$2.23	\$16.00	\$28.00
APN 10-124-09	TORESON INDUSTRIES INC	\$9.77	\$2.23	\$16.00	\$28.00
APN 10-124-12	TORESON INDUSTRIES INC	\$10.75	\$2.46	\$16.00	\$29.21
APN 10-124-13	TORESON INDUSTRIES INC	\$11.46	\$2.62	\$16.00	\$30.08
APN 10-124-14	TORESON INDUSTRIES INC	\$11.46	\$2.62	\$16.00	\$30.08
APN 10-124-16	TORESON INDUSTRIES INC	\$9.77	\$2.23	\$16.00	\$28.00
APN 10-131-04	TORESON INDUSTRIES INC	\$10.75	\$2.46	\$16.00	\$29.21
APN 10-131-05	TORESON INDUSTRIES INC	\$10.75	\$2.46	\$16.00	\$29.21
APN 10-132-07	TORESON INDUSTRIES INC	\$10.75	\$2.46	\$16.00	\$29.21
APN 10-133-01	TORESON INDUSTRIES INC	\$108.98	\$17.28	\$16.00	\$142.26
APN 10-134-01	TORESON INDUSTRIES INC	\$9.77	\$2.23	\$16.00	\$28.00
APN 10-134-05	TORESON INDUSTRIES INC	\$10.75	\$2.46	\$16.00	\$29.21
APN 10-134-06	TORESON INDUSTRIES INC	\$10.75	\$2.46	\$16.00	\$29.21
APN 10-134-09	TORESON INDUSTRIES INC	\$9.77	\$2.23	\$16.00	\$28.00
APN 10-134-11	TORESON INDUSTRIES INC	\$10.75	\$2.46	\$16.00	\$29.21
APN 10-134-16	TORESON INDUSTRIES INC	\$9.77	\$2.23	\$16.00	\$28.00
APN 08-291-02	TURLEY, LUTHER DEAN & KIMBERLY	\$45.63	\$2.21	\$16.00	\$63.84
APN 10-122-14	VAN NORMAN, ROBERT	\$27.97	\$6.39	\$16.00	\$50.36
APN 10-141-01	VERZANI, GEORGE E	\$65.22	\$14.89	\$16.00	\$96.11
APN 10-142-01	VERZANI, GEORGE E	\$65.22	\$14.89	\$16.00	\$96.11
APN 10-143-01	VERZANI, GEORGE E	\$65.22	\$14.89	\$16.00	\$96.11
APN 10-144-01	VERZANI, GEORGE E	\$69.13	\$15.80	\$16.00	\$100.93
APN 10-151-01	VERZANI, GEORGE E	\$65.22	\$14.89	\$16.00	\$96.11
APN 10-152-01	VERZANI, GEORGE E	\$64.52	\$14.74	\$16.00	\$95.26
APN 10-153-01	VERZANI, GEORGE E	\$65.22	\$14.89	\$16.00	\$96.11
APN 10-154-01	VERZANI, GEORGE E	\$68.91	\$15.73	\$16.00	\$100.64
APN 10-124-05	VJA INVESTMENTS (2/3) ET AL	\$23.93	\$5.48	\$16.00	\$45.41
APN 11-080-08	WADSWORTH, LAMONT & ANNETTE	\$249.21	\$28.66	\$16.00	\$293.87
APN 11-160-16	WADSWORTH, LAMONT ET AL	\$797.58	\$38.55	\$16.00	\$852.13
APN 01-065-25	WASHBURN, VELL & ELLAMAE	\$70.43	\$16.09	\$16.00	\$102.52
APN 10-162-12	WESTCOTT, DOUGLAS J & PAMELA J	\$235.04	\$37.24	\$16.00	\$288.28
APN 12-170-02	WILKIN, JOSEPH D & SUSANNE C	\$286.22	\$13.84	\$16.00	\$316.06
APN 01-034-02	WILKIN, JOSEPH D.	\$29.40	\$1.42	\$16.00	\$46.82
APN 01-035-08	WILKIN, JOSEPH D.	\$30.42	\$1.47	\$16.00	\$47.89
APN 06-041-11	WILKIN, MARGARET C.	\$399.57	\$63.30	\$16.00	\$478.87
APN 02-270-02	WILKIN, SUSANNE TRUST	\$43.61	\$2.10	\$16.00	\$61.71
APN 02-270-04	WILKIN, SUSANNE TRUST	\$37.93	\$1.84	\$16.00	\$55.77
APN 01-057-10	WILSON, MARK & MARY	\$436.74	\$69.18	\$16.00	\$521.92
APN 03-181-06	WISHART, REBA L.	\$8.27	\$1.12	\$16.00	\$25.39
APN 04-071-11	WOOD, GARY A & CHARLOTTE S	\$47.34	\$3.30	\$16.00	\$66.64
APN 04-071-20	WOOD, GARY A & CHARLOTTE S	\$2.58	\$10.75	\$16.00	\$29.33
APN 03-131-17	YOUNG, MELINDA	\$201.05	\$12.01	\$16.00	\$229.06
APN 03-121-34	YOUNG, RONAL T. TRUST	\$212.91	\$33.73	\$16.00	\$262.64
		\$46,253.72	\$7,313.82	\$4,272.00	\$57,839.54

APN 02-221-03 Adamson, Chadley Story & Evelyn  
East ½ Lot 4 in Block 48, Trailer Hookup, Concrete & Sheds, Panaca Town

APN 02-221-04 Adamson, Steven & Evelyn  
West ½ Lot 4 in Block 48, House, Porches, CFW, Sheds, Pens & Fence, Panaca Town

APN 03-143-12 Barnett, Gary V. & Verda  
Lot 17 in Block A West End Addition, House, Porch, CFW & Fence, Caliente City

APN 03-091-16 Bart, John A.  
Lot 14 in Lincoln Park Subdivision, House, Porch, CFW, Shed & Fence, Caliente City

APN 02-091-05 Belingheri, John & Laura Marie  
Part of Lots 2 & 3 in Block 37, Residence, Greenhouse, Porches, BBQ, Workshop & Fence,  
Panaca Town

APN 01-331-02 Bendinskis, George  
20 Acres in N1/2NW1/4SE1/4 Section 10 T1N R67E, Various Sheds, Corrals & Pens,  
Pioche Town

APN 01-072-08 Bendinskis, George J.  
Lots 11, 12 & 13 in Block 35, Hotel Building, Porches & Shed, Pioche Town

APN 03-012-02 Blackmore, Arthur  
6.71 Acres in NW1/4SW1/4 Section 5 T4S R67E, Caliente City

APN 03-022-01 Blackmore, Arthur  
22.06 Acres in SE1/4SW1/4 Section 5 T4S R67E, Bathhouse, New Apartment, Pump House,  
Swimming Pool, Small Apartment, Auto Court & Units, 2 MH Hookups, 2-Story Apartment,  
Caliente City

APN 03-061-01 Blackmore, Arthur  
4 Acre Parcel of land at Caliente Hot Springs in NE of NE1/4 Section 8 T4S R67E, Caliente City

APN 13-030-47 Bradley, Wayne: Bradley, Ronald A. & Gordena S. Trustees of the  
Ronald A. & Gordena S. Bradley Family Trust  
16.74 Acres. Parcel 4 of Ken Price Map B/336

APN 13-030-44 Bradley, Wayne: Bradley, Ronald A. & Gordena S. Trustees of the  
Ronald A. & Gordena S. Bradley Family Trust  
21.16 Acres. Parcel 1 of Ken Price Map B/336, Section 2 T3S R67E

APN 13-030-45 Bradley, Wayne: Bradley, Ronald A. & Gordena S. Trustees of the  
Ronald A. & Gordena S. Bradley Family Trust  
19.29 Acres. Parcel 2 of Ken Price Map B/336

APN 13-030-46 Bradley, Wayne: Bradley, Ronald A. & Gordena S. Trustees of the  
Ronald A. & Gordena S. Bradley Family Trust  
20.01 Acres. Parcel 3 of Ken Price Map B/336

APN 03-077-14 Brown, Anna M.

Lot 11 in Block 1, House, Improvements, Garage & Fence, Caliente City

APN 14-070-07 Brown, Anna Mae

3.6 Acres. Parcel #3 of the Ronald Cannon Parcel Map Plat A-1, page 276, in Section 16 T5S R69E, Water System & WOP with steps

APN 13-170-39 Buck, Franklin J.

10 Acres in SE1/4SW1/4SE1/4 Section 14 T3S R67E. Storage Sheds, Barbed Wire Fence, Well & Septic System, MH Addition, Trailer Hookup, Well Shed, Cabin & Porches, 2 Trailer Hookups, 2 Septic Systems, 2 Water Systems & Personal Property (MH27-780-515)

APN 12-170-30 Bulloch, Boyd & Patricia

10.75 Acres in N1/2NW1/4SE1/4 Section 8 T2S R68E

APN 12-210-04 Bulloch, Boyd & Patricia

75 Acres in SW1/4NE1/4; in SE1/4NW1/4 Section 20 T2S R68E

APN 12-210-21 Bulloch, Boyd & Patricia

140 Acres. NE1/4SW1/4; W1/2SE1/4; N1/2NE1/4SE1/4 Section 20 T2S R68E

APN 02-142-05 Bulloch, Boyd C & Patricia

2.673 Acres. Parcel 3 of the Boyd C. & Patricia Bulloch Parcel Map Book A, page 390, Portion of Lots 1, 2, 3, & 4 in Block 6, House, CFW, Porches, Cellar, Fence, Shed, Storage Building, Panaca Town

APN 02-142-06 Bulloch, Boyd C & Patricia

.800 Acre. Parcel #2 of the Boyd C. & Patricia Bulloch Parcel Map Book A, page 390, South 1/2 Lot 4 in Block 6, Panaca Town

APN 02-141-01 Bulloch, Boyd C. & Patricia

1.19 Acre Pasture Lots lying West of Lots 1 & 4 in Block 6 and being a fractional block, Panaca Town

APN 12-170-10 Bulloch, Boyd C. & Patricia

20' Sq. in Section 8 T2S R68E

APN 12-170-19 Bulloch, Boyd C. & Patricia

18 Acres in S1/2SW1/4NE1/4 Section 8 T2S R68E

APN 12-170-20 Bulloch, Boyd C. & Patricia

18.5 Acres in S1/2SE1/4NW1/4 Section 8 T2S R68E

APN 13-030-23 Calabrese, M. Franklin & Dellorah

6 Acres in SW Corner of NE1/4 & in NW Corner of SE1/4 Section 2 T3S R67E

APN 04-121-01 Canning, Gordon & Susan

Lot 41 in Alamo South Subdivision Unit 2 Tract 1, House, Garage, Fence & CFW, Alamo Town

APN 11-110-21 Chamberlain, Alan K. & Yvonne  
6.498 Acres. Parcel 1 of the Alan K. & Yvonne Chamberlain Parcel Map Recorded in Book 101,  
page 250, of Lincoln County Records, Metal Building & CFW

APN 01-191-33 Chavis, Margie  
.58 Acre. Parcel 2 of the Vaughn & Donna Phillips Parcel Map Book A. page 227, House,  
Garage, Porches & Wood Decking, Pioche Town

APN 04-132-02 Cheeney, Lawrence L. & Beverly J.  
Lot 17 in Alamo South Subdivision, Unit 1, Tract 1, House, Carport, Fence, CFW & Shed, Alamo  
Town

APN 03-171-06 Clark, Lewis E. & Maud L.  
Lot 23 in Rowan Subdivision, Fence, Trailer Hookup, Enclosed Porch, CFW, Patio, Addition, &  
Personal Property (MH362), Caliente City

APN 02-031-07 Collet, R. J. & June  
Portion of Lot 3 in Block 22, House, Garage, Porches, CFW, Shed, Fence & Enclosed Porch,  
Panaca Town

APN 03-171-07 Cottrell, Ted Earle  
Lot 22 in Rowan Subdivision, Fence, Addition, Garage, Porch, Trailer Hookup, Patio, CFW &  
Personal Property (MH370), Caliente City

APN 02-072-06 Crager, Robert Scott  
Lot 108 in Sun Gold Manor, Manufactured Home, Panaca Town

APN 10-160-16 Day, David & Bernadine  
4.90 Acres. Parcel 1 of the David & Bernadine Day Parcel Map Recorded in File #111966 of  
Lincoln County Records, Trailer Hookup, Storage Shed, Wooden Storage Shed, Corrals & Pens,  
Culinary Water & Septic System, Garage, CFW, Apartment & Washroom, Trailer Addition,  
Metal Porch with Railing, Metal Gate Entrance Way & Personal Property (MH1005)

APN 13-150-05 Debevc, Roger & Jacqualine  
5.45 Acres. Parcel 3 of the Indian Ridge Parcel Map Recorded by Bill Oesterle & Shirlee Hansen  
Recorded in Book A, page 484B

APN 10-134-04 Dupuis, Bernard P.  
2.34 Acre. Lot 13 in Block 7, Lincoln Estates

APN 10-134-13 Dupuis, Bernard P.  
2.34 Acre. Lot 5 in Block 7, Lincoln Estates

APN 06-071-01 Eisel, James G.  
4 Acres more or less in the SE Corner of NE1/4SW1/4 Section 32 T3N R70E, Well & Personal  
Property (MH1053-1054)



APN 02-073-04 Ferguson, Karen Harmon  
Lot 128 in Sun Gold Manor Addition, Trailer Hookup, Addition, Porch, Patio Cover, Fence & Personal Property (MH457), Panaca Town

APN 01-240-50 Fernandez, Billy F. & Tami D. (2000-2001: Escobedo, Nancy & Witlicki, J.)  
2 Acres in Section 14 T1N R67E, Parcel 1 of the Witlicki Parcel Map Recorded in Book B, page 292, Pioche Town

APN 14-010-06 Flasko Family Limited Trust  
150.26 Acres in W1/2NW1/4; W1/2SW1/4 Section 35 T5S R66E & 7.50 Acres in SE1/4SE1/4SE1/4SE1/4 Section 27 T5S R66E. SW1/4SW1/4SW1/4SW1/4 Section 26 T5S R66E & NE1/4NE1/4NE1/4NE1/4 Section 34 T5S R66E. Storage Shed #1. Storage Shed #2. Corrals. Gasoline Tank. Possessory Interest in the Following Springs: Kane Spring, Kane Springs Reservoir, Wire Grass Spring, Boulder Spring & Pipe Line, Live Oak Spring, Crow Spring, Sunflower Spring, Grapevine Spring, Rock Seep Spring (2/3 Interest) Appl #10346-Cert #2702, Mud Spring (2/3 Interest) Appl. #10062 Cert #3404, Lower Riggs Spring (4/5 Interest) Proof #01022 Cert #26, Willow Springs: 3 Trailer Hookups, Pole Barn & Barn, Metal Corrals, 1 Well System, 3 Septic Systems & Personal Property (MH558-717-776)

APN 12-200-14 Francis, Kathleen  
4.916 Acre Parcel in SE1/4NE1/4 Section 17 T2S R68E, Storage Shed, Open Shed, Metal Corrals, Water Trough, Horse Exerciser, Trailer Hookup, Septic System, Water System & Personal Property

APN 13-042-11 Garrett, Edward Lee  
9.63 Acres. Lots 51 & 52 in Highland Knolls Subdivision

APN 09-011-21 Gemmill, Terry R. Trustee of Gemmil Brothers Trust (1/2 Interest),  
Free, Darel H. (1/4 Interest) & Heidenreich, Eva (1/4 Interest)  
1 Patented Mining Claim in Highland Mining District @ \$500 Each (Survey No. 3887 Hottentot)

APN 08-291-22 Grassy Knoll Development, LLC  
2.70 Acre. Parcel 4 of the Floyd Lamb Parcel Map Recorded in Book B, page 243, of Lincoln County Records, Section 21 T7S R68E, Farmstead #1: Machine Shed, Horse Barn, Porch to Horse Barn, Barn, Corrals, Chute & Squeeze, 2 Trailer Hookups, Water & Septic System, Equipment Shed & Flatwork, Cattle Scale & Shed, Walk-in Box, Fuel Tanks, Horse Barn, Tack Room, Corrals & Gates, Horse Exerciser (4 Horse), & Personal Property (MH311-312)

APN 01-074-25 Gratto, Earl & Clara Nell  
Lot 24 in Block 34, Pioche Town

APN 04-151-25 Gull, Kenneth & Lori  
.5 Acre. Parcel 16-2 of Darrel Wilson Parcel Map Book A-1, page 279, Alamo Town

APN 04-151-43 Gull, Kenneth & Lori  
.46 Acre. Parcel 16-4, Lot #1 in Section 5 T7S R61E, Trailer Hookup, CCP, CFN, Shed, Detached Garage & Personal Property (MH889), Alamo Town

APN 04-151-44 Gull, Kenneth & Lori  
.46 Acre. Parcel 16-4, Lot 2 in Section 5 T7S R61E, Alamo Town

APN 01-121-06 Harrison, Michael A. & Marie  
West 17' of Lot 18 and all Lot 17 in Block 24. House & Porches, Pioche Town

APN 04-151-29 Hess, Roberta A.  
1.17 Acre. Parcel 8-2 of Gerald Wilson Parcel Map Book A-1, page 280, Alamo Town

APN 04-151-33 Hess, Roberta A.  
1.17 Acre. Parcel 9-2 in S1/2SW1/4NW1/4SW1/4 Section 5 T7S R61E, Alamo Town

APN 11-120-07 Hi Desert Springs Corp. LLC  
.39 Acre. Lot 12 in Ash Springs Subdivision, 2 Trailer Hookups, Porches, Water & Septic System, CFW, Patio (Metal Roof) & Personal Property (MH78-77-76)

APN 11-120-11 Hi Desert Springs Corp. LLC  
6.5 Acres. Lot 3 in NE1/4NE1/4 Section 1 T6S R60E

APN 11-120-12 Hi Desert Springs Corp. LLC  
1.8 Acre in E1/2NE1/4 Section 1 T6S R60E, 58 Acre Feet Water in Pahrangat Lakes & Special Assessment in Ash Springs Irrigation

APN 11-120-13 Hi Desert Springs Corp. LLC  
2.41 Acres in SE1/4NE1/4 Section 1 T6S R60E

APN 11-120-14 Hi Desert Springs Corp. LLC  
5.5 Acres in NE1/4NE1/4 Section 1 T6S R60E

APN 11-210-01 Higbee, E. Edwin Jr. & Richard Earl  
39.54 Acres in N1/2N1/2SW1/4 Section 32

APN 09-011-22 Hollingshead, Patsy W.  
Improvements as assessed by Nevada Department of Taxation, Mill Building, Improvements & Personal Property

APN 12-180-16 Hollingsworth, Milton & Pacita Y.  
9.4 Acres in SE1/4NE1/4 Section 7 T2S R68E. Residence, Septic System, Garage, Porches, Sheds & Fence

Apn 12-110-24 Horlacher, Ronald H. & Audrey G.  
62.33 Acres in N1/2NW1/4; In E1/2NW1/4; In NE1/4SW1/4 Section 5 T2S R68E

APN 02-073-21 Hulse, Ernest & Vickie  
Lot 131 in Sun Gold Manor, Trailer Hookup, Porch, Fence & Personal Property (MH460), Panaca Town

APN 02-181-02 Hunt, Dorothy R.  
E 115' of Lot 1 in Block 27, Garage, CFW & Fence, Panaca Town

APN 01-092-08 Joseph, Judith A., Trustee of The Joseph Living Trust  
Lots 24 & 25 in Block 30, Business Building & CCP, Pioche Town

APN 01-191-23 Joseph, Judith A.  
2.321 Acres in NW1/4NE1/4SE1/4SW1/4 Section 15 T1N R67E, House, Garage, Porches &  
Fence, Pioche Town

APN 01-092-07 Joseph Judith Trust  
Lots 22 & 23 in Block 30, Business Building & Personal Property, Pioche Town

APN 13-041-28 Kindberg, Jack Warren  
1.11 Acre. Parcel #4 of Armstrong Parcel Map in E1/2NE1/4NE1/4 Section 3 T3S R67E

APN 02-041-01 LDS Church  
1.41 Acre. Fractional Block 68, Panaca Town

APN 02-051-01 LDS Church  
1.32 Acre. Fractional Block 69, Panaca Town

APN 02-081-01 LDS Church  
1.23 Acre. Fractional Block 70, Panaca Town

APN 02-111-01 LDS Church  
1.14 Acre. Fractional Block 71, Panaca Town

APN 02-171-01 LDS Church  
1.13 Acre. Fractional Block 73, Panaca Town

APN 02-201-01 LDS Church  
1.07 Acre. Fractional Block 74, Panaca Town

APN 04-141-47 Leavitt, James D. & Jessie L.  
1.35 Acre in Section 5 T7S R61E. Parcel 3-1 of the Mary & Gerald Wilson Parcel Map Recorded  
in Book B, page 274 of the Lincoln County Records, Alamo Town

APN 11-200-31 Leavitt, Lane J. & Heidi L.  
7.36 Acres being a parcel of land in NW1/2 Section 32 T6S R61E, House, Porches, Water &  
Septic System

APN 01-063-05 Lesicka, Leland R. & Toni L.  
All Lot 13 and Portion of Lots 14, 15 & 16 in Block 14, House, Garage, Improvements, Wood  
Deck with Railing & Beauty Parlor, Pioche Town

APN 11-220-10 Mason, Tim & Yvonne  
1.84 Acre in S1/2NW1/4SE1/4 Lying East of the East Right-of-way Line of Old Highway 93 &  
Lying West of The East Line of said S1/2NW1/4SE1/4 Section 32 T6S R61E, Metal Building,  
Well Shed, Well & Gasoline Tank

APN 11-220-11 Mason, Timothy & Yvonne  
1.64 Acre in NE1/4NW1/4SE1/4 Section 32 T6S R61E

APN 04-161-08 Mason, Timothy B. & Yvonne S.  
Lot 2 in Block 2 of Alamo West Subdivision, Alamo Town

APN 04-042-10 Mason, Timothy B., Yvonne S. & Mason, Romona  
Portion of Lot 4 (.827 Acre – 145.5 x 247.5) in Block 36, Corrals & Pens, Alamo Town

APN 13-190-09 McGill, Nancy & Michael S.  
21.41 Acres. Tract #9 Bradley Div Lg Pcls in Section 3 T3S R67E

APN 08-291-21 Metal Craft Trailers  
39.42 Acres in Section 21 T7S R61E. Parcel 3 of the Floyd R. Lamb Parcel Map Recorded in Book B, page 243 of Lincoln County Records

APN 13-090-06 Minniear, Tracy L. & Ardil L.  
11.385 Acres in SE1/4NE1/4NW1/4 & in E1/2SE1/4NW1/4 Section 33 T4S R70E & Personal Property (MH618)

APN 03-182-12 Moffit, Ray B.  
Parcel #2 of the Ray B. Moffitt Parcel Map, Book A of Official Records. Garage & Storage Building, Caliente City

APN 03-088-05 Mosser, Dean A.  
Lot 1 in Block 2, Manufactured Home, Storage Shed, Porches, Concrete Carport & Fences, Caliente City

APN 03-131-07 Mosser, Dean A.  
Lot 15 in Block A Gottfredson, Trailer Hookup, Room Addition, Garage, Fence & Personal Property (MH379), Caliente City

APN 06-361-03 Mosser, Dean A.  
Parcel #1 of Combined Metals Parcel Map located in the SW1/4 Section 28 T1N R67E, House, Porches, CFW with Steps, Garage & Storage Shed

APN 13-160-01 Oesterle, Bill & Hansen, Shirley  
49.46 Acres in NW1/2NW1/2 & NW1/4SW1/4 Section 11 T3S R67E

APN 13-180-01 Oesterle, Bill & Hansen, Shirley  
107.12 Acres in Section 15 T3S R67E

APN 03-077-24 Oesterle, Bill & Hansen, Shirley  
Lots 1, 2, 3 & a portion of Lot 4 in Block 1, Pizza Parlor, Addition, CFW, Brick Work, Hide Away Bar & Storage Building, Caliente City

APN 12-170-22 Perez, Colecto & Carmelia  
1.775 Acre. Parcel of Land in E1/2SW1/4NW1/4 Section 8 T2S R68E, Trailer Hookup, Enclosed Porch, Storage Sheds, CFW & Personal Property (MH628)

APN 01-341-20 Porter, Frank C. Jr & Sandra L.  
2.34 Acres. Parcel 39 of the James Vincent Subsequent Parcel Map Recorded in Book B, page 191, of Lincoln County Records, Pioche Town

APN 01-341-21 Porter, Frank C. Jr & Sandra L.  
2.51 Acres. Parcel 38 of the James Vincent Subdivision Parcel Map Recorded in Book B, page 191, of Lincoln County Records, Pioche Town

APN 01-341-26 Porter, Frank C. Jr. & Sandra L.  
2.39 Acres. Parcel 33 of the James Vincent Subsequent Parcel Map Recorded in Book B, page 192, of Lincoln County Records, Water, Electric, WOP w/steps & Personal Property, Pioche Town

APN 01-341-27 Porter, Frank C. Jr. & Sandra L.  
2.54 Acres. Parcel 32 of the James Vincent Subdivision Parcel Map Recorded in Book B, page 192, of Lincoln County Records, Pioche Town

APN 08-061-11 Poulsen, Mark G. & Suzanne G. (50%) & Poulsen, Glen C. (50%)  
11.54 Acres in NW1/4SE1/4 Section 16 T7S R61E. Corrals & Open Shed

APN 01-250-11 Robinson, Andrew T.  
2.426 Acres. Parcel 1 B of the Peter A. Robinson Parcel Map Recorded in Book A, page 449, of Lincoln County Records, Pioche Town

APN 02-102-18 Schiefer, John A. & Zelma Trust  
North 1/2 of Lot 50 and all Lot 51 in Sun Gold Manor, Trailer Hookup, Porch, CFW, Fence, Storage Shed & Personal Property (MH511), Panaca Town

APN 01-103-03 Schnepf, Frederick G. & Mary Jane Living Trust  
Lots 11, 12 & 13 in Block 19, Storage Building, Pioche Town

APN 03-201-06 Schweyer, Peter & Robin  
Plot of Land 50' x 130' in Section 8 T4S R67E, Caliente City

APN 03-201-07 Schweyer, Peter & Robin  
Plot of Land 130' x 160' in Section 8 T4S R67E, Caliente City

APN 03-184-01 Shearer, Gloria & Donald  
Lots 40, 41 & 42 in Block 12, House & Porch, Caliente City

APN 03-073-05 Skaggs, Andrew M. & Beth  
All Lot 7 & West 1/2 of Lot 8 in Block 7, Storage Buildings, CFW & Fence, Caliente City

APN 11-180-20 Spencer, Isaac T. & Judith A.  
5 Acres in E1/2NE1/4SW1/4SE1/4 Section 30 T6S R61E, Concrete Block Addition, Well & Septic System, Trailer Hookup, Water & Septic System, Open Shed & Personal Property (MH343 & 824)



APN 13-041-01 Stevens, Frank & Patricia  
Lot 1 in Highland Knolls Subdivision

APN 13-041-02 Stevens, Frank & Patricia  
Lot 2 in Highland Knolls Subdivision, Trailer Hookup, Well & Septic Systems, Storage Sheds &  
Personal Property (MH935)

APN 13-041-06 Stevens, Frank & Patricia  
9.74 Acres. Lots 6 & 7 in Highland Knolls Subdivision

APN 13-041-20 Stevens, Frank & Patricia  
9.74 Acres. Lots 26 & 27 in Highland Knolls Subdivision

APN 04-041-27 Stewart, Charles Jr.  
.275 Acre. Parcel 1 of the Dan & Enid Stewart Parcel Map in Book A, page 373, Trailer Hookup,  
Alamo Town

APN 08-360-11 Stewart, Leo K. & Delores E.  
7.7973 Acres. Parcel 2 of the Leo K. Stewart Parcel Map Recorded in Book A, page 412 of  
Lincoln County Records, Modular Motel, Porches, Water & Septic Systems, CFW, Blacktop &  
Wash Shed

APN 08-360-12 Stewart, Leo K. & Delores  
76.31 Acres in NW1/4NE1/4; In N1/2NE1/4; In S1/2NE1/4 Section 17 T7S R61E, In  
N1/2NW1/4; In N1/2NE1/4; In S1/2NW1/4 Section 16 T7S R61E, Described as Parcel A of the  
Leo K. & Delores Stewart Parcel Map Recorded in Book B, page 14, of Lincoln County Records.  
Farmstead: Trailer Hookups & Septic Systems, Equipment Storage Building, 3 Small Storage  
Sheds, Corrals, Loading Chute & Cattle Squeeze, Possessory Interest in Divalva Spring, Appl.  
#6913, Concrete Flatwork, Storage Room, Ramp, Addition, Garage & Personal Property (MH  
701)

APN 10-123-04 Toreson Industries, Inc.  
2.49 Acres. Lot 13 in Block 6 of Lincoln Estates, SW1/4 Section 30 T3S R55E

APN 10-123-05 Toreson Industries, Inc.  
2.49 Acres. Lot 12 in Block 6 of Lincoln Estates, SW1/4 Section 30 T3S R55E

APN 10-082-01 Toreson Industries, Inc.  
8.25 Acres. Lots 1 thru 16 in Block 6 of Lincoln Estates Unit #3

APN 10-122-09 Toreson Industries, Inc.  
2.16 Acres. Lot 1 in Block 4 of Lincoln Estates, SW1/4 Section 30 T3S R55E

APN 10-122-13 Toreson Industries, Inc.  
2.46 Acres. Lot 5 in Block 4 of Lincoln Estates, SW1/4 Section 30 T3S R55E

APN 10-122-15 Toreson Industries, Inc.  
2.46 Acres. Lot 7 in Block 4 of Lincoln Estates, SW1/4 Section 30 T3S R55E

APN 10-123-06 Toreson Industries, Inc.  
2.49 Acres. Lot 11 in Block 6 of Lincoln Estates, SW1/4 Section 30 T3S R55E

APN 10-123-07 Toreson Industries, Inc.  
2.49 Acres. Lot 10 in Block 6 of Lincoln Estates, SW1/4 Section 30 T3S R55E

APN 10-131-01 Toreson Industries, Inc.  
2.16 Acres. Lot 16 in Block 1 of Lincoln Estates, SE1/4 Section 30 T3S R55E

APN 10-131-02 Toreson Industries, Inc.  
2.34 Acres. Lot 15 in Block 1 of Lincoln Estates, SE1/4 Section 30 T3S R55E

APN 10-131-03 Toreson Industries, Inc.  
2.34 Acres. Lot 14 in Block 1 of Lincoln Estates, SE1/4 Section 30 T3S R55E

APN 10-131-07 Toreson Industries, Inc.  
2.34 Acres. Lot 10 in Block 1 of Lincoln Estates, SE1/4 Section 30 T3S R55E

APN 10-131-08 Toreson Industries, Inc.  
2.16 Acres. Lot 9 in Block 1 of Lincoln Estates, SE1/4 Section 30 T3S R55E

APN 10-131-12 Toreson Industries, Inc.  
2.34 Acres. Lot 4 in Block 1 of Lincoln Estates, SE1/4 Section 30 T3S R55E

APN 10-131-14 Toreson Industries, Inc.  
2.34 Acres. Lot 6 in Block 1 of Lincoln Estates, SE1/4 Section 30 T3S R55E

APN 10-131-15 Toreson Industries, Inc.  
2.34 Acres. Lot 7 in Block 1 of Lincoln Estates, SE1/4 Section 30 T3S R55E

APN 10-131-16 Toreson Industries, Inc.  
2.16 Acres. Lot 8 in Block 1 of Lincoln Estates, SE1/4 Section 30 T3S R55E

APN 10-132-01 Toreson Industries, Inc.  
2.16 Acres. Lot 16 in Block 3 of Lincoln Estates, SE1/4 Section 30 T3S R55E

APN 10-132-02 Toreson Industries, Inc.  
2.34 Acres. Lot 15 in Block 3 of Lincoln Estates, SE1/4 Section 30 T3S R55E

APN 10-132-03 Toreson Industries, Inc.  
2.34 Acres. Lot 14 in Block 3 of Lincoln Estates, SE1/4 Section 30 T3S R55E

APN 10-132-05 Toreson Industries, Inc.  
2.34 Acres. Lot 12 in Block 3 of Lincoln Estates, SE1/4 Section 30 T3S R55E

APN 10-132-06 Toreson Industries, Inc.  
2.34 Acres. Lot 11 in Block 3 of Lincoln Estates, SE1/4 Section 30 T3S R55E

APN 10-132-08 Toreson Industries, Inc.  
2.16 Acres. Lot 9 in Block 3 of Lincoln Estates, SE1/4 Section 30 T3S R55E

APN 10-132-09 Toreson Industries, Inc.  
2.16 Acres. Lot 1 in Block 3 of Lincoln Estates, SE1/4 Section 30 T3S R55E

APN 10-132-10 Toreson Industries, Inc.  
2.34 Acres. Lot 2 in Block 3 of Lincoln Estates, SE1/4 Section 30 T3S R55E

APN 10-132-11 Toreson Industries, Inc.  
2.34 Acres. Lot 3 in Block 3 of Lincoln Estates, SE1/4 Section 30 T3S R55E

APN 10-132-12 Toreson Industries, Inc.  
2.34 Acres. Lot 4 in Block 3 of Lincoln Estates, SE1/4 Section 30 T3S R55E

APN 10-132-14 Toreson Industries, Inc.  
2.34 Acres. Lot 6 in Block 3 of Lincoln Estates, SE1/4 Section 30 T3S R55E

APN 10-132-15 Toreson Industries, Inc.  
2.34 Acres. Lot 7 in Block 3 of Lincoln Estates, SE1/4 Section 30 T3S R55E

APN 10-132-16 Toreson Industries, Inc.  
2.16 Acres. Lot 8 in Block 3 of Lincoln Estates, SE1/4 Section 30 T3S R55E

APN 10-134-08 Toreson Industries, Inc.  
2.16 Acres. Lot 9 in Block 7 of Lincoln Estates, SE1/4 Section 30 T3S R55E

APN 10-134-10 Toreson Industries, Inc.  
2.34 Acres. Lot 2 in Block 7 of Lincoln Estates, SE1/4 Section 30 T3S R55E

APN 10-134-12 Toreson Industries, Inc.  
2.34 Acres. Lot 4 in Block 7 of Lincoln Estates, SE1/4 Section 30 T3S R55E

APN 10-134-14 Toreson Industries, Inc.  
2.34 Acres. Lot 6 in Block 7 of Lincoln Estates

APN 10-042-04 Toreson Industries, Inc.  
4.73 Acres. Lots 7 thru 10, 12, 14 thru 18 in Block 1 of Lincoln Estates Unit 4, Portion of NW1/4 Section 19 T3S R55E

APN 10-042-05 Toreson Industries, Inc.  
2.23 Acres. Lots 1, 2, 3, 4, 5 & 6 of Block 1 in Lincoln Estates Unit 4, Section 19 T3S R55E

APN 10-046-03 Toreson Industries, Inc.  
.43 Acre. Lot 15 in Block 5 of Lincoln Estates Unit 4

APN 10-051-01 Toreson Industries, Inc.  
5.22 Acres. Block 10 in Lincoln Estates Unit 4, Portion of NW1/4 Section 19 T3S R55E

APN 10-081-01 Toreson Industries, Inc.  
8.25 Acres. Lots 1 thru 16 in Block 5 of Lincoln Estates Unit #3

APN 10-083-01 Toreson Industries, Inc.  
8.25 Acres. Lots 1 thru 16 in Block 7 of Lincoln Estates Unit #3

APN 10-084-01 Toreson Industries, Inc.  
8.25 Acres. Lots 1 thru 16 in Block 8 of Lincoln Estates #3

APN 10-092-01 Toreson Industries, Inc.  
16.82 Acres. Lots 1 thru 32 in Block 2 of Lincoln Estates Unit #3

APN 10-093-01 Toreson Industries, Inc.  
16.82 Acres. Lots 1 thru 32 in Block 3 of Lincoln Estates Unit #3

APN 10-094-01 Toreson Industries, Inc.  
16.74 Acres. Lots 1 thru 32 in Block 4 of Lincoln Estates Unit #3

APN 10-101-01 Toreson Industries, Inc.  
16.77 Acres. Lots 1 thru 32 in Block 9 of Lincoln Estates Unit #3

APN 10-102-01 Toreson Industries, Inc.  
16.78 Acres. Lots 1 thru 32 in Block 10 of Lincoln Estates Unit #3

APN 10-103-01 Toreson Industries, Inc.  
16.78 Acres. Lots 1 thru 32 in Block 11 of Lincoln Estates Unit #3

APN 10-104-01 Toreson Industries, Inc.  
16.90 Acres. Lots 1 thru 32 in Block 12 of Lincoln Estates Unit #3

APN 10-111-04 Toreson Industries, Inc.  
1.18 Acre. Lot 17 in Block 8 of Lincoln Estates, Section 30 T3S R55E

APN 10-116-04 Toreson Industries, Inc.  
1.12 Acre. Lot 7 in Block 5 of Lincoln Estates Unit 2

APN 10-118-01 Toreson Industries, Inc.  
17.94 Acres. Lots 1 thru 16 in Block 1 of Lincoln Estates Unit 2, Portion of N1/2 Section 30 T3S R55E

APN 10-122-02 Toreson Industries, Inc.  
2.46 Acres. Lot 15 in Block 4 of Lincoln Estates

APN 10-124-11 Toreson Industries, Inc.  
2.34 Acres. Lot 3 in Block 8 of Lincoln Estates, SW1/4 Section 30 T3S R55E

APN 10-041-01 Toreson Industries, Inc.  
5.37 Acres. Block 10 of Lincoln Estates Unit 4, Portion of NW1/4 Section 19 T3S R55E

APN 10-043-01 Toreson Industries, Inc.

9.42 Acres. Lots 1 thru 18 in Block 2 of Lincoln Estates Unit 4, Portion of NW1/4 Section 19 T3S R55E

APN 10-044-01 Toreson Industries, Inc.

9.42 Acres. Lots 1 thru 18 in Block 3 of Lincoln Estates Unit 4, Portion of NW1/4 Section 19 T3S R55E

APN 10-045-01 Toreson Industries, Inc.

9.42 Acres. Lots 1 thru 18 in Block 4 of Lincoln Estates Unit 4, Portion of NW1/4 Section 19 T3S R55E

APN 10-046-02 Toreson Industries, Inc.

8.95 Acres. Lots 1 thru 14, 16, 17 & 18 in Block 5 of Lincoln Estates Unit 4, Portion of NW1/4 Section 19 T3S R55E

APN 10-047-01 Toreson Industries, Inc.

9.43 Acres. Lots 1 thru 18 in Block 6 of Lincoln Estates Unit 4, Portion of NW1/4 Section 19 T3S R55E

APN 10-048-01 Toreson Industries, Inc.

9.44 Acres. Lots 1 thru 18 in Block 7 of Lincoln Estates Unit 4, Portion of NW1/4 Section 19 T3S R55E

APN 10-049-01 Toreson Industries, Inc.

9.44 Acres. Lots 1 thru 18 in Block 8 of Lincoln Estates Unit 4, Portion of NW1/4 Section 19 T3S R55E

APN 10-052-01 Toreson Industries, Inc.

7.64 Acres. Lots 19 thru 36 in Block 1 of Lincoln Estates Unit 4, Portion of NW1/4 Section 19 T3S R55E

APN 10-053-01 Toreson Industries, Inc.

9.31 Acres. Lots 19 thru 36 in Block 2 of Lincoln Estates Unit 4, Portion of NW1/4 Section 19 T3S R55E

APN 10-054-01 Toreson Industries, Inc.

9.31 Acres. Lots 19 thru 36 in Block 3 of Lincoln Estates Unit 4, Portion of NW1/4 Section 19 T3S R55E

APN 10-055-01 Toreson Industries, Inc.

9.31 Acres. Lots 19 thru 36 in Block 4 of Lincoln Estates Unit 4, Portion of NW1/4 Section 19 T3S R55E

APN 10-056-01 Toreson Industries, Inc.

9.31 Acres. Lots 19 thru 36 in Block 5 of Lincoln Estates Unit 4, Portion of NW1/4 Section 19 T3S R55E



APN 10-057-01 Toreson Industries, Inc.  
9.31 Acres. Lots 19 thru 36 in Block 6 of Lincoln Estates Unit 4, Portion of NW1/4 Section 19  
T3S R55E

APN 10-058-01 Toreson Industries, Inc.  
9.31 Acres. Lots 19 thru 36 in Block 7 of Lincoln Estates Unit 4, Portion of NW1/4 Section 19  
T3S R55E

APN 10-059-01 Toreson Industries, Inc.  
9.31 Acres. Lots 19 thru 36 in Block 8 of Lincoln Estates Unit 4, Portion of NW1/4 Section 19  
T3S R55E

APN 10-061-01 Toreson Industries, Inc.  
14.98 Acres. Block 10 of Lincoln Estates Unit 4, Portion of SW1/4 Section 19 T3S R55E

APN 10-062-01 Toreson Industries, Inc.  
4.13 Acres. Lots 1 thru 8 in Block 9 of Lincoln Estates Unit 4, Portion of SW1/4 Section 19 T3S  
R55E

APN 10-063-01 Toreson Industries, Inc.  
7.24 Acres. Lots 1 thru 14 in Block 11 of Lincoln Estates Unit 4, Portion of SW1/4 Section 19  
T3S R55E

APN 10-064-01 Toreson Industries, Inc.  
7.24 Acres. Lots 1 thru 14 in Block 12 of Lincoln Estates Unit 4, Portion of SW1/4 Section 19  
T3S R55E

APN 10-065-01 Toreson Industries, Inc.  
7.24 Acres. Lots 1 thru 14 in Block 13 of Lincoln Estates Unit 4, Portion of SW1/4 Section 19  
T3S R55E

APN 10-066-01 Toreson Industries, Inc.  
7.24 Acres. Lots 1 thru 14 in Block 14 of Lincoln Estates Unit 4, Portion of SW1/4 Section 19  
T3S R55E

APN 10-067-01 Toreson Industries, Inc.  
7.24 Acres. Lots 1 thru 14 in Block 15 of Lincoln Estates Unit 4, Portion of SW1/4 Section 19  
T3S R55E

APN 10-068-01 Toreson Industries, Inc.  
7.24 Acres. Lots 1 thru 14 in Block 16 of Lincoln Estates Unit 4, Portion of SW1/4 Section 19  
T3S R55E

APN 10-071-01 Toreson Industries, Inc.  
19.88 Acres. Block 10 of Lincoln Estates Unit 4, Portion of SW1/4 Section 19 T3S R55E

APN 10-072-01 Toreson Industries, Inc.  
7.35 Acres. Lots 15 thru 28 in Block 11 of Lincoln Estates Unit 4, Portion of SW1/4 Section 19  
T3S R55E

APN 10-073-01 Toreson Industries, Inc.  
7.36 Acres. Lots 15 thru 28 in Block 12 of Lincoln Estates Unit 4, Portion of SW1/4 Section 19  
T3S R55E

APN 10-074-01 Toreson Industries, Inc.  
7.36 Acres. Lots 15 thru 28 in Block 13 of Lincoln Estates Unit 4, Portion of SW1/4 Section 19  
T3S R55E

APN 10-075-01 Toreson Industries, Inc.  
7.36 Acres. Lots 15 thru 28 in Block 14 of Lincoln Estates Unit 4, Portion of SW1/4 Section 19  
T3S R55E

APN 10-076-01 Toreson Industries, Inc.  
7.37 Acres. Lots 15 thru 28 in Block 15 of Lincoln Estates Unit 4, Portion of SW1/4 Section 19  
T3S R55E

APN 10-077-01 Toreson Industries, Inc.  
7.37 Acres. Lots 15 thru 28 in Block 16 of Lincoln Estates Unit 4, Portion of SW1/4 Section 19  
T3S R55E

APN 10-091-01 Toreson Industries, Inc.  
16.82 Acres. Lots 1 thru 32 in Block 1 of Lincoln Estates Unit 3

APN 10-112-01 Toreson Industries, Inc.  
37.01 Acres. Lots 1 thru 16, 18 thru 32 in Block 6 of Lincoln Estates Unit 2, Portion of N1/2  
Section 30 T3S R55E

APN 10-113-01 Toreson Industries, Inc.  
38.03 Acres. Lots 1 thru 32 in Block 4 of Lincoln Estates Unit 2, Portion of N1/2 Section 30 T3S  
R55E

APN 10-114-03 Toreson Industries, Inc.  
35.66 Acres. Lots 1 thru 14, 16 thru 31 in Block 2 of Lincoln Estates Unit 2, Portion of N1/2  
Section 30 T3S R55E

APN 10-115-01 Toreson Industries, Inc.  
16.88 Acres. Lots 1 thru 8, 10 thru 16 in Block 7 of Lincoln Estates Unit 2, Portion of N1/2  
Section 30 T3S R55E

APN 10-116-03 Toreson Industries, Inc.  
15.70 Acres. Lots 1, 2, 3, 5, 6, 8 & 9 thru 16 in Block 5 of Lincoln Estates Unit 2, Portion of  
N1/2 Section 30 T3S R55E

APN 10-117-01 Toreson Industries, Inc.  
17.94 Acres. Lots 1 thru 16 in Block 3 of Lincoln Estates Unit 2, Portion of N1/2 Section 30 T3S R55E

APN 10-121-01 Toreson Industries, Inc.  
37.28 Acres. Lots 1 and 4 thru 10 and 12 thru 15 in Block 2 of Lincoln Estates. SW1/4 Section 30 T3S R55E

APN 10-122-01 Toreson Industries, Inc.  
2.12 Acres. Lot 16 in Block 4 of Lincoln Estates, SW1/4 Section 30 T3S R55E

APN 10-122-03 Toreson Industries, Inc.  
2.46 Acres. Lot 14 in Block 4 of Lincoln Estates. SW1/4 Section 30 T3S R55E

APN 10-122-04 Toreson Industries, Inc.  
2.46 Acres. Lot 13 in Block 4 of Lincoln Estates. SW1/4 Section 30 T3S R55E

APN 10-122-05 Toreson Industries, Inc.  
2.46 Acres. Lot 12 in Block 4 of Lincoln Estates. SW1/4 Section 30 T3S R55E

APN 10-122-06 Toreson Industries, Inc.  
2.46 Acres. Lot 11 in Block 4 of Lincoln Estates, SW1/4 Section 30 T3S R55E

APN 10-122-07 Toreson Industries, Inc.  
2.46 Acres. Lot 10 in Block 4 of Lincoln Estates, SW1/4 Section 30 T3S R55E

APN 10-122-08 Toreson Industries, Inc.  
2.16 Acres. Lot 9 in Block 4 of Lincoln Estates, SW1/4 Section 30 T3S R55E

APN 10-122-10 Toreson Industries, Inc.  
2.34 Acres. Lot 2 in Block 4 of Lincoln Estates, SW1/4 Section 30 T3S R55E

APN 10-122-11 Toreson Industries, Inc.  
2.34 Acres. Lot 3 in Block 4 of Lincoln Estates, SW1/4 Section 30 T3S R55E

APN 10-122-12 Toreson Industries, Inc.  
2.34 Acres. Lot 4 in Block 4 of Lincoln Estates, SW1/4 Section 30 T3S R55E

APN 10-122-16 Toreson Industries, Inc.  
2.11 Acres. Lot 8 in Block 4 of Lincoln Estates, SW1/4 Section 30 T3S R55E

APN 10-123-01 Toreson Industries, Inc.  
2.14 Acres. Lot 16 in Block 6 of Lincoln Estates, SW1/4 Section 30 T3S R55E

APN 10-123-03 Toreson Industries, Inc.  
2.49 Acres. Lot 14 in Block 6 of Lincoln Estates, SW1/4 Section 30 T3S R55E

APN 10-123-10 Toreson Industries, Inc.  
2.49 Acres. Lot 2 in Block 6 of Lincoln Estates, SW1/4 Section 30 T3S R55E

APN 10-123-11 Toreson Industries, Inc.  
2.49 Acres. Lot 3 in Block 6 of Lincoln Estates, SW1/4 Section 30 T3S R55E

APN 10-123-12 Toreson Industries, Inc.  
2.49 Acres. Lot 4 in Block 6 of Lincoln Estates, SW1/4 Section 30 T3S R55E

APN 10-123-13 Toreson Industries, Inc.  
2.49 Acres. Lot 5 in Block 6 of Lincoln Estates, SW1/4 Section 30 T3S R55E

APN 10-123-15 Toreson Industries, Inc.  
2.49 Acres. Lot 7 in Block 6 of Lincoln Estates, SW1/4 Section 30 T3S R55E

APN 10-123-16 Toreson Industries, Inc.  
2.13 Acres. Lot 8 in Block 6 of Lincoln Estates, SW1/4 Section 30 T3S R55E

APN 10-124-01 Toreson Industries, Inc.  
2.16 Acres. Lot 16 in Block 8 of Lincoln Estates, SW1/4 Section 30 T3S R55E

APN 10-124-09 Toreson Industries, Inc.  
2.16 Acres. Lot 1 in Block 8 of Lincoln Estates, SW1/4 Section 30 T3S R55E

APN 10-124-12 Toreson Industries, Inc.  
2.34 Acres. Lot 4 in Block 8 of Lincoln Estates, SW1/4 Section 30 T3S R55E

APN 10-124-13 Toreson Industries, Inc.  
2.51 Acres. Lot 5 in Block 8 of Lincoln Estates, SW1/4 Section 30 T3S R55E

APN 10-124-14 Toreson Industries, Inc.  
2.51 Acres. Lot 6 in Block 8 of Lincoln Estates, SW1/4 Section 30 T3S R55E

APN 10-124-16 Toreson Industries, Inc.  
2.15 Acres. Lot 8 in Block 8 of Lincoln Estates, SW1/4 Section 30 T3S R55E

APN 10-131-04 Toreson Industries, Inc.  
2.34 Acres. Lot 13 in Block 1 of Lincoln Estates, SE1/4 Section 30 T3S R55E

APN 10-131-05 Toreson Industries, Inc.  
2.34 Acres. Lot 12 in Block 1 of Lincoln Estates, SE1/4 Section 30 T3S R55E

APN 10-132-07 Toreson Industries, Inc.  
2.34 Acres. Lot 10 in Block 3 of Lincoln Estates, SE1/4 Section 30 T3S R55E

APN 10-133-01 Toreson Industries, Inc.  
36.73 Acres. Lots 1 thru 16 in Block 5 of Lincoln Estates, SE1/4 Section 30 T3S R55E

APN 10-134-01 Toreson Industries, Inc.  
2.16 Acres. Lot 16 in Block 7 of Lincoln Estates, SE1/4 Section 30 T3S R55E

APN 10-134-05 Toreson Industries, Inc.  
2.34 Acres. Lot 12 in Block 7 of Lincoln Estates, SE1/4 Section 30 T3S R55E

APN 10-134-06 Toreson Industries, Inc.  
2.34 Acres. Lot 11 in Block 7 of Lincoln Estates, SE1/4 Section 30 T3S R55E

APN 10-134-09 Toreson Industries, Inc.  
2.16 Acres. Lot 1 in Block 7 of Lincoln Estates, SE1/4 Section 30 T3S R55E

APN 10-134-11 Toreson Industries, Inc.  
2.34 Acres. Lot 3 in Block 7 of Lincoln Estates, SE1/4 Section 30 T3S R55E

APN 10-134-16 Toreson Industries, Inc.  
2.16 Acres. Lot 8 in Block 7 of Lincoln Estates, SE1/4 Section 30 T3S R55E

APN 08-291-02 Turley, Luther Dean Jr. & Kimberly  
2 Acres in NE1/4 Section 21 T7S R61E. House, Water & Septic System, CFW & Metal Quonset Building

APN 10-122-14 Van Norman, Robert  
Lot 7 in Block 4 of Lincoln Estates

APN 10-141-01 Verzani, George E.  
36.53 Acres. Lots 1 thru 32 in Block 1 of Lincoln Estates Unit #5, E1/2 Section 31 T3S R55E

APN 10-142-01 Verzani, George E.  
36.12 Acres. Lots 1 thru 32 in Block 2 of Lincoln Estates Unit #5

APN 10-143-01 Verzani, George E.  
36.63 Acres. Lots 1 thru 32 in Block 3 of Lincoln Estates Unit #5

APN 10-144-01 Verzani, George E.  
38.72 Acres. Lots 1 thru 32 in Block 4 of Lincoln Estates Unit #5

APN 10-151-01 Verzani, George E.  
Lots 1 thru 32 in Block 5 of Lincoln Estates Unit #5

APN 10-152-01 Verzani, George E.  
Lots 1 thru 32 in Block 6 of Lincoln Estates Unit #5

APN 10-153-01 Verzani, George E.  
Lots 1 thru 32 in Block 7 of Lincoln Estates Unit #5

APN 10-154-01 Verzani, George E.  
Lots 1 thru 31 in Block 8 of Lincoln Estates Unit #5, Steel Building & Improvements

APN 10-124-05 VJA Investments (2/3) & Paul A. Richards, LTD (1/3)  
Lot 12 in Block 8 of Lincoln Estates



APN 11-080-08 Wadsworth, Lamont & Annette  
4.699 Acres. Parcel 2 of the Charles E. Wadsworth Parcel Map Recorded in Book A, page 467 of  
Lincoln County Records

APN 11-160-16 Wadsworth, Lamont C & Annette  
1.73 Acres. Parcel 1 A of the Lamont Wadsworth Map in the S1/2 Section 19 T6S R61E.  
Recorded in Book B, page 236 of Lincoln County Records, Trailer Hookup, Well & Septic  
System, Residence, Garage, Porches & Septic System

APN 01-065-25 Washburn, Vell & Ellamae  
Lots 34, 35 & West 1/2 of Lot 36 in Block 5, Pioche Town

APN 10-162-12 Westcott, Douglas J. & Pamela J.  
5.42 Acres. Lot 11 in Sunrise Acres Tract #1, Trailer Hookup, Well & Septic System. Addition.  
Storage Shed, Barn, Corrals, CFW, Patio Cover & Personal Property (MH585)

APN 12-170-02 Wilkin, Joseph D. & Susanne C.  
1.11 Acres in W1/2W1/2W1/2NW1/4SW1/4 Section 8 T2S R68E, Clinic, Garage, Well & Septic  
System, Metal Shop Building, & Personal Property

APN 01-034-02 Wilkin, Joseph D.  
Lots 1, 2, 3, 4, 5, 6, 7, 8, 9, 10, 11, 12, 13 & 14 in Block 41, Pioche Town

APN 01-035-08 Wilkin, Joseph D.  
Lots 27, 28, 29, 30, 31 & 32 in Block 39, Work Shop, Pioche Town

APN 06-041-11 Wilkin, Margaret C.  
10 Acres in N1/2NW1/4 U.S. Government Lot #8 & in S1/2SW1/4 U.S. Government Lot #1 in  
Section 34 T5N R67E, House, Porch, Shed, Septic System & Well System

APN 02-270-02 Wilkin, Susanne Trust  
6.52 Acres. Parcel #1A of Joseph Wilkin Parcel Map Recorded in Book B, page 18 of Lincoln  
County Records, Panaca Town

APN 02-270-04 Wilkin, Susanne Trust  
5.09 Acres. Parcel 3 of the Joseph D. & Susanne Wilkin Parcel Map Recorded in Book B, page  
18 of Lincoln County Records, Panaca Town

APN 01-057-10 Wilson, Mark & Mary  
Part of 6 1/2 Lots: 14.11 Feet of Lot 34, N120 Feet of Lot 35, North 14 Feet of Lots 37, 38, 39, 40  
& 41 in Block 37, House, Carport, Porches, Fence & Storage Shed, Pioche Town

APN 03-181-06 Wishart, Reba L.  
Lots 28 & 29 in Block 9, Storage Building, Porch & Garage, Caliente City

APN 04-071-11 Wood, Gary A. & Charlotte S.  
Portion of Lot 2 in Block 57 (85 x 123.75), Trailer Hookup, Porches & Addition, Personal  
Property (MH672), Alamo Town

APN 04-071-20 Wood, Gary A. & Charlotte S.  
South 100.5 feet of E1/2 Lot 2 in Block 57, Shed & Metal Corrals, Alamo Town

APN 03-131-17 Young, Melinda  
Lot 1 in Block A Gottfredson Subdivision, House, Porches, Garage, CFW & Fence, Caliente City

APN 03-121-34 Young, Ronal T. Trust  
.446 Acre. Parcel G of the Ronal T. Young Parcel Map Recorded in Book B, page 319 of Lincoln  
County Records, in Section 7 T4S R67E, Caliente City

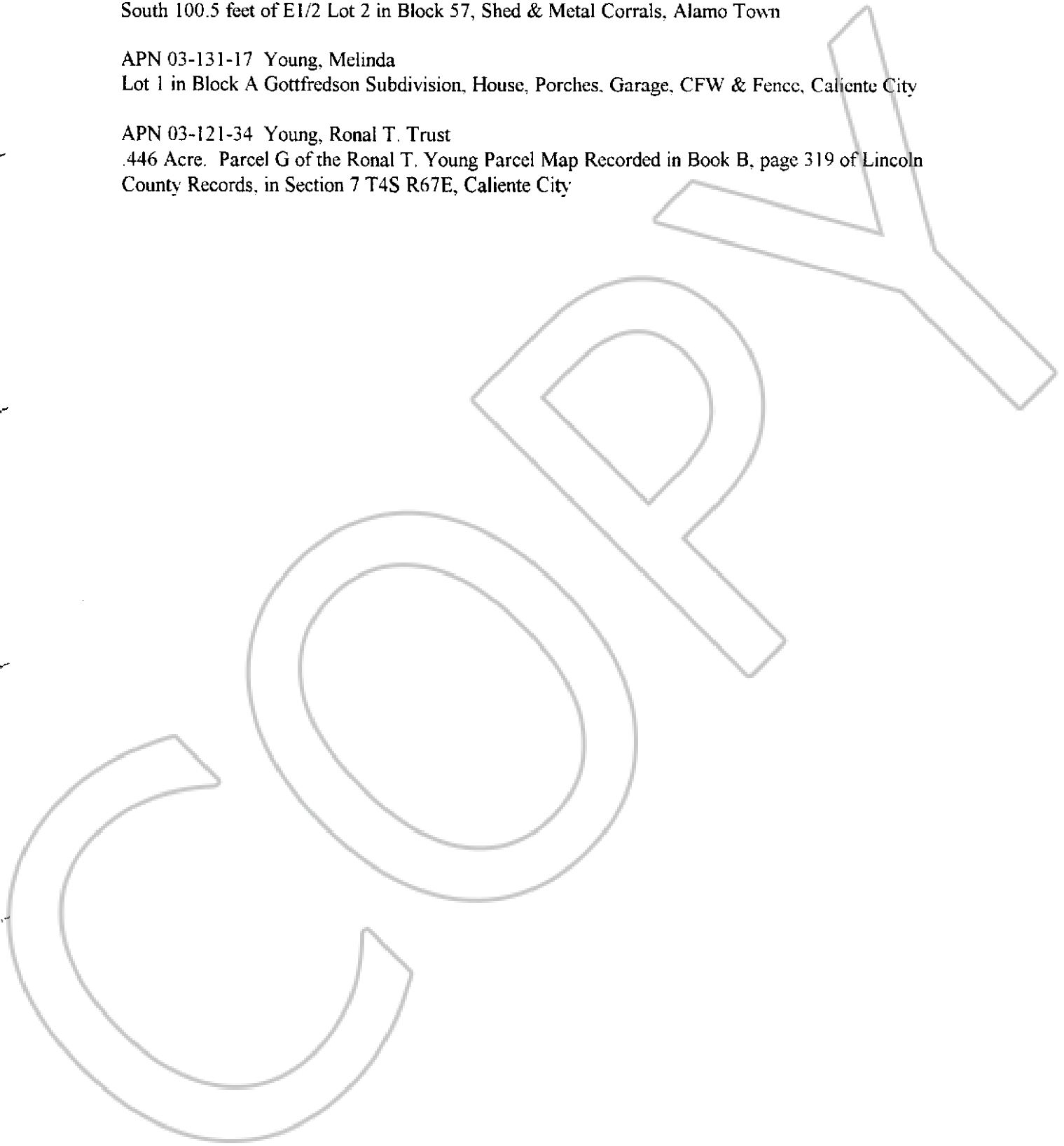

Now, therefore, pursuant to law and the premises, the County Treasurer of Lincoln County, State of Nevada, is hereby authorized to hold the property herein described, as Trustee for said County and State, subject to redemption within two (2) years from the date hereof, by payment of the taxes, costs and penalties in the sums as shown on the previous pages, together with accruing taxes, etc.

The total taxes, penalties and advertising contained in this list is:

Tax	\$	46,253.72
Penalties & Advertising	\$	11,585.82
Total	\$	57,839.54

Together with accruing taxes, penalties, costs and interest.

The Treasurer, as Trustee for said County and State, will be entitled to a Deed in Two (2) years from date hereof, if not sooner redeemed.

Given under my hand this 3rd day of June, A. D., 2002.

*Kathy C. Hiatt*

Kathy C. Hiatt, Treasurer and  
Ex-officio Tax Receiver  
County of Lincoln  
State of Nevada

Subscribed and sworn to before me  
this 3rd day of June, A. D., 2002

*Corriné Hogan*

Corriné Hogan  
County Clerk and Ex-officio  
Clerk of the Seventh Judicial  
District Court of the  
County of Lincoln  
State of Nevada

FILED FOR RECORDING  
AT THE REQUEST OF  
Lincoln County Treasurer  
2002 JUN 4 PM 9 11  
LINCOLN COUNTY RECORDED  
FEE NO FEE DEPTMUS  
LESLIE BOUCHER

1 1 8 2 3 9