

Lenard Smith Land Survey

P.O. Box 443 509 Main Street

Caliente, Nevada 89008

Phone/Fax (702) 726-3365

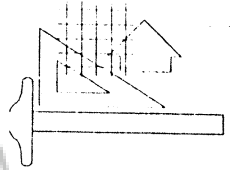

January 30, 2002

Mr. Martin Sprague, County Surveyor
Lincoln County, Nevada
6655 Bermuda Road
Las Vegas, Nevada 89119

Subject: Certificate of Amendment for Jerry Maeder and Judy Maeder, Plat Book B, Page 412, Lincoln County, Nevada Records.

Location: In Block A of the West End Subdivision of the City of Caliente Lots 8 and 9

Dear Mr. Sprague:

In accordance with NRS 278.473, it is hereby requested that the map be amended in the following manner:

In the Owner's Certificate, a second owner, the wife of Jerry Maeder needs to be added and is included herewith:

1. I, Judy Maeder have examined the above stated map and certify that I am an owner of the properties as shown and have requested Lenard D. Smith, a Professional Land Surveyor to prepare this map and authorize the recordation of the same.
2. All property taxes have been paid for this fiscal year.
3. Any lender with an impound account for the payment of taxes has been notified of the adjustment of the boundary line or the transfer of the land.

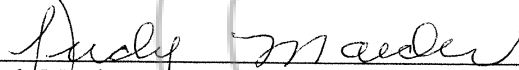

 Judy Maeder

STATE OF NEVADA
 } ss
 COUNTY OF LINCOLN

The above person, Judy Maeder, have personally appeared before me, a Notary Public and has executed the above Owner's Certificate freely and voluntarily for the purposes stated.

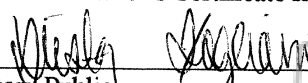

 Notary Public

2-4-02

 Date

Sincerely,

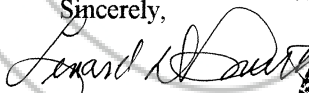

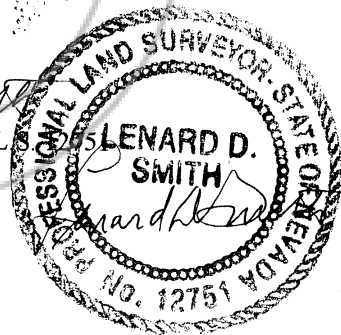
 Lenard D. Smith P.L.S.



2-6-02

County Surveyor's Certificate:

I hereby certify that I have examined the Certificate of Amendment and that the changes to the original document specified thereon are provided for in applicable sections of NRS 278.010 to 278.630 inclusive, NRS 625.340 to 625.380 inclusive, and local ordinances adopted pursuant thereto, and am satisfied that this Certificate of Amendment so amends the document as to make it technically correct.



Martin Sprague
County Surveyor, Lincoln County, Nevada
Nevada License No. 10355

2/4/02
Date

NO. **117664**

FILED AND RECORDED AT REQUEST OF
LENARD SMITH
FEBRUARY 6, 2002

AT 03 MINUTES PAST 11 O'CLOCK
AM IN BOOK B OF SPECIAL
RECORDS PAGE 421 LINCOLN

COUNTY, NEVADA.

LESLIE BOUCHER

COUNTY RECORDER

BY Deresa Lee, DEPUTY

OWNER'S CERTIFICATE

1. Jerry Maeder have examined this map, certify that we are the owners of the properties as shown and have requested Lenard D. Smith, a Professional Land Surveyor to prepare this map, and authorize the recordation of same when completed.
2. All the property taxes have been paid for this fiscal year.
3. Any lender with an impound account for the payment of taxes has been notified of the adjustment of the boundary line or the transfer of the land.

Jerry Maeder
Jerry Maeder

ACKNOWLEDGEMENT

STATE OF NEVADA } ss
COUNTY OF LINCOLN

The above persons, Jerry Maeder, have personally appeared before me, a Notary Public, and have executed the above owner's certificate freely and voluntarily for the purposes stated.

Denise C. Caffe 11/15/01
Notary Public Date

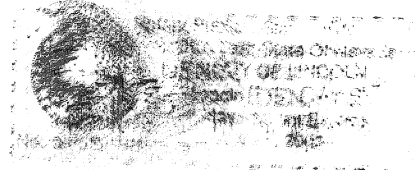
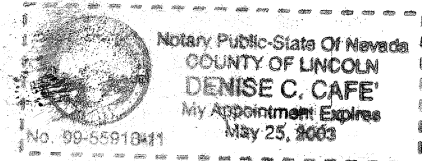

BASIS OF BEARINGS

"A" Street centerline (from a brass disc (by PLS 4235) on the west end and a street well/brass cap (PLS 2882) on the east end (no recorded maps on either). The centerline is listed as N59°52'08"E in a map filed Plat Book B, Page 59 of Lincoln County, Nevada Records.

LEGEND

- Set rebar & plastic cap stamped L SMITH PLS 12751
- ▨ Lot line to be eliminated
- - - Existing occupation fence (various types)
- - - Street right of way line
- - - Property line
- - - Centerline

CALIENTE CITY COUNCIL

At the regular meeting of the Caliente City Council held this 15th day of November, 2001 this plat was examined and approved for recordation.

Kevin Phillip Mayor
Sandra Welch Attest, City Clerk

SURVEYOR'S CERTIFICATE

1. Lenard D. Smith, a Professional Land Surveyor registered in the State of Nevada, certify that:
1. This plat represents the results of a survey conducted under my supervision at the instance of Jerry Maeder.
2. The land surveyed lies within Section 7, Township 4 South, Range 67 East, M.D.M. in Caliente, Lincoln County, Nevada. The survey was completed on November 6, 2001.
3. This plat complies with applicable statutes of this state and any local ordinances in effect on the date that the survey was completed, and the survey was conducted in accordance with Chapter 625 of the Nevada Administrative Code, as well as NRS 278.010 to 278.630 inclusive.
4. The monuments depicted on the plat are of the character shown, occupy the positions indicated, and are of sufficient durability.
5. I have performed a field survey sufficient to locate and identify properly the proposed new lot line.

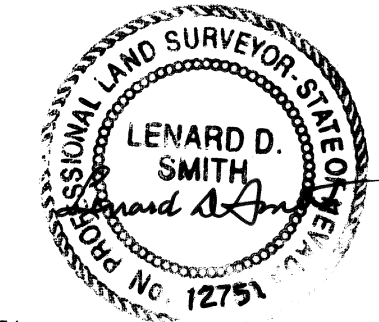

Lenard D. Smith P.L.S. 12751
Nov. 15, 2001

MAP REFERENCE

Map of the WEST END ADDITION to the City of Caliente, Lincoln County, Nevada recorded as Plat Book A, Page 44, of said Lincoln County Records.
Record of Survey, filed Plat Book B, Page 59, Lincoln County, Nevada Records.

RECORDER'S CERTIFICATE

File number 117387
Recorded at the request of Lenard D. Smith
Filed in Plat Book B, Page 412
This 30th day of November, 2001
at 2:15 p. m.
LESLIE BOUCHER, RECORDER
By Sandra Stevens Deputy
21.00

A.P.N. 003-143-06

MERGER & RESUBDIVISION PLAT OF BLOCK A, WEST END SUBDIVISION OF THE CITY OF CALIENTE, NEVADA, AFFECTING LOTS 8 AND 9

FOR JERRY MAEDER

IN THE NE1/4SE1/4 SECTION 7, T.4S., R.67E. M.D.M. IN THE CITY OF CALIENTE, LINCOLN COUNTY, NEVADA



SCALE: 1" = 50'

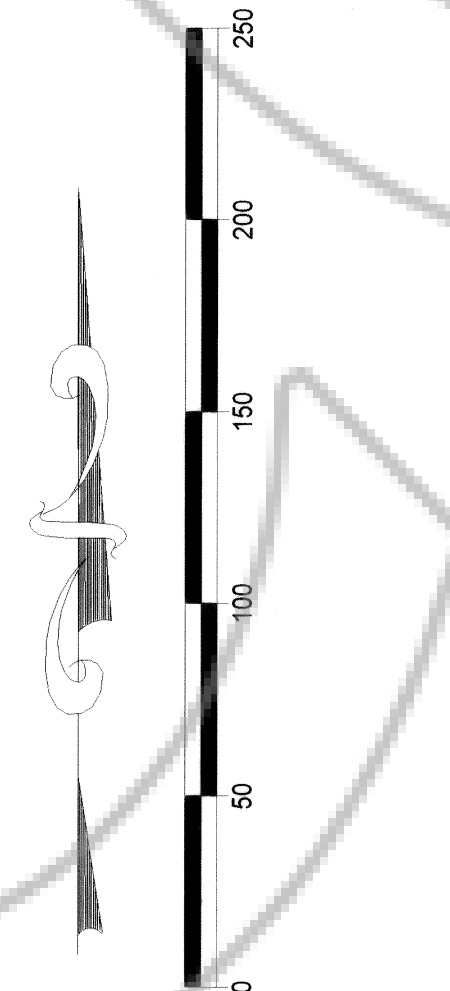

MAP NOTE: The Front Street line through Lots 8 to 12 is shown along the sidewalk line, which more or less follows the 30' highway painted highway centerline. (The centerline is not straight and therefore uncertain.)

7 8
18 17
T.4S., R.67E

Found brass disk set in concrete stamped PLS 4235

Set PK nail at edge of sidewalk in signpost base

Found SE corner Section 7 2 1/2" pipe with plate stamped F.W.M. & Son 11-20-63

Found Street Well with brass cap stamped PLS 2884

412
421

SECOND STREET

