

402

SURVEYOR'S CERTIFICATE

- I, Lenard D. Smith, a Professional Land Surveyor registered in the State of Nevada, certify that:
1. This plat represents the results of a survey conducted under my supervision at the instance of Oren Nash and Edward T. and Cathy Maloy
 2. The land surveyed lies within Section 11, Township 4 South, Range 60 East, M.D.M. in Lincoln County, Nevada. The survey was completed on Sept. 29, 2001
 3. This plat complies with applicable statutes of this state and any local ordinances in effect on the date that the survey was completed, and the survey was conducted in accordance with Chapter 625 of the Nevada Administrative Code.
 4. The monuments depicted on the plat are of the character shown, occupy the positions indicated, and are of sufficient durability.

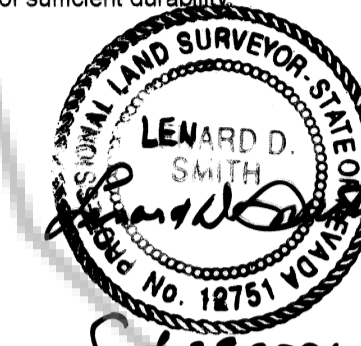

Lenard D. Smith P.L.S. 12751

LEGEND

- Set #5 rebar & cap stamped L SMITH PLS 12751
- Found #5 rebar & cap stamped PLS 6204

MAP REFERENCES

General Land Office survey notes, Monroe, 1870
Parcel Map for Keith Whipple, Plat Book A, Page 450, Lincoln County, Nevada records.

BASIS OF BEARINGS

Bearings based on Global Positioning System from field survey by Richard E. Forger, P.L.S. 4235

COUNTY SURVEYOR

I have examined this plat and find it technically correct and hereby approve it for recordation.

Timothy J. Wolf 8/19/01
Timothy J. Wolf, Lincoln County Surveyor

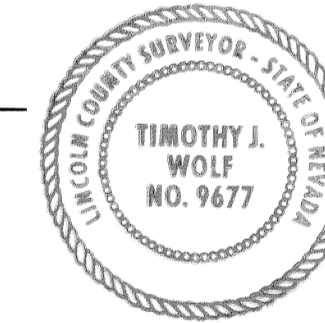

SCALE: 1" = 300'

RECORDER'S CERTIFICATE

File number 117054
 Recorded at the request of Lenard D. Smith
 Filed in Plat Book B, Page 402
 This 1st day of October 2001
 at 2:15 p.m.
 LESLIE BOUCHER, RECORDER
 By Terisa Seever Deputy

AMENDED RECORD OF SURVEY, PLAT BOOK B, PAGE 286

FOR OREN NASH AND
EDWARD W. AND CATHY T. MALOY
IN THE SW1/4SW1/4 SECTION 11, TOWNSHIP 4 SOUTH,
RANGE 60 EAST, MOUNT DIABLO MERIDIAN,
IN LINCOLN COUNTY, NEVADA

