

Lincoln County

26 | 25
35 | 36

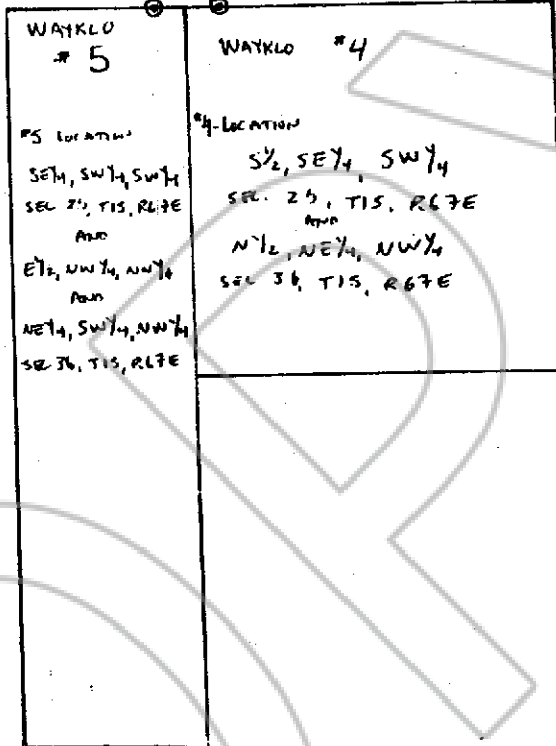

Describe here the position of the Claim Location Monument, if one is used.

MONUMENTS MARKED AS O SYMBOL ARE NEAR THE NE & NW CORNERS OF CLAIMS 5 & 4 RESPECTIVELY.

Map of the WAYKLO Mining Claim Group,

in Section 25, 36 Township, 1 SOUTH Range 67 EAST

in the PICCHE Mining District,

LINCOLN County, Nevada.

Located on the 30 day of JULY, 2001, by

STEVEN W. & TORRIE O. KLUMP

Locator name and address (please print)

450 E. MAIN ST. BOX 308

PANAMA, NV 89042

CARLISLE FORM NO. 50 N-T

RECORDER'S STAMP
NO. 116996

FILED AND RECORDED AT REQUEST OF
STEVEN W. KLUMP

SEPTEMBER 21, 2001

AT 20 MINUTES PAST 01 O'CLOCK

PM IN ROOM 158 OF OFFICIAL

RECORDS INBOX 335 LINCOLN

COUNTY, NEVADA.

LESLIE BOUCHER
COUNTY RECORDER

BY Janeba Lewis DEPUTY