

SURVEYOR'S CERTIFICATE

I, Lenard D. Smith, a Professional Land Surveyor registered in the State of Nevada, certify that:

1. This plat represents the results of a survey conducted under my supervision at the instance of Kevin D. & Sandra M. Olson.
2. The land surveyed lies within Section 8, Township 2S, Range 68 East, Lincoln County, Nevada. The survey was completed on March 23, 2001.
3. This plat complies with applicable statutes of this state and any local ordinances in effect on the date that the survey was completed, and the survey was conducted in accordance with Chapter 625 of the Nevada Administrative Code.
4. The monuments depicted on the plat are of the character shown, occupy the positions indicated, and are of sufficient durability.

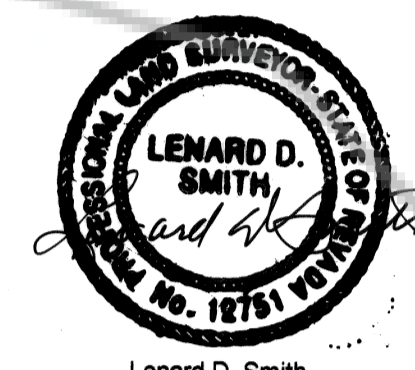

Lenard D. Smith
P.L.S. 12751
April 21, 2001

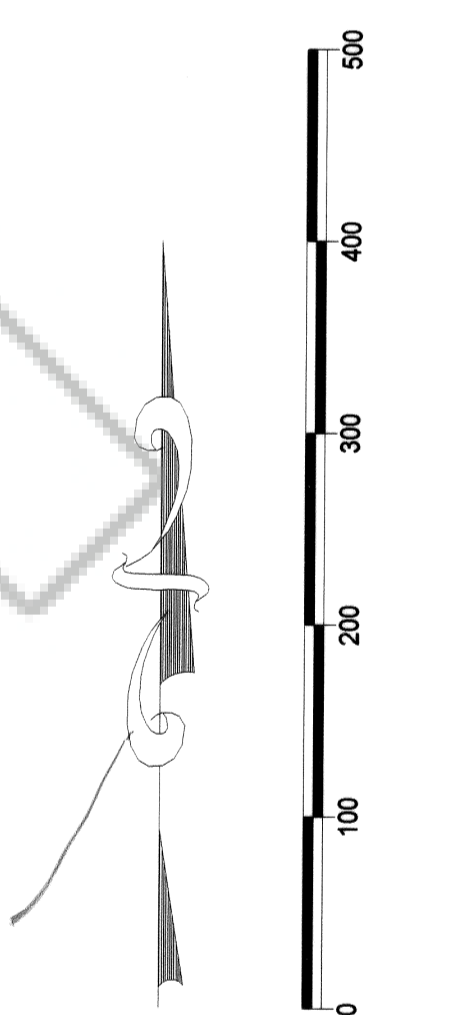

SCALE: 1" = 100'

LEGEND

- Set 5/8" rebar with cap stamped L SMITH PLS 12751
- Found 5/8 rebar with cap stamped L SMITH PLS 12751
- ✱ Found 1/2" rebar with cap stamped NEVADA PLS 6498
- Fence line

MAP REFERENCES & NOTES

This plat was based on the Record of Survey Plat Book B, Page 165 of Lincoln County, Nevada Records. Reference also made to Record of Survey Plat Book A, Page 285 of Lincoln County, Nevada Records. Nevada Department of Transportation highways location based on found monuments as shown. Abandoned railroad boundaries based on the best fit of the fences north and south and the Record of Survey Plat Book B, Page 165. Highway State Route 319 right-of-way is based on the found monument shown at the intersection of U.S. 93, and the centerline of SR 319 between curbs in Panaca, 3rd & Main Street. Fencelines and centerline markings showed some variance.

BASIS OF BEARINGS

The Basis Bearings is the east line of Section 8, Township 2 South, Range 68 East, M.D.M. as monumented by Standard Bureau of Land Management brass caps set in 1956, a Dependent which has not, as yet been approved.

RECORDER'S CERTIFICATE

File number **116250**
Recorded at the request of Lenard D. Smith
Filed in Plat Book B, Page **369**
This 27 day of April, 2001
at 4:55 p.m.
LESLIE BOUCHER, RECORDER
By Leslie Boucher
1700

RECORD OF SURVEY

FOR KEVIN D. & SANDRA M. OLSON

IN THE SW1/4NW1/4 SECTION 8,
TOWNSHIP 2 SOUTH RANGE 68 EAST, M.D.M.

