

**SURVEYOR'S CERTIFICATE**

I, James J. Owens, a Professional Land Surveyor registered in the State of Nevada, do hereby certify that:

- This Plat represents the results of a survey conducted by me, or under my direct supervision at the instance of Gordon A. Kline & Charlotte Kline, owners.
- The lands surveyed lie within Parcel 2, of Parcel Map Book Plat 'B', Page 300, situated in Sec. 10, T. 1 N., R. 67 E., M.D.M., Town of Pioche, Lincoln County, Nevada, and the survey was completed on Oct. 26, 1999.
- This plat complies with the applicable state statutes and any local ordinances in effect on the date that the Governing Body gave its final approval.
- The monuments depicted on this plat are of the character shown, occupy the positions indicated and are of sufficient number and durability.

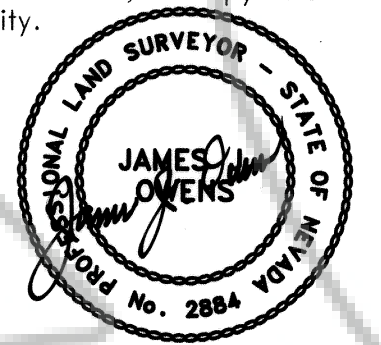

**OWNER'S CERTIFICATE**

We, Gordon A. Kline & Charlotte Kline, do hereby certify that we are the owners of the land hereon shown, that we have caused this property to be platted into parcels, and easements as shown and do hereby dedicate all shown public utility easements to the public utility agencies for the construction and maintenance of surface and or subterranean utilities, and do hereby consent to the preparation and recordation of this parcel map.

Gordon A. Kline Charlotte Kline  
Gordon A. Kline Date Charlotte Kline Date

**ACKNOWLEDGMENT**

State of Nevada SS  
County of Clark

This instrument was acknowledged before me on this 10<sup>th</sup> day of March, 2000, by Gordon A. Kline & Charlotte Kline.

Doris A. Jucker  
My commission expires on the 3<sup>rd</sup> day of August, 2002.



**LINCOLN COUNTY PLANNING COMMISSION APPROVAL**

This is to certify that the Board of the Lincoln County Planning Commission, Lincoln County, Nevada, did on this \_\_\_ day of \_\_\_, 199\_\_\_, approve for purposes of land division and accept in behalf of the public, this map and any parcels of land offered for dedication for public use in conformity with the terms of the of dedication as per N.R.S. 278.650 through 278.650, inclusive.

Janice R. Spaulding 1/22/99  
Chairman Date  
Board of the Lincoln County Planning Commission, Lincoln County, Nevada

**LINCOLN COUNTY COMMISSION APPROVAL**

This map has been reviewed and approved on this 22 day of Nov, 1999, by the Lincoln County Commissioners as a Parcel Map.

Don Feb 6-27-2000  
Chairman Date  
Lincoln County Commissioners

Carrie Hogan 6-29-2000  
Attest: Clerk Date

**OWNER'S CERTIFICATE for INGRESS, EGRESS & UTILITY EASEMENT**

We, Douglas & Linda Canfield, do hereby certify that we are the owners of APN 001-331-69, and that we do hereby grant the easement shown hereon this plat for the purpose of ingress, egress & public utilities.

Douglas Canfield Linda Canfield  
Douglas Canfield Date Linda Canfield Date

**ACKNOWLEDGMENT**

State of Nevada SS  
County of Clark

This instrument was acknowledged before me on this 10<sup>th</sup> day of March, 2000, by Gordon A. Kline & Charlotte Kline.

Doris A. Jucker  
My commission expires on the 3<sup>rd</sup> day of August, 2002.



**BASIS OF BEARING**

The Basis of Bearing was established by G.P.S., using a known NAD83 Nevada State Plane (East Zone) Coordinate on a U.S.G.S. control station described as "PANACA 2".

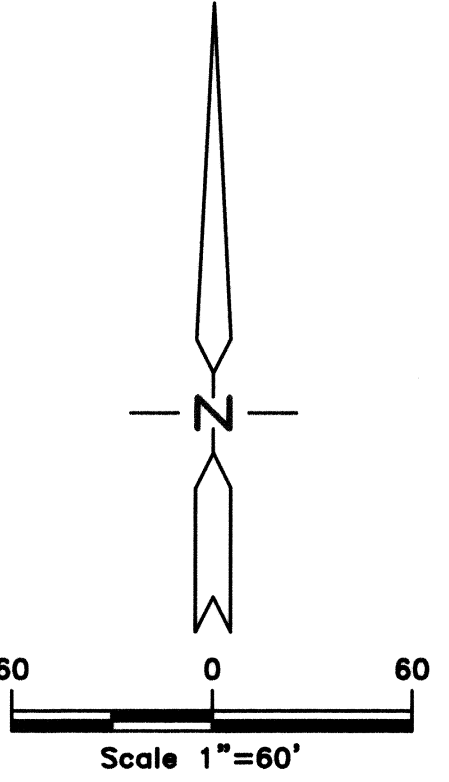
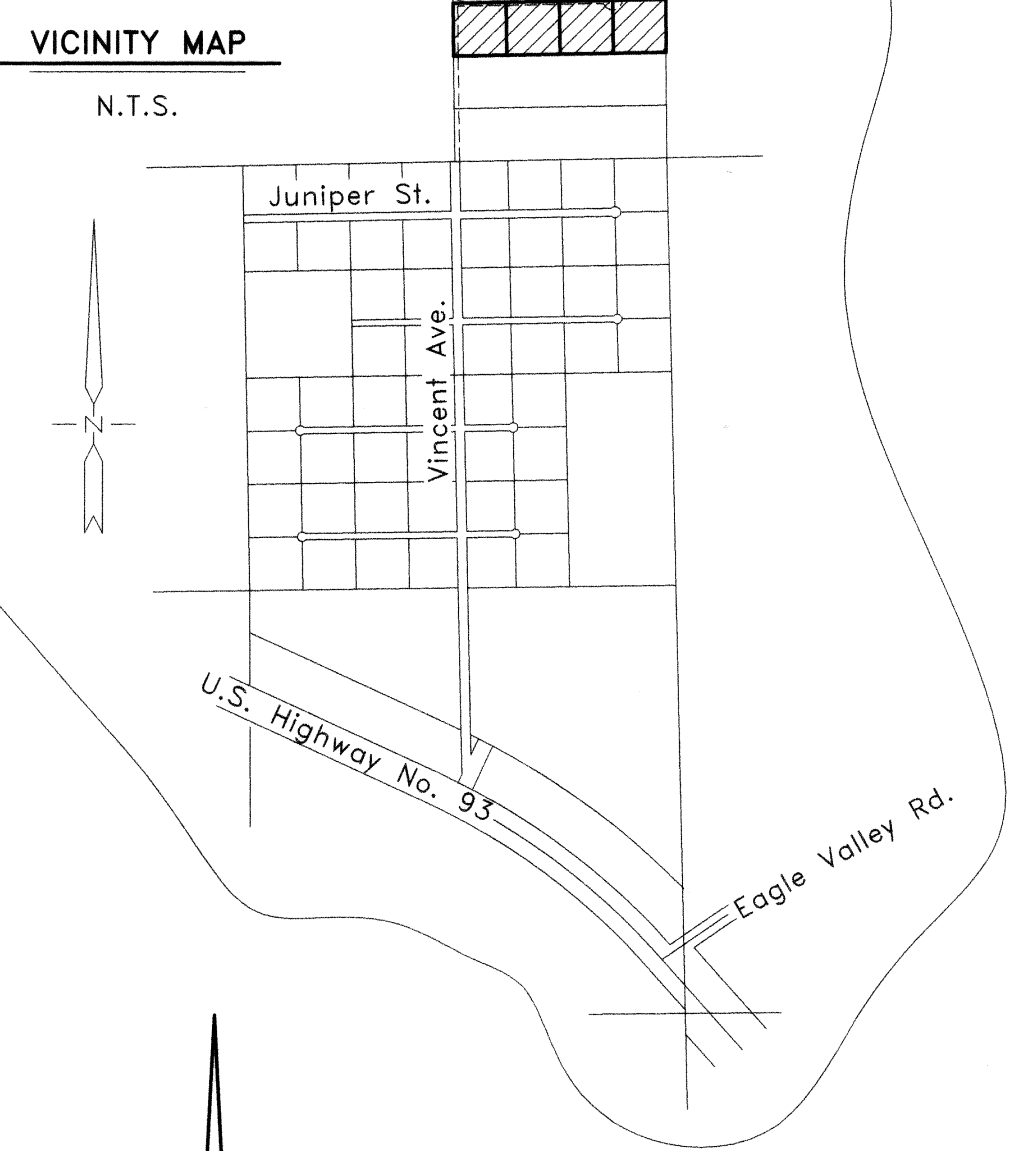

**REFERENCE MAPS**

- 1. Parcel Map Book Plat 'B', Page 102, dated 03/31/98.

**LEGEND**

- Set 1/2" rebar w/ plastic cap marked "OWENS PLS 2884".
- Found 1/2" rebar w/ plastic cap marked "HULSE PLS 6498".
- ⊕ Found B.C. for Sec. Cor. as noted.

**STATEMENT**

Any Subsequent changes to this map should be examined and may be determined by reference to the County Recorder's Cumulative Map Index, N.R.S. 278.5695.

**PARCEL MAP**  
for  
**Gordon A. Kline & Charlotte Kline**  
A Division of Parcel 2, of Parcel Map Book Plat 'B' Page 102,  
Sec. 10, T. 1 N., R. 67 E., M.D.M., Town of Pioche,  
Lincoln County, Nevada

No. **115944**  
Filed at the Request of:  
The Owens Surveying Outfit, Inc.  
Date Feb. 8, 2001 At 5:05 pm  
Book Plat B Page 359  
Official Records  
Lincoln County, Nevada  
Leslie Boucher  
Leslie Boucher, Recorder  
Christa Stewart  
Christa Stewart, Deputy  
Fee 17.00

**THE OWENS SURVEYING OUTFIT, INC.**  
Water Right, Mineral & Land Surveying throughout the West  
P.O. Box 540  
99 W. Hollywood  
Pioche, Nevada 89043  
Tel : 775-962-5115  
Fax : 775-962-5116

Nev-255  
S. Hafen