

LYH

335

SURVEYOR'S CERTIFICATE

1. Lenard D. Smith, a Professional Land Surveyor, registered in the State of Nevada, certify that:
1. This plat represents the results of a survey conducted under my direct supervision at the instance of Ronal Young.
2. The Lands surveyed lie within section 7, T.4S., R. 67E., M.D.M. in the City of Caliente, Lincoln County, Nevada, and the survey was completed on April 27, 2000.
3. This plat complies with the applicable state statutes and any local ordinances in effect on the date that the governing body gave its final approval.
4. The monuments depicted on the plat are of the character shown, occupy the positions indicated and are of sufficient number and durability.

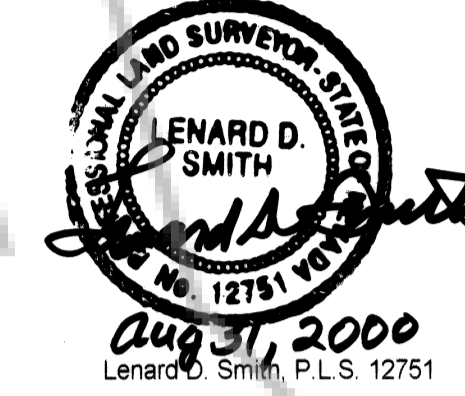

OWNER'S CERTIFICATE

I, Ronal T. Young, do hereby certify that I am the owner of the land shown on this Subdivision plat and have requested Lenard D. Smith, a Professional Land Surveyor to prepare this plat for recordation. The streets shown hereon named:

Ronal T. Young
Ronal T. Young

ACKNOWLEDGEMENT

STATE OF NEVADA } ss
COUNTY OF LINCOLN } ss
On this 7th day of September, 2000, Ronal T. Young appeared before me, a Notary Public and executed the above Owner's Certificate for the purposes stated therein.

Stephanie Holzeal
Notary Public

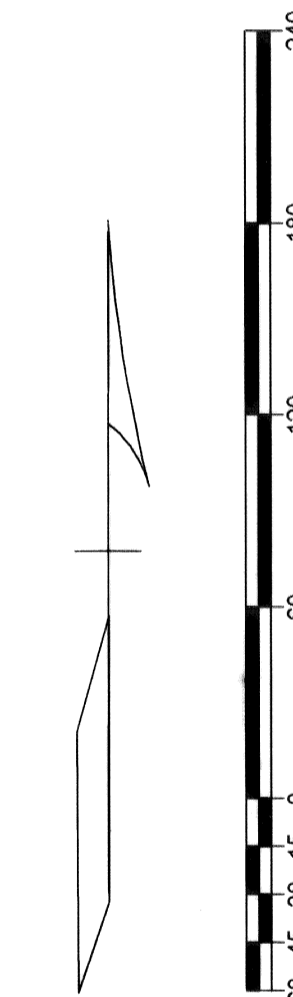
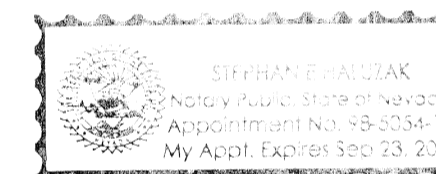

SCALE: 1" = 60'

115182

RECORDERS CERTIFICATE:

FILE NO. 115182
recorded at the request of
Lenard D. Smith
Date Sept. 7, 2000 at 2:20 p.m.
Plat book B, Page 335
Lincoln County, Nevada
Leslie Boucher, Recorder
By *Wendee Lewis*
Deputy

LEGEND

- SS— Sanitary sewer location
- V— Underground power location
- W— 8" water line location
- Found 5/8" rebar stamped L. Smith PLS 12751
- Found pipe recognized property corner
- Found, rebar & cap stamped R.E. Fonger pls 4235
- Found, rebar & cap stamped pls 6204
- Set 5/8 rebar stamped L. SMITH PLS 12751

PLANNING COMMISSION

At the regular Caliente City Planning Commission Meeting held this _____ day of _____, 1999, this plat was examined and recommended for approval.
Chairman _____ Clerk or Secretary of the Commission _____

CITY COUNCIL

At the regular meeting of the Caliente City Council held this _____ day of _____, 2000, this plat was approved for recordation. The streets offered for dedication for public use have been (Initial one)

ACCEPTED DEFERRED TO A LATER DATE _____

REJECTED _____
Philip Phillips
Mayor Attest: City Clerk

BASIS OF BEARINGS

Bearings as shown on plats as recorded in Lincoln County Records Book A, Pages 263, 434, 435, and 447 as depicted hereon.

REFERENCE MAPS

Plats as recorded Plat Book A, Pages 263, 434, 435 and 447, Lincoln County Records, Nevada
Also Parcel Map Plat Book B, Page 319 of Lincoln County Records, Nevada

Lenard D. Smith
Land Survey

509 Main Street
Caliente, Nevada 89008
P.O. Box 443
Phone/Fax 775 726 3365

SUSEQUENT PARCEL MAP

PARCELS J, K, AND L
IN THE SW1/4NE1/4, NE1/4SW1/4, NW1/4SE1/4
SECTION 7, T.4S., R.67E., M.D.M., AND CITY OF
CALIENTE, LINCOLN COUNTY, NEVADA
FOR RONAL T. YOUNG

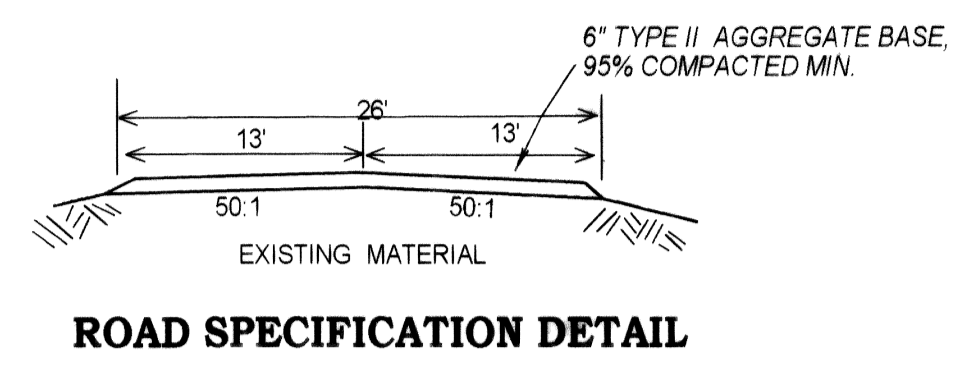

ROAD SPECIFICATION DETAIL

Cemetery
Cemetery

ROAD

KIVA ROAD
KIVA ROAD

Charles & Catherine Pyle

RANCH ROAD
RANCH ROAD

COUNTRY ROAD
COUNTRY ROAD

BASIS OF BEARINGS
BASIS OF BEARINGS

PARCEL 4B
312,389 Sq. Ft.
(7.1715 Acres)

PARCEL L
13,166 Sq. Ft.

PARCEL J
13,523 Sq. Ft.

PARCEL K
13,523 Sq. Ft.

(PARCEL 4C)

(PARCEL 4D)

(PARCEL 4E)

(PARCEL H)

(PARCEL I)

ROCKY MOUNTAIN COMPANY

Van Roekel, Glenn A. & Darlene

Wright, Sherry

Fitzsimons, Patrick & Mildred

WASH

MEADOW

Graves, Madison B. III (et. al.)

Young, Ronal Chad & Brenda

Manhole EL. 87.48

Manhole EL. 89.27

EL. 90.8

EL. 89.6 X

EL. 110.1

45.00

157.11

44.65

50.00

138.90

138.90

138.90

138.90

138.90

138.90

138.90

138.90

138.90

138.90

118.93

118.93

118.93

118.93

118.93

118.93

118.93

118.93

118.93

118.93

118.93

118.93

118.93

118.93

118.93

118.93