

SURVEYOR'S CERTIFICATE

I, Lenard D. Smith, a Professional Land Surveyor, registered in the State of Nevada, certify that:

- 1 This plat represents the results of a survey conducted under my direct supervision at the instance of Robert J. & Carol Mathews.
- 2 The lands surveyed lie within Sections 5 and 8, T.2S., R.68E., M.D.M., R.68E., Lincoln County, Nevada. The survey was completed on March 21, 2000.
- 3 This plat complies with applicable state statutes and any local ordinances in effect on the date that the governing body gave its final approval.
- 4 The monuments depicted on the plat are of the character shown, occupy the positions indicated and are of sufficient number and durability.
- 5 This map complies with all pertinent sections of NRS 278.010 to 278.630 inclusive, and 625.340 to 625.380, inclusive, and with any applicable local ordinance.

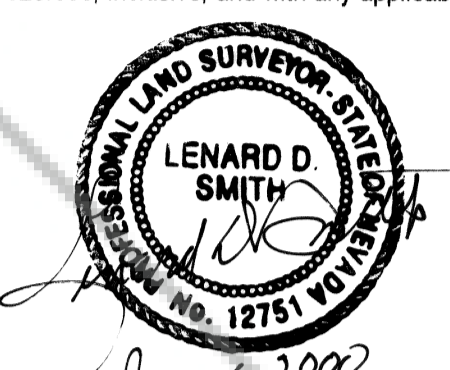

Lenard D. Smith, P.L.S. 12751

LINE DATA

line no.	bearing	distance
1	N89°54'08"E	56.22'
2	S00°06'16"W	228.40'
3	N89°40'59"W	113.75'
4	N75°17'44"W	44.32'
5	N19°11'44"E	84.21'
6	N24°55'13"E	73.14'
7	S89°58'23"E	14.40'
8	S89°58'26"E	137.00'
9	S89°58'23"E	14.40'
10	N15°52'04"E	90.04'

(DEED DISTANCES & BEARINGS OF FARMSTEAD PARCEL ARE COMPAREABLE TO THE FENCE)

BASIS OF BEARINGS

The east section 8 line, BLM Dependent Resurvey, 1995 as N.0°05'10"E. (Preliminary, not as yet approved)

MAP REFERENCES

BOUNDARY LINE ADJUSTMENT for Dan & Alice Simkins, Plat Book B, Page 165 Lincoln County Records
 PARCEL MAPS for Ray and/or Ferne Carter Plat Book A Pages 261 284, and Plat Book B, Page 131 of Lincoln County, Nevada Records.
 RECORD OF SURVEY for Panaca Farmstead Association Plat Book A, Page 436 of Lincoln County, Nevada Records.

EXHIBIT A PARCELS in DEED of REAL ESTATE DEEDS BK. 109, Pg. 413, LINCOLN COUNTY RECORDS

PARCEL No.	ACREAGE
I	53.66
II	26.06
III	21.75
IV	36.81
V	12.26
VI	39.97
VII	8.62
TOTAL	199.13

BASIS OF BEARINGS

BLM DEPENDENT RESURVEY, NE corner to the SE corner, S1/4 Section 17 (this BLM survey is PRELIMINARY, and not as yet approved)

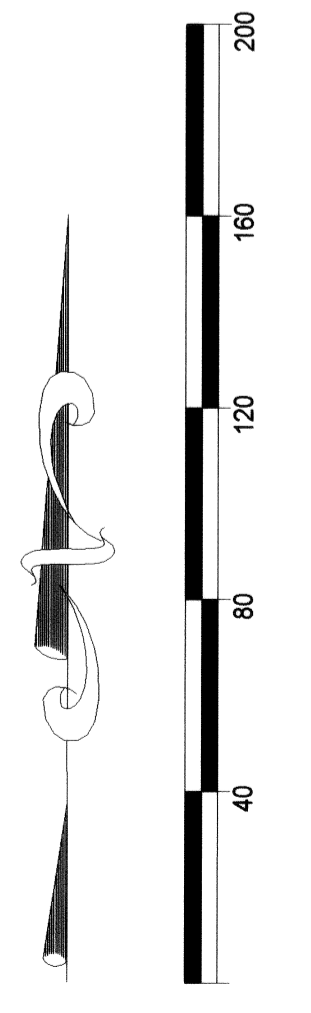

SCALE: 1 inch = 400 feet

LEGEND

- Set 5/8 rebar & cap stamped L SMITH PLS 12751
- Set 5/8" rebar & aluminum cap stamped L SMITH PLS 12751
- Found 5/8" rebar & cap stamped L SMITH PLS 12751
- Found 5/8" rebar & alum cap stamped RE FONGER PLS 4235
- Not found, monuments set for Parcels (in cultivated field)
- Found 5/8" rebar & cap stamped PLS 6204

<p>RECORDER'S CERTIFICATE File number 114636 Filed at the request of Lenard D. Smith Filed Plat Book B, Page <u>310</u> of Lincoln County, Nevada Records. Date <u>June 6, 2000</u> at <u>3:35</u> p.m. LESLIE BOUCHER, Recorder <i>Teresa Severs</i> Deputy</p>	<p>RECORD OF SURVEY File No. 114403 Filed at the request of Lenard D. Smith Filed Plat Book B, Page 304, Lincoln County Records Date April 25, 2000 at 4:45 p.m. LESLIE BOUCHER, RECORDER By <i>Teresa Severs</i> Deputy</p>
---	--

AMENDED PLAT OF RECORD OF SURVEY PLAT BOOK B, PAGE 304

ROBERT J. & CAROL MATHEWS FARM

IN SECTIONS 5 AND 8, T.2S., R.68E., M.D.M. NEAR PANAACA, LINCOLN COUNTY, NEVA

