

SURVEYOR'S CERTIFICATE

I, James J. Owens, a Professional Land Surveyor registered in the State of Nevada, do hereby certify that :

- This Plat represents the results of a survey conducted by me, or under my direct supervision at the instance of Mark & Linda Holt, owners.
- The lands surveyed is a Division of Parcel No. 1 of Parcel Map Book Plat 'B', Page 89, in Sec. 8, T. 4 S., R. 67 E., M.D.M., City of Caliente, Lincoln County, Nevada, and the survey was completed on March 9, 2000.
- This plat complies with the applicable state statutes and any local ordinances in effect on the date that the Governing Body gave its final approval.
- The monuments depicted on this plat are of the character shown, occupy the positions indicated and are of sufficient number and durability.

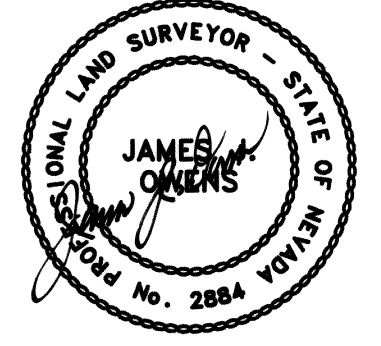

OWNER'S CERTIFICATE

We, Mark & Linda Holt, do hereby certify that we are the owners of the land hereon shown, that we have caused this property to be platted into parcels, and easements as shown and, do hereby dedicate all shown public utility easements to the public utility agencies for the construction and maintenance of surface and or subterranean utilities, and do hereby consent to the preparation and recordation of this parcel map.

Mark R. Holt 6-2-00 Linda J. Holt 6-2-00
 Mark Holt Date Linda Holt Date

ACKNOWLEDGEMENT

State of Nevada SS
 County of Lincoln SS
 This instrument was acknowledged before me on this 2nd day of June, 2000, by Mark Holt & Linda Holt.

Stephanie Haluzak
 My commission expires on 10th day of June, 2002.

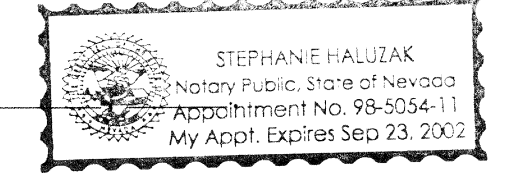

CITY OF CALIENTE APPROVAL

This map has been reviewed and approved on this 20th day of April, 2000, by the City of Caliente City Council as a Parcel Map.

Kevin Phillip 4/20/00
 Mayor Date
Deanna Willet 04/20/00
 Attest : Clerk Date

CITY OF CALIENTE ZONING AND PLANNING APPROVAL

This is to certify that the Board of the City of Caliente Planning Commission, Lincoln County, Nevada, did on this 20th day of April, 2000, approve for purposes of land division and accept in behalf of the public, this map and any parcels of land offered for dedication for public use in conformity with the terms of the of dedication as per N.R.S. 278.010 through 278.630, inclusive.

Nicki M. Rustafson, Temp Chair 4/20/00
 Chairman Date
 City of Caliente Planning Commission

BASIS OF BEARING

The Basis of Bearing was established by G.P.S., using a known NAD83, Coordinate on a U.S.G.S., control station described as "COVE".

STATEMENT

Any Subsequent changes to this map should be examined and may be determined by reference to the County Recorder's Cumulative Map Index, N.R.S. 278.5695.

REFERENCE MAPS

- Parcel Map Book Plat 'B', Page 89, dated 02/06/98.

LEGEND

- Set 1/2" rebar w/ plastic cap marked "HULSE PLS 6498".
- Found 1/2" rebar w/ plastic cap marked "HULSE PLS 6498".
- ⊕ Found Sec. Cor., as noted.

SUBSEQUENT PARCEL MAP		No. 114627
for Mark & Linda Holt		Filed at the Request of : The Owens Surveying Outfit, Inc.
A Division of Parcel 1 of Parcel Map Book Plat 'B', Page 89, Sited within Sec. 8, T. 4 S., R. 67 E., M.D.M., City of Caliente, Lincoln County, Nevada		Date <u>June 2, 2000</u> At <u>4:17 pm.</u>
THE OWENS SURVEYING OUTFIT, INC. Water Right, Mineral & Land Surveying throughout the West P.O. Box 540 99 W. Hollywood Pioche, Nevada 89043 Tel : 775-962-5115 Fax : 775-962-5116		Book Plat <u>B</u> Page <u>309</u>
Official Records Lincoln County, Nevada <u>Leslie Boucher</u> Leslie Boucher, Recorder <u>Teresa Stevers</u> Deputy		Fee <u>17.00</u>

Nev-123
 S. Hafen