

**SURVEYOR'S CERTIFICATE**

I, Lenard D. Smith, a Professional Land Surveyor registered in the State of Nevada certify that:

1. This plat represents the results of a survey conducted under my supervision at the instance of David & George Corley.
2. The land surveyed lies within Section 9, T.2S., R.68E., M.D.M., in the Town of Panaca, Lincoln County, Nevada. The survey was completed on April 6, 2000.
3. This plat complies with applicable statutes of this state and any local ordinances in effect on the date that the survey was completed, and the survey was conducted in accordance with Chapter 625 of the Nevada Administrative Code.
4. The monuments depicted on the plat are of the character shown, occupy the positions indicated, and are of sufficient durability.

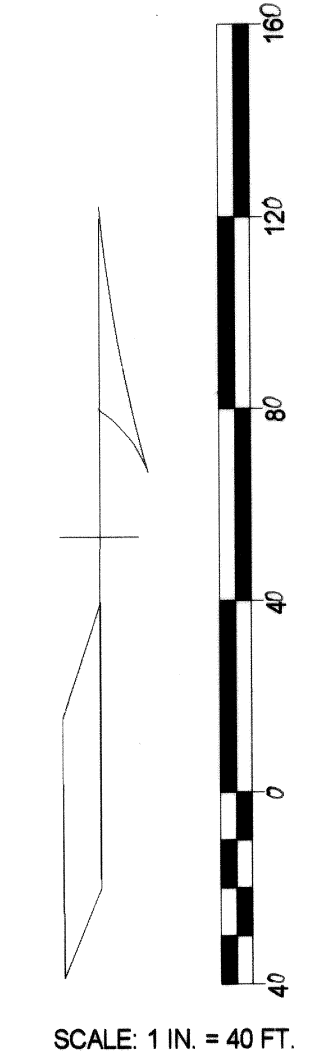
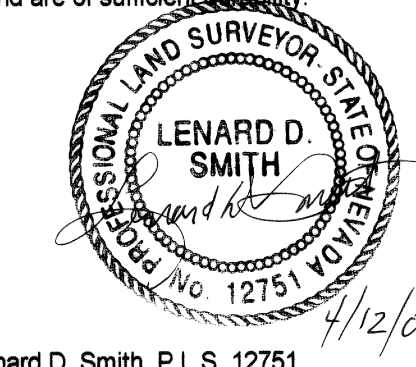

**LEGEND**

- Set 5/8" rebar & cap stamped L SMITH PLS 12751
- Found rebar & cap stamped F. Hukise PLS 6498

**BASIS OF BEARINGS:**

The west half of the center of section 9 as monumented by the Standard B.L.M. BRASS CAPS (not as yet an approved survey) as shown on the Town of Panaca Annexation Map Recorded in Book B, Page 90 of Lincoln County Records. The Bearing shown is S89°18'40"W.

**RECORDER'S CERTIFICATE**

File Number **114404**  
 Recorded at the request of Lenard D. Smith  
 Filed Plat Book B, Page **305**  
 of Lincoln County, Nevada Records  
 Filed this **25<sup>th</sup>** day of **April**  
 2000, at **4:46** p.m.  
 LESLIE BOUCHER, RECORDER  
 By *Jenessa Leewers*

**RECORD OF SURVEY**

**IN LOT ONE, BLOCK 36 OF THE  
 TOWN OF PANACA, LINCOLN COUNTY  
 NEVADA  
 IN THE NW1/4 OF SECTION 9,  
 T.2S., R.68E., M.D.M.**

**FOR DAVID B. & GEORGE A. CORLEY**

