

SURVEYOR'S CERTIFICATE

I, James J. Owens, a Professional Land Surveyor registered in the State of Nevada, do hereby certify that:

- This Plat represents the results of a survey conducted by me, or under my direct supervision at the instance of The United State Postal Service.
- The lands surveyed lie within Lots 1, 2 & 3 of Block 'A', of the West End Addition to the City of Caliente, Sec.'s 7 & 8, T. 4 S., R. 67 E., M.D.M., City of Caliente, Lincoln County, Nevada, and the survey was completed on Feb. 04, 2000.
- This plat complies with the applicable state statutes and any local ordinances in effect on the date that the Governing Body gave its final approval.
- The monuments depicted on this plat are of the character shown, occupy the positions indicated and are of sufficient number and durability.

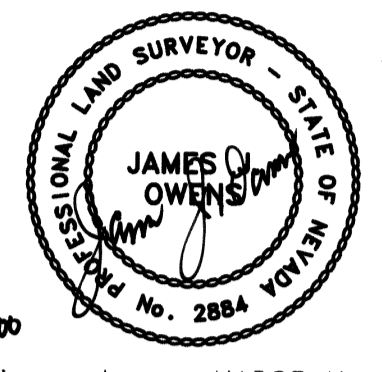

BASIS OF BEARING

The Basis of Bearing was established by G.P.S., using a known NAD83 Nevada State Plane (East Zone) Coordinate on a U.S.G.S. control station described as "COVE".

STATEMENT

Any Subsequent changes to this map should be examined and may be determined by reference to the County Recorder's Cumulative Map Index, N.R.S. 278.5695.

REFERENCE MAPS

- Map of the West End Addition recorded in Book Plat 'A', Page 44, dated 10/06/26.

LEGEND

- Set 1/2" rebar w/ plastic cap marked "OWENS PLS 2884".
- Existing Power Pole
- ⊗ Existing Fire Hydrant
- ⊙ Existing Sewer Man Hole
- t— Existing Underground Telephone Line
- w— Existing Underground Water Line (as noted)
- p— Existing Overhead Power Line
- s— Existing Underground Sewer Line (as noted)

LEGAL DESCRIPTION

Lots 1, 2 & 3 of Block 'A', of the West End Addition as recorded in Book Plat 'A', Page 44, dated 10/06/26, situated in the City of Caliente, County of Lincoln, State of Nevada.

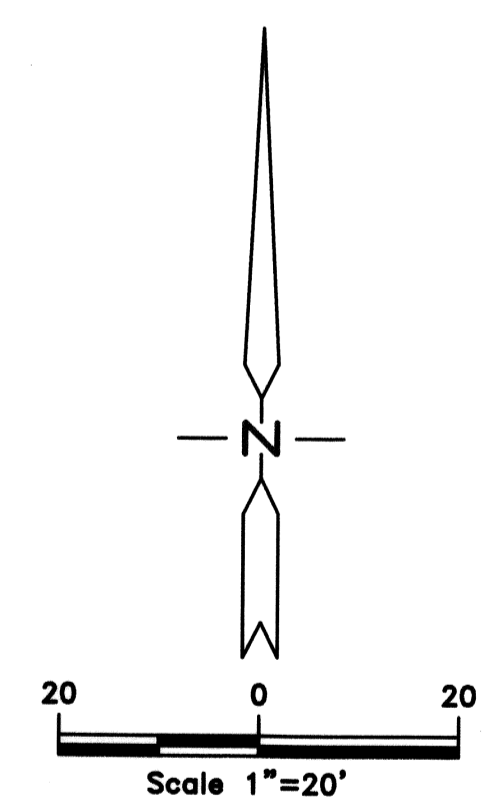

RECORD OF SURVEY		No. 114174
for the United State Postal Service		Filed at the Request of: The Owens Surveying Outfit, Inc.
Situating within Lots 1, 2 & 3 of Block 'A', of the West End Addition, Sec.'s 7 & 8, T. 4 S., R. 67 E., M.D.M., City of Caliente, Lincoln County, Nevada		Date: Feb. 20, 2000 11:03 am
THE OWENS SURVEYING OUTFIT, INC. <small>Water Right, Mineral & Land Surveying throughout the West</small>		Book Plat B Page 291
P.O. Box 540 99 W. Hollywood Piache, Nevada 89043 Tel : 775-962-5115 Fax : 775-962-5116		Official Records Lincoln County, Nevada Leslie Boucher Leslie Boucher, Recorder Teressa Seewers Deputy Fee 17.00

Nev-296
S. Hafen