

SURVEYOR'S CERTIFICATE

I, James J. Owens, a Professional Land Surveyor registered in the State of Nevada, do hereby certify that:

- This Plat represents the results of a survey conducted by me, or under my direct supervision at the instance of First Security Trust Company of Nevada.
- The lands surveyed lie within the NW1/4 SE1/4 of Sec. 30, T. 6 S., R. 61 E., M.D.M., Lincoln County, Nevada, and the survey was completed on Dec. 10, 1999.
- This plat complies with the applicable state statutes and any local ordinances in effect on the date that the Governing Body gave its final approval.
- The monuments depicted on this plat are of the character shown, occupy the positions indicated and are of sufficient number and durability.

BASIS OF BEARING

The Basis of Bearing was established by G.P.S., using a known NAD83 Nevada State Plane (East Zone) Coordinate at a U.S.G.S. control station described as "COVE".

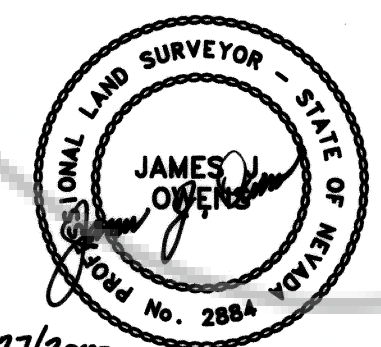

STATEMENT

Any Subsequent changes to this map should be examined and may be determined by reference to the County Recorder's Cumulative Map Index, N.R.S. 278.5695.

REFERENCE MAPS

- Record of Survey Book Plat 'B', Page 31, dated 04/07/97, by B.B.E. PLS 8625.
- Record of Survey Book Plat 'B', Page 130, dated 06/19/98, by L. Smith PLS 12751.
- Record of Survey Book Plat 'B', Page 134, dated 07/06/98, by L. Smith PLS 12751.
- Amended Record of Survey Book Plat 'B', Page 166, dated 12/01/98, by L. Smith PLS 12751.

LEGEND

- Set 1/2" rebar w/ plastic cap marked "OWENS PLS 2884".
- Set 2.5" Alum. Cap marked "OWENS PLS 2884".
- Found rebar w/ cap marked "SMITH PLS 12751".
- Found Brass Shiner stamped "BBE, Inc. PLS 8625".
- Found Alum. Cap stamped "HAFEN PLS 4428", unless otherwise noted.
- (D) = Data taken from Deed.
- (M) = Measured Data by The Owens Surveying Outfit, PLS 2884.
- (S) = Recorded Data by Lenard Smith, PLS 12751.
- (BBE) = Recorded Data by Bulloch Bros. Engineering, PLS 8625.

Section Breakdown of Sec. 30, T. 6 S., R. 61 E., M.D.M.

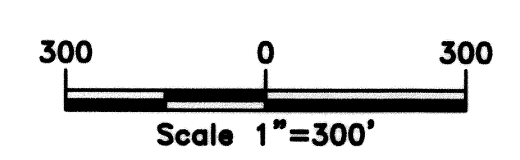

<p>RECORD OF SURVEY</p> <p>for</p> <p>First Security Trust Company of Nevada</p> <p>Situated within the NW1/4 SE1/4 Sec. 30, T. 6 S., R. 61 E., M.D.M., Lincoln County, Nevada</p>		<p>No. 113890</p> <p>Filed at the Request of: The Owens Surveying Outfit, Inc.</p> <p>Date Jan 27, 2000 at 4:45pm</p> <p>Book Plat B Page 283</p> <p>Official Records Lincoln County, Nevada</p> <p><i>Leslie Boucher</i> Leslie Boucher, Recorder</p> <p>Deputy</p> <p>Fee 17.00</p>
<p>THE OWENS SURVEYING OUTFIT, INC.</p> <p>Water Right, Mineral & Land Surveying throughout the West</p> <p>P.O. Box 540 99 W. Hollywood Picche, Nevada 89043 Tel : 775-962-5115 Fax : 775-962-5116</p>		<p>Nav-285</p> <p>S. Hafen</p>