

**SURVEYOR'S CERTIFICATE**

I, James J. Owens, a Professional Land Surveyor registered in the State of Nevada, do hereby certify that:

1. This Plat represents the results of a survey conducted by me, or under my direct supervision at the instance of Larry F. & Nadine Packer, owners.
2. The lands surveyed lie within the NW1/4, SE1/4 of Sec. 5, T. 7 S., R. 61 E., M.D.M., Town of Alamo, Lincoln County, Nevada, and the survey was completed on Oct. 1, 1999.
3. This plat complies with the applicable state statutes and any local ordinances in effect on the date that the Governing Body gave its final approval.
4. The monuments depicted on this plat are of the character shown, occupy the positions indicated and are of sufficient number and durability.

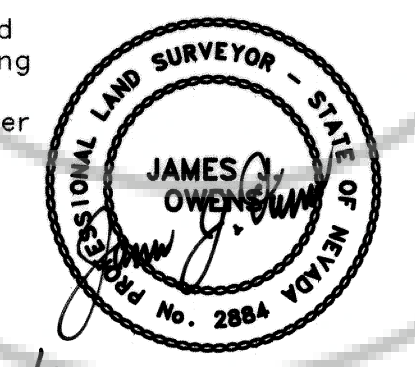

**BASIS OF BEARING**

The Basis of Bearing was established by G.P.S., using a known NAD83 Nevada State Plane (East Zone) Coordinate on a U.S.G.S., control station described as "CORRAL".

**REFERENCE MAPS**

1. Map of the Alamo Townsite, Book Plat 'A', Page 41.

**LEGEND**

- Set 1/2" rebar w/ plastic cap marked "OWENS PLS 2884".
- Found C1/4 Cor. as noted.
- ⊙ Found 1/4 Sec. Cor. as noted.

**STATEMENT**

Any Subsequent changes to this map should be examined and may be determined by reference to the County Recorder's Cumulative Map Index, N.R.S. 278.5695.

<b>RECORD OF SURVEY</b>		No. <b>11373</b>
for <b>Larry F. &amp; Nadine Packer</b>		Filed at the Request of: The Owens Surveying Outfit, Inc.
Sited within the NW1/4 SE1/4 Sec. 5, T. 7 S., R. 61 E., M.D.M., Town of Alamo, Lincoln County, Nevada		Date <b>Dec 8, 1999</b> At <b>9:27 A.M.</b>
<b>THE OWENS SURVEYING OUTFIT, INC.</b> <small>Water Right, Mineral &amp; Land Surveying Throughout the West</small>		Book Plat <b>B</b> Page <b>262</b>
P.O. Box 540 99 W. Hollywood Pioche, Nevada 89043 Tel : 775-962-5115 Fax : 775-962-5116		Official Records Lincoln County, Nevada <b>Leslie Boucher</b> Recorder <b>Terisa Stevers</b> Deputy
Nev-242 S. Hafen		Fee <b>17.<sup>00</sup></b>