

QUITCLAIM DEED OF MINING CLAIM

By this instrument dated September 1, 1999, for a valuable consideration,

NEVASCO RESOURCES GROUP does hereby REMISE, RELEASE, and FOREVER QUITCLAIM to SOVEREIGN DEPOSITORY CORPORATION the following real property in the State of Nevada, County of Lincoln:

Described in full detail with location maps in Schedule "A" attached herewith and forms part of this Quitclaim.

Claim Name: Gad

Lincoln County Record #: 105865

State of Nevada)
) ss.
County of Clark)

NEVASCO RESOURCES GROUP

PER 

On September 1, 1999 before me, the undersigned, a Notary Public in and for said County and State personally appeared DARONNE BONNEAU known to me to be the person who subscribed to the within instrument, and acknowledged to me that he executed the same.

WITNESS my hand and Official Seal,



D.L. KOLLPAINTER
Notary Public - Nevada
My appl. exp. Aug. 9, 2000
No. 36-4022-1

Notary Public/Commissioned for said
County and State

AFTER RECORDING MAIL TO:

SOVEREIGN DEPOSITORY CORPORATION
302 E. Carson Avenue, Suite 1002
Las Vegas, Nevada 89101

QUITCLAIM DEED OF MINING CLAIM

By this instrument dated May 29, 1998, for a valuable consideration,

FIDELITY INTERNATIONAL LTD. does hereby **REMISE, RELEASE, and FOREVER QUITCLAIM** to **NEVASCO RESOURCES GROUP** the following real property in the State of Nevada, County of Lincoln:

Described in full detail with location maps in Schedule "A" attached herewith and forms part of this Quitclaim.

Claim Name: Gad

Lincoln County Record #: 105865

State of Nevada)
) ss.
County of Clark)

FIDELITY INTERNATIONAL LTD.

PER 

On May 29, 1998 before me, the undersigned, a Notary Public in and for said County and State personally appeared **DARONNE BONNEAU** known to me to be the person who subscribed to the within instrument, and acknowledged to me that he executed the same.

WITNESS my hand and Official Seal,



Notary Public Commissioned for said
County and State

AFTER RECORDING MAIL TO
NEVASCO RESOURCES GROUP
1055 E. Tropicana, Suite 430
Las Vegas, Nevada 89119

QUITCLAIM DEED OF MINING CLAIM

By this instrument dated September 3, 1996, for a valuable consideration,

CAPITAUX NEVADA CORPORATION does hereby REMISE, RELEASE, and FOREVER QUITCLAIM to FIDELITY INTERNATIONAL LTD. the following real property in the State of Nevada, County of Lincoln:

Described in full detail with location maps in Schedule "A" attached herewith and forms part of this Quitclaim.

Claim Name: Gad Lincoln County Record #: 104041

State of Nevada)	CAPITAUX NEVADA CORPORATION
) ss.	
County of Clark)	PER <u>[Signature]</u>

On September 3, 1996 before me, the undersigned, a Notary Public in and for said County and State personally appeared DARONNE BONNEAU known to me to be the person who subscribed to the within instrument, and acknowledged to me that he executed the same.

WITNESS my hand and Official Seal,

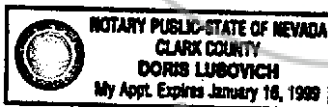

[Signature: Doris Lubovich]
Notary Public Commissioned for said
County and State

AFTER RECORDING MAIL TO
FIDELITY INTERNATIONAL LTD.
% Porter Construction Company
5615 S. Cameron, Suite 3
Las Vegas, Nevada 89118

NO. **105865**
Filed and Recorded at the request of
Joseph Pigeon on September 3, 1996
at 10 minutes past 3 o'clock in Book
120, Page 552, Official Records
Lincoln County Nevada.
Yuriko Setzer, Recorder
by [Signature], deputy

I hereby certify that the foregoing is
a full and correct copy of the original
document now of record in this office,
in book 120 of Records page 552
of Lincoln County Nevada.

Date: Sept. 3, 1996
Recorder Yuriko Setzer

BOOK **120** PAGE **552**

BOOK **144** PAGE **112**

Lincoln County

Certificate of Location of Lode Mining Claim

TO ALL WHOM IT MAY CONCERN:

The undersigned hereby certified (certify) that he (she, they) has (have) located the God Lode Mining Claim in Section SE 1/4 of 17, Township 4, Range 59 East in the Mt. Irish Mining District, in Lincoln County, in the State of Nevada, on the 11th day of September, 1995.

The name and address of the owner of the claim is Capitaux Nevada Corporation at 2211 Paradise Road, Las Vegas Nevada 89104

The name(s) and post office address(es) of the locator(s) for Capitaux Nevada Corp. (are):

Mark Gilcrest	2211 Paradise Road, Las Vegas, NV 89104
(Name)	(Post Office Address)
Jemison Surveying Services	7310 Smoke Ranch Ste B, Las Vegas, NV 89128
Jaime Gonzalez	7310 Smoke Ranch Ste B, Las Vegas, NV 89128
Roy Jemison	7310 Smoke Ranch Ste B, Las Vegas, NV 89128

The claim is 1500 feet long and 600 feet wide, and 750 feet is claimed in a Northerly direction and 750 feet in a Southerly direction from the location monument, at which the Notice of Location is posted, lengthwise of the claim, together with 300 feet in width on each side of the center of the claim. The general course of the lode deposit and premises is from the North to the South.

The location and number of each corner of this claim is shown on the claim map that is filed herewith. On the ground, each corner of the claim is marked with its appropriate number by Staking a Ziplock bag to post.

(Describe method of marking, such as "scribing the wood")

The description of each corner is as follows (describe the corner(s)), such as "4x4 wooden post":

- Corner No. 1 is a Distance of 1500' to NW Corner No. 3
- Corner No. 2 is a _____
- Corner No. 3 is a Distance of 600' to NE Corner No. 4
- Corner No. 4 is a Distance of 1500' to SE Corner No. 6
- Corner No. 5 is a _____
- Corner No. 6 is a Distance of 600' to Point of Beginning

The monumentation and marking of the corners was completed by the 11th day of September, 1995.
(Must be within 20 days of posting notice of location)

The location work consisted of making a claim map as provided in NRS 517.040. Two copies of this claim map have been filed with the Lincoln County Recorder, and the \$15.00 lode claim filing fee has been paid to the County Recorder.

Dated this 11th day of September, 1995.

Agents/Locators on behalf of Capitaux Nevada Corporation:

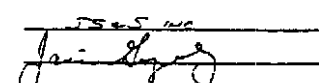
	
(Locator sign here)	

Note 1: Two copies of this certificate and two copies of the claim map must be filed, and the \$15 filing fee must be paid, within 90 days after the date of posting Notice of Location.

Note 2: "Every person who willfully and knowingly makes a false material statement on the location certificate or on any map required by this chapter shall be guilty of a felony, and upon conviction thereof shall be imprisoned in the state prison for not less than 3 years nor more than 10 years." NRS 517.300, Subsection 2.

Note 3: The claim map of this claim is filed in the Lincoln County Recorder's Office as Document No. 104041 (may be filled in by locator).

RECORDER'S STAMP

NO 104040
 Filed and recorded at the request of Capitaux Nevada Corp. on October 5, 1995 at 20 minutes past 9 o'clock a.m. in Book 113, Page 327, Official Records, Lincoln County Nevada.

Turiko Jetter Recorder



Lincoln County

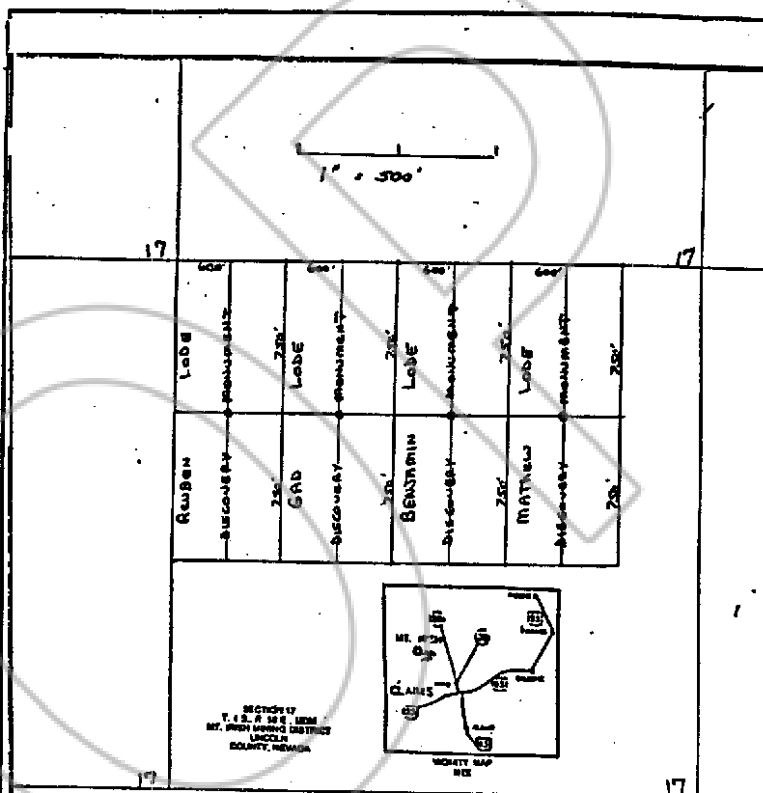

Describe here the position of the Claim Location Monument, if one is used.

Map of the GAD Mining Claim Group.
 in Section SE 24 Township, 4 Range S9
 in the MOUNT IRISH Mining District,
Lincoln County, Nevada.

Located on the 11 day of SEPT, 1995, by
MARK GREENST Esq.
 Locator name and address (please print)
CAPITAUX Nevada Corp.
224 Paradise Road
Las Vegas Nevada 89104

RECORDERS STAMP
 NO 104041
 Filed and recorded at the request
 of Capitaux Nevada Corp. on
 October 3, 1995 at 20 minutes
 past 3 o'clock a.m. in Book 115,
 Page 328, Official Records,
 Lincoln County Nevada.
 Yuriko Saezer
 Recorder
Julie Boucher
 Deputy

CARLISLE FARM INC, DE RLY

COPY

113398

NO.

FILED AND RECORDED AT REQUEST OF
Clarence E. Gamble Esq.
Sept. 23, 1999

AT 55 MINUTES PAST 04 O'CLOCK
PM IN BOOK 144 OF OFFICIAL
RECORDS PAGE 110 LINCOLN
COUNTY, NEVADA.

Leslie Boucher
COUNTY RECORDER
By Dereasa Deputy