

**OWNER'S CERTIFICATE FOR EASEMENT**

We, the undersigned certify that we are the owners of lands crossed by a 40 ft. easement for ingress and egress to the properties of Lamont and Annette Wadsworth, and that we grant said easement as it is presented on this plat.

*Charles E. Wadsworth Jr.*  
Charles E. Wadsworth Jr.  
*Verla Wadsworth*  
Verla Wadsworth

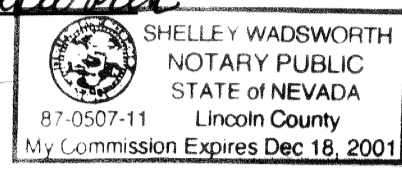

**ACKNOWLEDGEMENT**

This is to certify that the above persons appeared before me, a Notary Public and executed the certificate for the purposes stated.

*Wendy Rudder*  
Notary Public

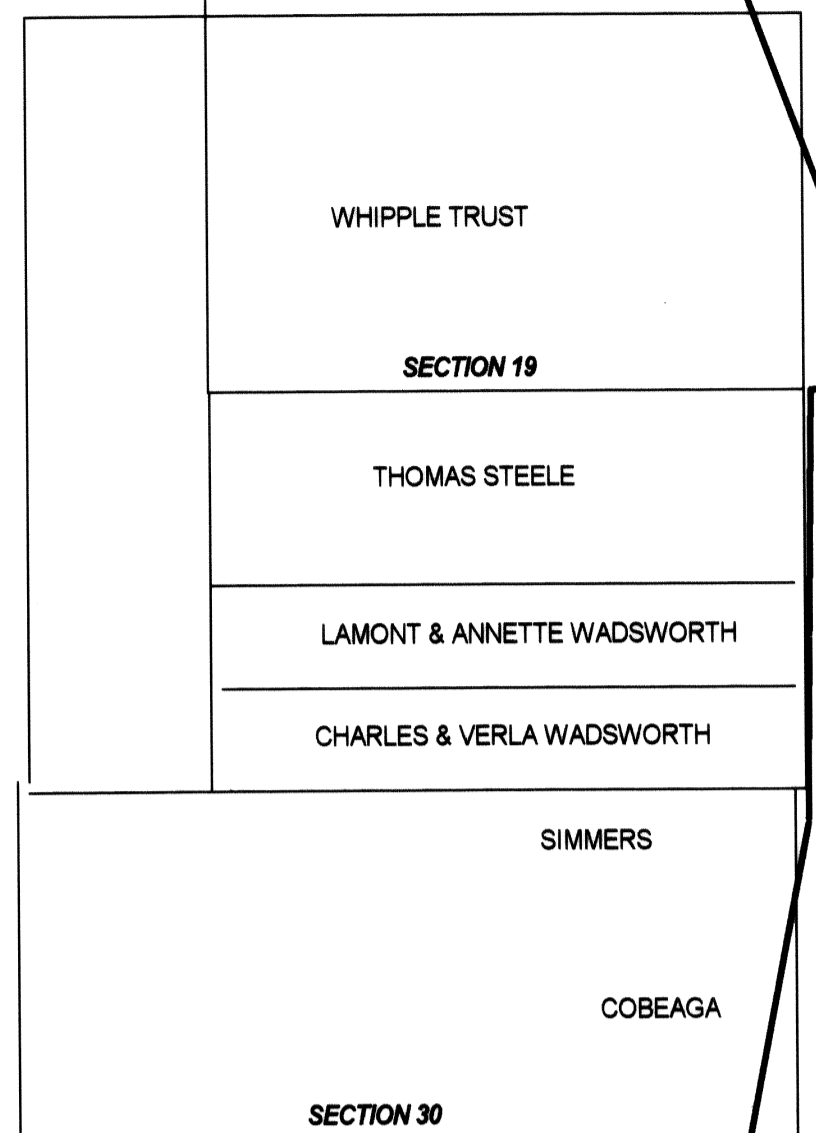
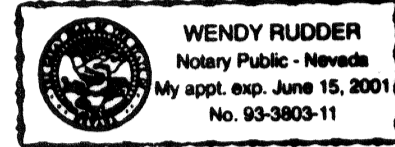

**VICINITY MAP**  
NOT TO SCALE

**PLANNING COMMISSION**

At their regular meeting of the Lincoln County Planning Commission held this 12<sup>th</sup> day of July 1999, this plat was examined and was recommended for approval.  
*Verla Wadsworth*  
CHAIRMAN

**COUNTY COMMISSION**

At the regular meeting of the Lincoln County Board of Commissioners held this 3<sup>rd</sup> day of August 1999, this plat was examined and approved for recordation.  
*Tom Tubby*  
CHAIRMAN  
*Alan Foster*  
ATTEST, COUNTY CLERK

**LEGEND**

● Set 5/8" rebar with cap stamped L SMITH pls 12751

**SURVEYOR'S CERTIFICATE**

I, Lenard D. Smith, a Professional Land Surveyor registered in the State of Nevada certify that:  
1. This plat represents the results of a survey conducted under my direct supervision at the instance of Lamont Wadsworth.  
2. The lands surveyed lie within Section 19, T.6S., R. 61E., M.D.M. in Lincoln County, Nevada, and the survey was completed on January 22, 1999.  
3. This plat complies with the applicable state statutes and any local ordinances in effect on the date that the governing body gave its final approval.  
4. The monuments depicted on the plat are of the character shown, occupy the positions indicated and are of sufficient number and durability.

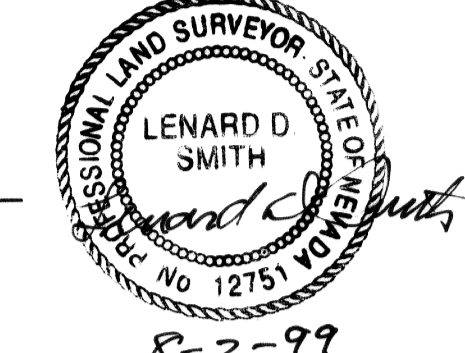

*Lenard D. Smith*  
Lenard D. Smith, PLS 12751

**OWNER'S CERTIFICATE**

We, the undersigned certify that we are the owners of the lands depicted on this plat and that we have requested Lenard D. Smith, a Professional Land Surveyor to prepare this plat for recordation.

*Lamont Wadsworth*  
Lamont Wadsworth  
*Annette Wadsworth*  
Annette Wadsworth

**ACKNOWLEDGEMENT**

State of Nevada ) ss  
County of Lincoln )

This is to certify that Lamont Wadsworth and Annette Wadsworth personally appeared before me and executed the owners certificate freely and voluntarily for the purposes stated.

*Wendy Rudder*  
Notary Public

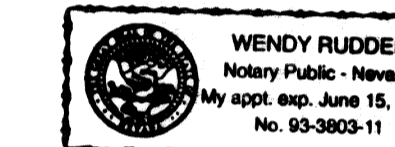

**MAP REFERENCES**

This map is based on the RECORD OF SURVEY, Plat Book B, Page 231 and other references listed in it.

**DESCRIPTION**

Parcel 1A located within Parcel 1 of the Parcel Map Plat Book A, Page 468 of Lincoln County Records in the SE1/4SW1/4 Section 19, T.6S., R.61E., M.D.M., Lincoln County Nevada, and particularly described as follows:  
Beginning at a point from which the SW corner of said Section 19 bears S56°23'24"W., 2,109.45 ft.;  
Thence, N 3°44'02"W, 227.20 ft.;  
Thence, N89°45'25"E, 494.63 ft.;  
Thence, S 35°13'05"W, 223.58 ft.;  
Thence, S 82°30'24"W, 353.91 ft. to the point of beginning.  
Containing 85,156 sq. ft. (1.955 acres).  
Together with a forty foot easement for ingress and egress to the left of a line described as follows:  
Beginning at a point on the westerly boundary of Parcel 1A described above, from which the SW corner of said parcel 1A bears N3°44'02"W, 110.00"; Thence S77°43'04"W, 116.46"; thence S20°52'07"W, 308.21"; thence S38°08'05"E 110.23"; thence N81°01'33"E 597.23"; thence S80°36'35"E 135.54"; thence S54°40'42"E 645.65"; thence S30°19'25"E 221.15"; thence S1°17'12"W 272.54' to an existing easement.  
Basis of bearings being the south section line of said section 19 depicted in Plat Book B, Page 130 and amended on Plat Book B, Page 166 also of Lincoln Co. Records.  
\* = monumented by a 5/8" rebar & cap stamped L SMITH 12751.  
End of description.

B.L.M.

**RECORDER'S CERTIFICATE**

File No. 113147  
Recorded at the request of  
Lamont Wadsworth  
Date Aug 3, 1999 at 9:30 A.M.  
Filed Plat Book B, Page 236  
of Lincoln County Records  
Leslie Boucher, Recorder  
By *Leslie Boucher*, Deputy

**PARCEL MAP**

**FOR LAMONT AND ANNETTE WADSWORTH**  
**IN THE S1/2 SECTION 19, T.6S. R.61E., M.D.M.,**  
**IN LINCOLN COUNTY, NEVADA**

