

R = Record Course and Distance
 ● = Found: 5/8" rebar with 1" cap stamped P.L.S. No. 12751
 ○ = Found: 5/8" rebar with 1" cap stamped P.L.S. No. 6204
 ● = Set: 5/8" rebar with 1" cap stamped P.L.S. No. 9392

Reference deeds and map on file in the Lincoln County Recorder's Office
 Record of Survey for Jimmie Rosa, filed July 3, 1996 under File No. 105430.
 Deed recorded for Jimmie Rosa, filed February 28, 1963 in Book M-1, Page 101.
 Deed recorded for Jimmie Rosa, filed May 31, 1966 in Book N-1, Page 313.
 Reference survey plat & Notes on file with the BLM
 Dependent Resurvey of T.1 N., R.69 E., M.D.B. & M. accepted November 22, 1976.

NOTES:
 No record maps are on file with Lincoln County for the PLS caps No. 12751 found in SW1/4 SE1/4 of Section 16
 This map shows 328.49 acres of land owned by Jimmie Rosa.
 There were no Right-of-way documents found for the roads shown on this map crossing the Jimmie Rosa property.
 An unrecorded map, by Mr. Lee, PLS 1730, of the SW1/4 SE1/4 of Section 16, was used for proportioning. An altered copy of said map is on file in Book 130 on Page 353, Lincoln County Recorder's Office.

SURVEYOR'S CERTIFICATE

I, Dean Neubaer, a Professional Land Surveyor registered in the State of Nevada, certify that:
 1. This plat represents the results of a survey conducted under my supervision at the instance of Jimmie Rosa.
 2. The lands surveyed lie within Sections 16, 21 & 28, T.1 N., R.69 E., M.D.B. & M., Lincoln County, Nevada and the survey was completed on the 27th day of May, 1999.
 3. This plat complies with applicable statutes of this state and any local ordinances in effect on the date the survey was completed, and the survey was conducted in accordance with Chapter 625 of the Nevada Administrative Code.
 4. The monuments depicted on the plat are of the character shown, occupy the positions indicated, and are of sufficient durability.
 Date: **5-28-99**
 Dean Neubaer, P.L.S.
 Nevada No. 9392

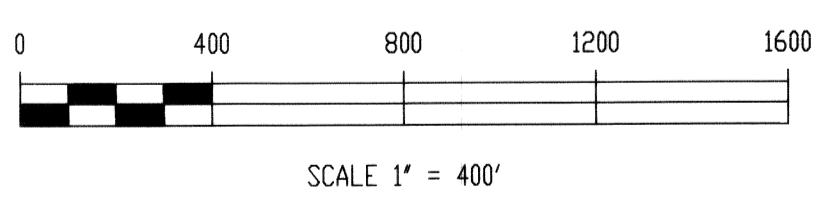
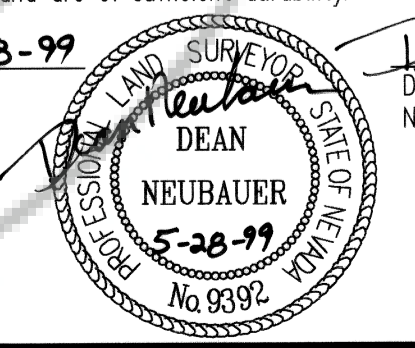

BASES OF BEARING
 EAST LINE OF THE SW1/4 OF SEC. 21
 N. 00°11'58" E.
 FROM 2cm GPS, WGS84

FILED AT THE REQUEST OF Jimmie Rosa June 2, 1999. AT 30 MIN PAST 11 AM O'CLOCK BOOK B pg 277 FILES OF LINCOLN COUNTY, NEVADA Leslie Boucher Recorder Lorise Lewers Deputy File No. 112884		BFI BOUNDY & FORMAN, INC. MAY, 1999. P.O. BOX 150, ELY, NEVADA, 89301, (775)289-8835 CIVIL ENGINEERS, LAND & WATER RIGHT SURVEYORS RECORD OF SURVEY SHOWING LAND SURVEYED FOR JIMMIE ROSA IN Sections 16, 21 & 28, T.1 N., R.69 E., M.D.B. & M. LINCOLN COUNTY, NEVADA
--	--	---

227