

Lincoln County

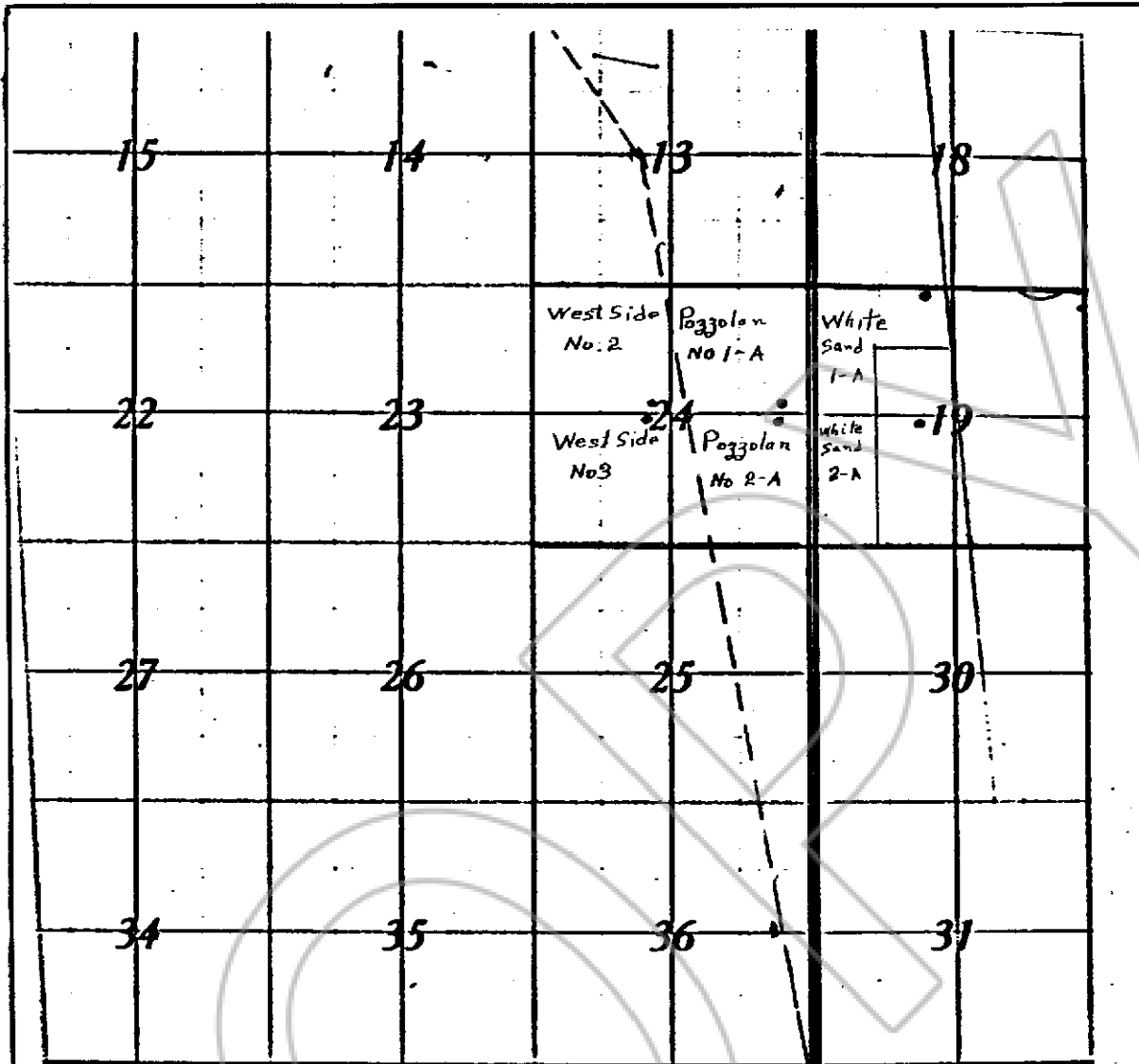

Describe here the position of the Claim Location Monument, if one is used.
 Dots on map show location of monuments
 White Sand 1-A & 2-A and Pozzolan No. 1-A & 2-A
 Map of the and West Side No's 2 & 3 Mining Claim Group

in Section 19 & 21 Township, 13 Range 67 & 68 E
 in the _____ Mining District,
Lincoln County, Nevada.

Located on the 22 day of March 1999, by

Lory M Free
 Locator's name and address (print or type)
1709 N 580 E Provo, Utah 84604

No. 112484

Recorded at the request of

LORY FREE

MARCH 22, 1999

at 37 min past 1 P.M

in Book 140 Official Records
 PAGE 488
 of INCOLN Co., Nevada,

at Page.
Suzie Bruecher
 County Recorder