

**CURVE DATA**

CURVE	DELTA	LENGTH	CORD	RADIUS
A	90°15'39"	55.14'	49.61'	35.00'
B	54°53'32"	33.53'	32.26'	35.00'
C	89°43'32"	54.81'	49.38'	35.00'
D	55°24'34"	33.85'	32.54'	35.00'

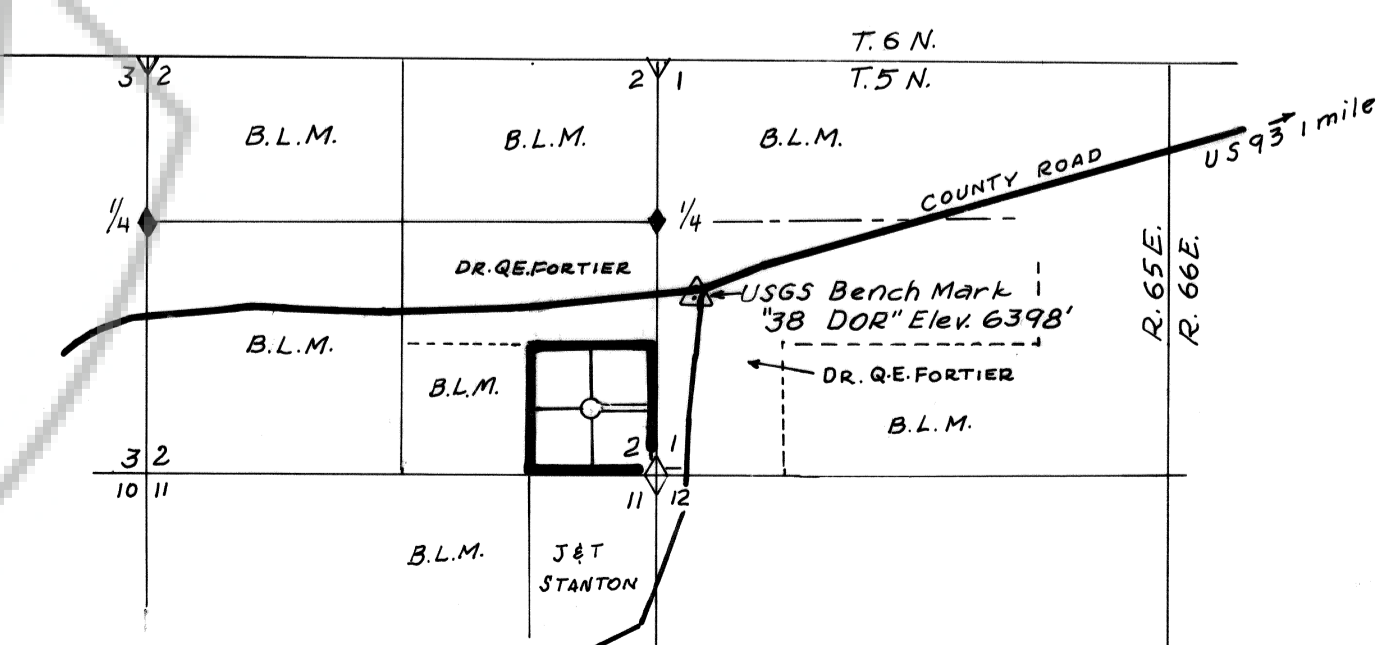

**VICINITY MAP**  
NOT TO SCALE

**SURVEYOR'S CERTIFICATE** 156

I, Lenard D. Smith, a Professional Land Surveyor licensed in the State of Nevada, certify that:

- This plat represents the results of a survey conducted under my direct supervision of the instance of Richard Moser.
- The lands surveyed lie within the SE 1/4 SE 1/4 Section 2, R. 65E, T. 5N, M.D.M. The survey was completed on August 18, 1998.
- This plat complies with the applicable state statutes and any local ordinances in effect on the date that the governing body gave its final approval.
- The monuments depicted on the plat are of the character shown and occupy the positions indicated and are of sufficient number and durability.

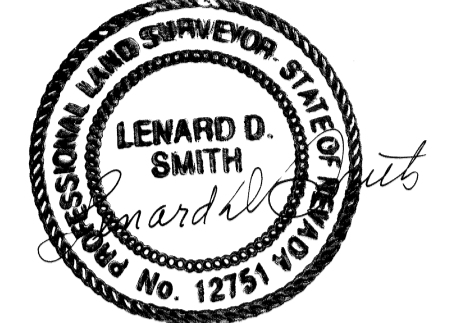

Lenard D. Smith, P.L.S. 12751

**OWNER'S CERTIFICATE**

We, Richard J. Moser and Allison Newlon certify that we are the owners of the land depicted on this plat and that we have requested Lenard D. Smith, a Professional Land Surveyor to prepare this plat for recordation.

*Richard J. Moser*      *Allison Newlon*

**ACKNOWLEDGMENT**

State of Nevada } ss  
County of Lincoln }

This is to certify that the above named person did appear before me and executed the owners certificate voluntarily for the purposes stated therein.

*Notary Public*

**PLANNING COMMISSION**

This is to certify that the Lincoln County Planning Commission examined this plat this 14 day of September, 1998 and did recommend it for approval.

*Chairman*

**COUNTY COMMISSION**

This is to certify that the Lincoln County Commission examined this plat on this 14 day of September, 1998 and did approve it for recordation.

*Lincoln County Clerk*

**MAP REFERENCES**

Map of Division into Large Parcels for Bud Walkington by Owens Surveying Outfit, Plat Book B, Page 01 of Lincoln County Records.  
General Land Office survey notes, By JC Clark, 1919, approved 1922.

**BASIS OF BEARINGS**

The east line of section 2, the north half as recorded on Map of Division into Large Parcels by the Owens Surveying Outfit, Plat Book B, Page 01, as N. 0°34'41"W.

**LEGEND**

- ⊙ Set 5/8" rebar with plastic cap stamped L. Smith P.L.S. 12751
- ⊗ Etched X mark on solid rock in place and raised mound of stone
- ⊠ Found 1/2" rebar with cap stamped F. Hulse P.L.S. 6498

**PRIVATE DRIVE MAINTENANCE**

ALL OWNERS WILL SHARE EQUALLY IN THE MAINTENANCE OF THE PRIVATE DRIVE. Upgrading from original standards will be by mutual consent.

**MAP SCALE** 1 inch = 100 feet

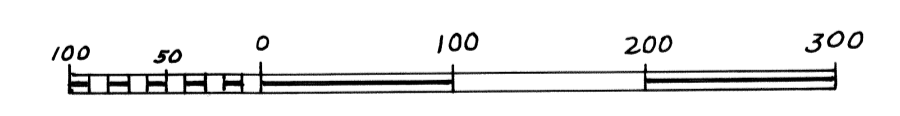

**RECORDER'S CERTIFICATE**  
File No. 111773  
Recorded at the request of  
RICHARD MOSER  
Date OCT. 21 1998 at 2:45 P.M.  
Plat Book B, Page 156  
Lincoln County Records  
YURIKO SETZER, Recorder  
By *Yuriko Setzer*

**PARCEL MAP**  
IN THE SE 1/4 SE 1/4 SECTION 2, T. 5N, R. 65E, M.D.M.  
LINCOLN COUNTY, NEVADA  
FOR RICHARD J. MOSER AND  
ALLISON NEWLON