

Lincoln County

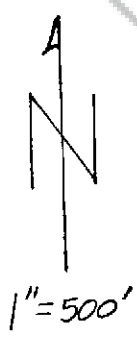
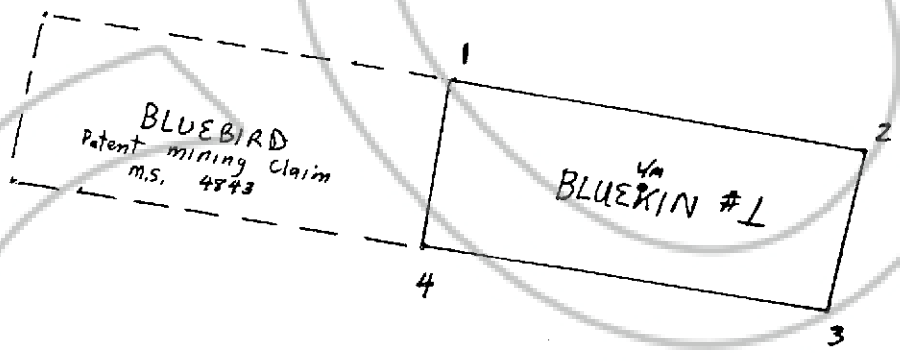

located on 22 Dec 1997
 by
 Frank Bergvall Box 473 Ruth NV 89317
 agent for
 Kinross Gold U.S.A. 185 South State Street
 suite 820
 Salt Lake City UT 84111

Location Map for the
 BLUEKIN #1
 Lode Mining Claim
 Section 22 of
 Township 7 North
 Range 68 East
 MDB&M
 Lincoln County, Nevada

NO. 110252
 LED AND RECORDED AT REQUEST OF
 Kinross Gold USA
 December 22, 1997
 AT 59 MINUTES PAST 4 O'CLOCK
 PM 132 OF OFFICIAL
 RECORD PAGE 68 LINCOLN
 COUNTY, NEVADA
 Yuriko Setzer
 COUNTY RECORDER
 BY Julie Brucher, deputy
 REC 132 68