

DECLARATION OF HOMESTEAD

(MARK ONE)

- JOINT DECLARATION OF HUSBAND AND WIFE
- BY UNMARRIED HEAD OF FAMILY
- BY A SINGLE PERSON NOT THE HEAD OF A FAMILY

Patrick Joseph Gloeckner and Kena Lytle Gloeckner

do individually or severally certify and declare as follows:
A. (MARK ONE)

- (1) I am single, not the head of a family.
- (2) Patrick Joseph Gloeckner is the head of a family, consisting of himself/herself and Kena Lytle Gloeckner and is now residing with that family on the land and premises (or in the mobile home) located in the City of Ursine County of Lincoln, State of Nevada and more particularly described as follows:

A parcel of land situated in the Southeast quarter of the Southwest quarter (SE1/4) of Section 2, Township 1 North, Range 69 East, MDR41, and being more particularly described as follows: Beginning at a point which is the Southeast corner of this parcel from which the South Quarter (S) corner of said Section 2 bears South a distance of 45.77 feet more or less, thence S. 29°16'38" W. across the existing county road a distance of 307.25 ft., more or less to a point on the western edge of said roadway 30.00 feet normal to the centerline, thence West a distance of 501.1 ft., more or less to the Southwest (SW) corner; thence N. 21°55'13" E. along an existing fence a distance of 431.75 ft., more or less to the Northeast corner; thence South a distance of 40.92 ft. more or less to the point of beginning. (cont. on back)

B. I/We claim the land and premises hereinabove described, together with the dwelling house thereon, and its appurtenances, (or the described mobile home) as a Homestead.

- C. (MARK ONE)
- (1) No former declaration of homestead has been made by me, or us, or either of us.
- (2) This declaration constitutes an abandonment of the former declaration recorded _____

IN WITNESS WHEREOF, I/we have hereunto set my hand/our hands this 20th day of May, 1997.

Patrick Joseph Gloeckner Kena Lytle Gloeckner
(Signature) (Signature)
Patrick Joseph Gloeckner Kena Lytle Gloeckner
(PRINT OR TYPE NAME HERE) (PRINT OR TYPE NAME HERE)

STATE OF NEVADA }
County of Lincoln } ss.
ON May 21, 1997, before me, the undersigned, a Notary Public in and for said State, personally appeared Patrick Joseph Gloeckner + Kena Lytle Gloeckner known to me to be the person(s) whose name(s) (s) subscribed to the within instrument and acknowledged that (s) executed the same.

WITNESS my hand and official seal: Judy A. Etcham
Notary Public
STATE OF NEVADA
LINCOLN COUNTY
Exp. JAN 21, 1998

Judy A. Etcham
Notary Public in and for said State.
1-21-97
BY COMMISSION EXPIRES

TYPE OR PRINT RECORDING REQUESTED BY

THIS SPACE FOR RECORDER'S USE ONLY

No. 109008
filed and recorded at request of
PATRICK GLOECKNER
MAY 21, 1997
At 43 minutes past 4 o'clock
Lincoln County Nevada Recorder.
YURINO SETZER
COUNTY RECORDER
BY Lilli Boucher DEPUTY

AND WHEN RECORDED MAIL TO

Name [Patrick Joseph Gloeckner]
Street [HC 74 Box 237]
Address [Pioche, NV. 89043]
City & State []

BOOK 128 PAGE 173

Lincoln County

(Description continued)

Said parcel of land contains 8.93 acres, less and except that portion of the existing county road 60.00 feet in width traversing property along the Easterly side.

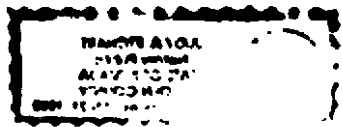
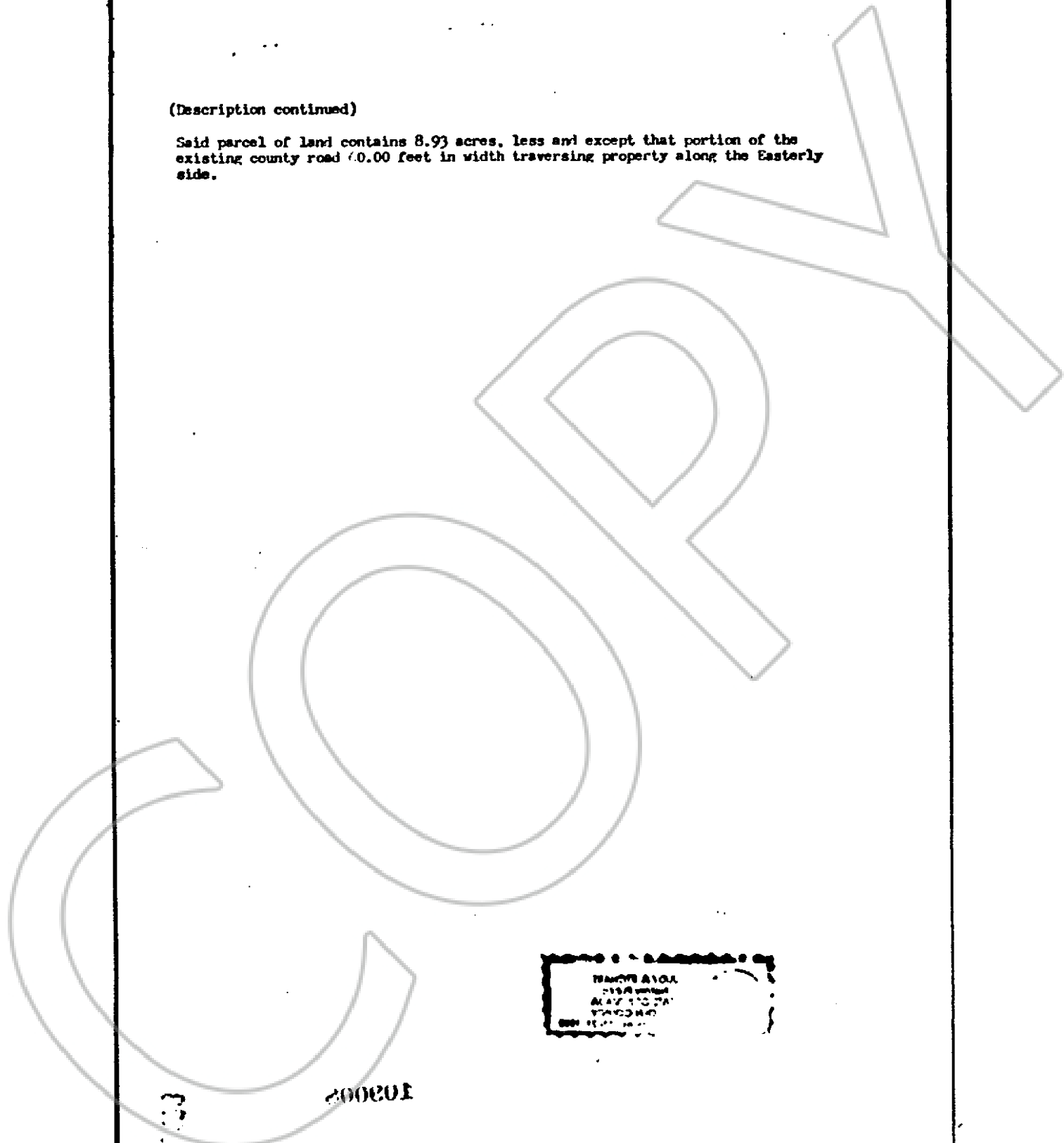

100001

100001