

SURVEYOR'S CERTIFICATE

I, James J. Owens, a Professional Land Surveyor registered in the State of Nevada, certify that:

- This plat represents the results of a survey conducted under my direct supervision at the instance of Stanley Lamar Wallis & Charlotte Maureen Wallis, owners.
- The lands surveyed lie within Sec. 8, T. 4 S., R. 67 E., M.D.M., City of Callente, Lincoln County, Nevada, and the survey was completed on the 19th of Mar., 1996.
- This plat complies with the applicable state statutes and any local ordinances in effect on the date that the Governing Body gave its final approval.
- The monuments depicted on the plat are of the character shown, occupy the positions indicated and are of sufficient number and durability.

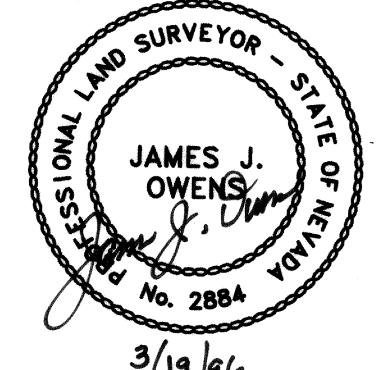

James J. Owens
 Professional Land Surveyor
 Nevada Certificate No. 2884

REFERENCE DOCUMENTS

- Deed of Trust Book 88 Page 199, Official Records, Lincoln County, Nevada.
- Alice C. Dixon's Addition to Callente Townsite Plat filed in the Office of the County Recorder on the 5th day of Sept. 1923, refilled on May 25, 1926.

BASIS OF BEARING

The Basis of Bearing is taken from a Solar Observation.

STATEMENT

Any subsequent changes to this map should be examined and may be determined by reference to the County Recorder's Cumulative Map Index, NRS 278.5695.

LEGEND

- Set 5/8" rebar w/ plastic cap marked "OWENS PLS 2884".
 - ⊙ Found Brass Cap in Cone, marked Fonger Surveying; Ely, Nevada; R.L.S. 4235.
 - ⊙ Found 2-1/2" Alum. Cap marked Fonger Surveying; Ely, Nevada; R.L.S. 4235.
 - ⊙ Found 2-1/2" Alum. Cap marked Fonger Surveying; Ely, Nevada; R.L.S. 4235.
- Section Line

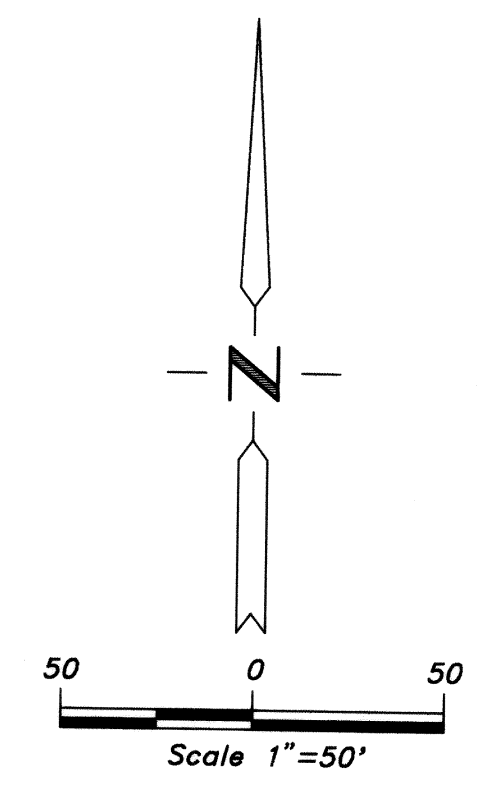

RECORD OF SURVEY	
For Stanley Lamar Wallis & Charlotte Maureen Wallis	
Sited in Sec. 8, T. 4 S., R. 67 E., M.D.M., City of Callente, Lincoln County, Nevada	
No. 105216	Filed at the request of THE OWENS SURVEYING OUTFIT.
Date 05-16-96 at 9:40 A.M.	File _____ Page 483
Fee 17.00	Of Survey Maps Official Records Book No. Plat A Lincoln County, Nevada Records Yuriko Setzer, Recorder Deputy Boucher

Nev-422
 S. Hofen

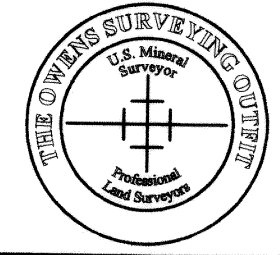

THE OWENS SURVEYING OUTFIT
 Project: Mineral Land Surveying throughout the West
 P.O. Box 1330
 Mesquite, Nevada 89024
 (702) 346-2930